

	AS NOTED	01/01
--	----------	-------

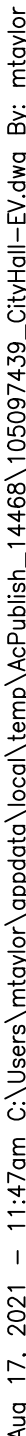

AUD	INCIDENT	MAOP
	Gas Order	Elect Order 105097439
	SCALE AS NOTED	PAGE 01/02

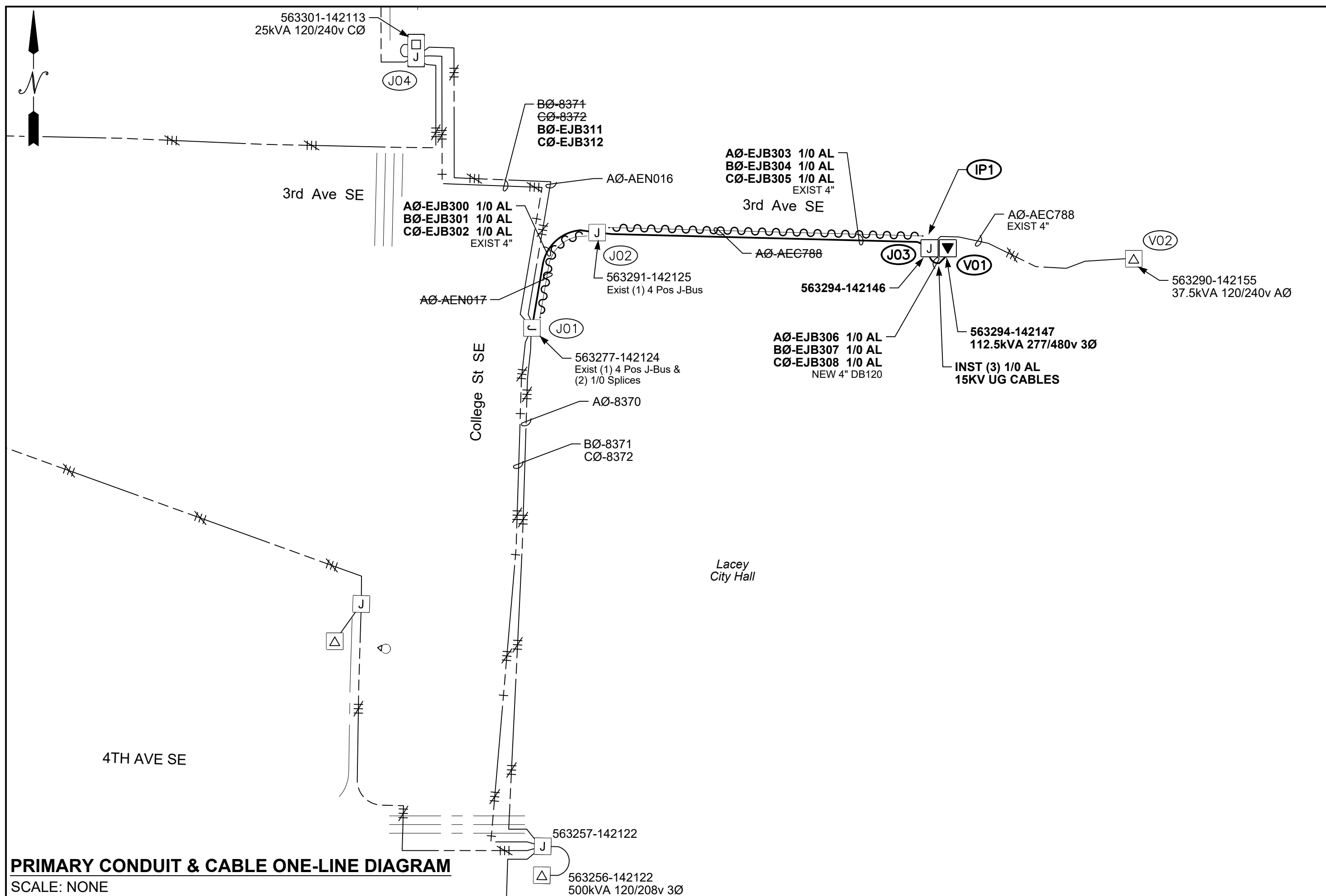

PRIMARY CABLE & CONDUIT TABLE

[illegible]

				90°	45°	22°	11°	BellEnds
Total:	2"							
Total:	4"		10	2	4			3
Total:	6"							

Total:	1/0	1,020
--------	-----	-------

VAULT & EQUIPMENT TABLE

SITE	GRID NUMBER	VAULT SIZE & COVER	TYPE & SIZE EQUIPMENT IN VAULT	PRIMARY BUSHINGS		TRANSFORMER ID NUMBERS (Company ID)	ASBUILT INFORMATION Foreman-Complete
				LB	DC		
J01	563277 142124	Existing 4"x6" Vault & Cover Existing (1) J-Bus & (2) 1/0 Splices	(2) 200A J-Bus MID 7625900	4	2		
J02	563291 142125	Existing 4"x6" Vault & Cover Existing (1) J-Bus	(2) 200A J-Bus MID 7625900	6	6		
J03	563294 142146	4"8"x7"x5" Vault MID 7663200 Cvr MID 9996162	(3) 200A J-BOX MID 7625900	7	5		
V01	563294 142147	4"8"x 4"8"x 3"6" HH MID 7663900 4"8"x5"6"x6" COVER MID 7655200	112.5kVA 277/480v MID 6259050	3			
				3			

	LoadBreak Elbows	Dust Covers
Totals :	20	13

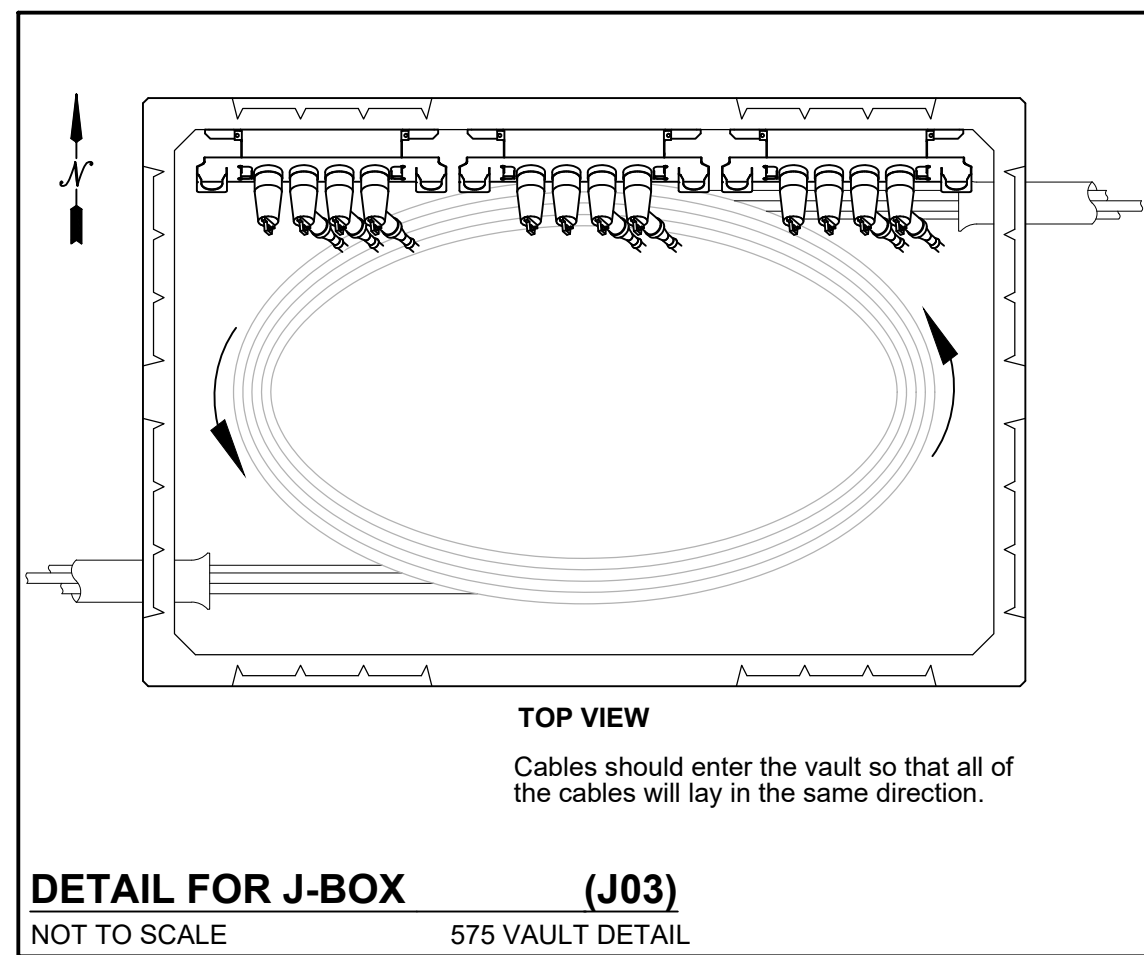
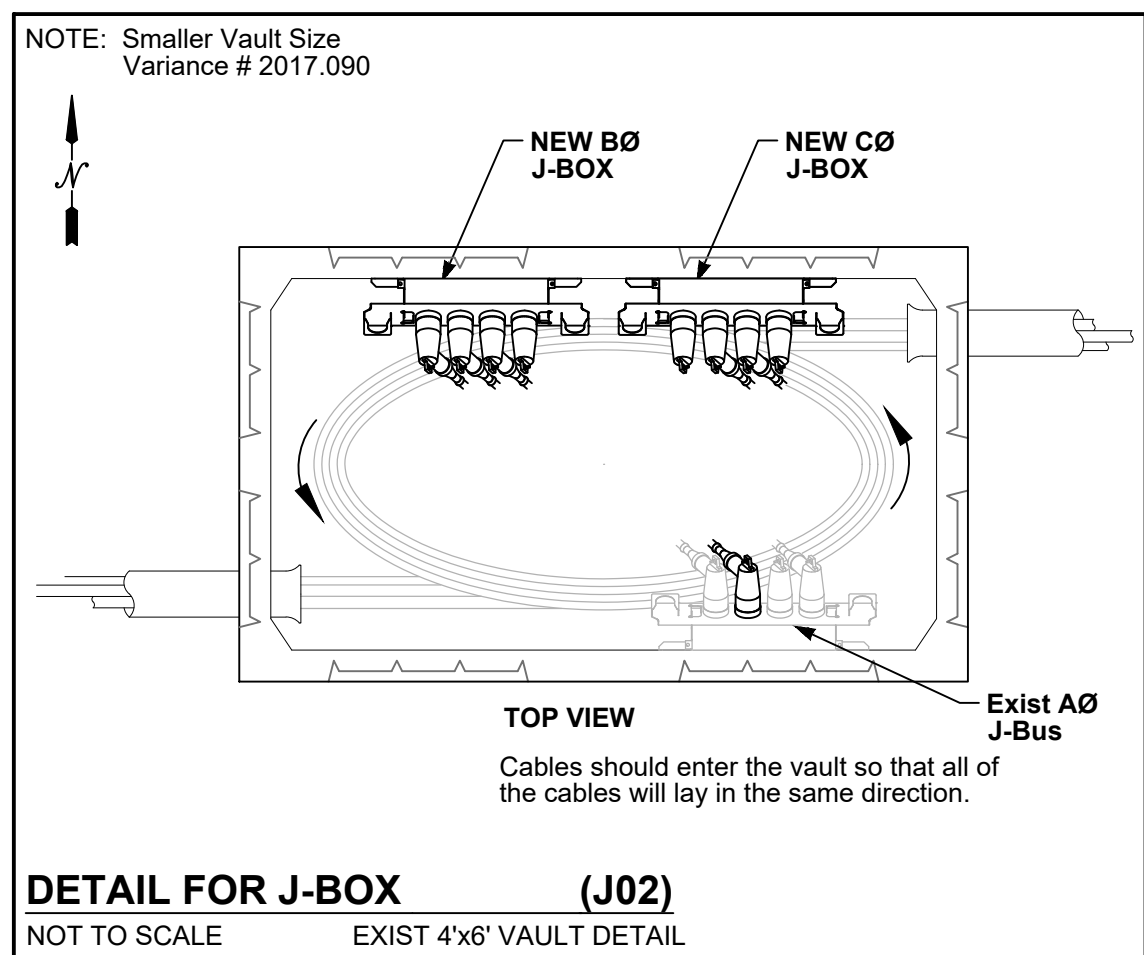
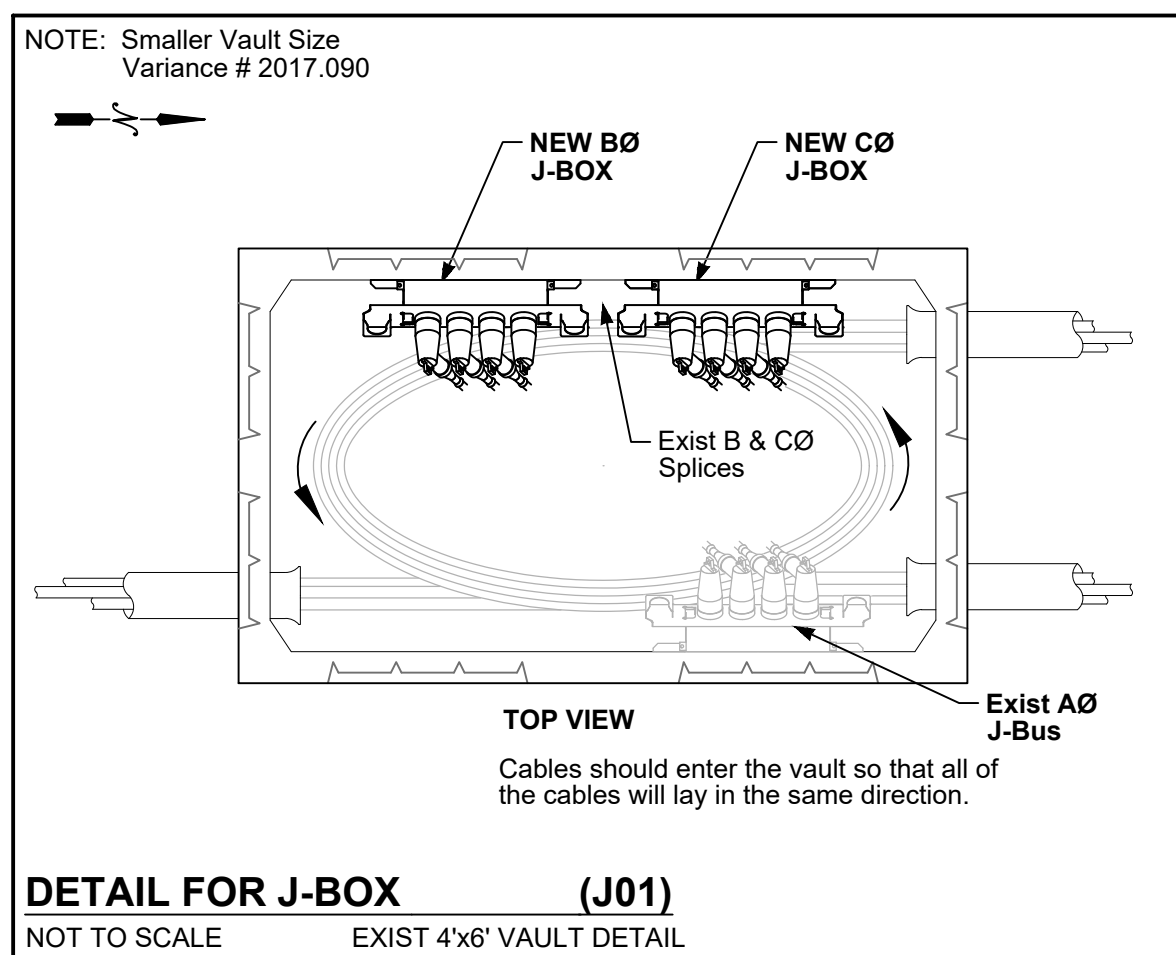

TRANSFORMER INSTALLATION (PM)

Installed at site: V01
Grid Number: 563294-142147
kVA Rating: 112.5kVA 277/480v
Material ID#: 6259050

Foreman to redline the following information

Company ID#: _____

Primary phase connected to: _____

Tested Secondary Voltage _____ / _____

CABLE REMOVAL TABLE

Work Location		Wire Size & Type	Quantity	Length (per conductor)	Remarks
From	To				
J01	J02	(1) 1/0 UG	1	80	
J02	J03	(1) 1/0 UG	1	300	

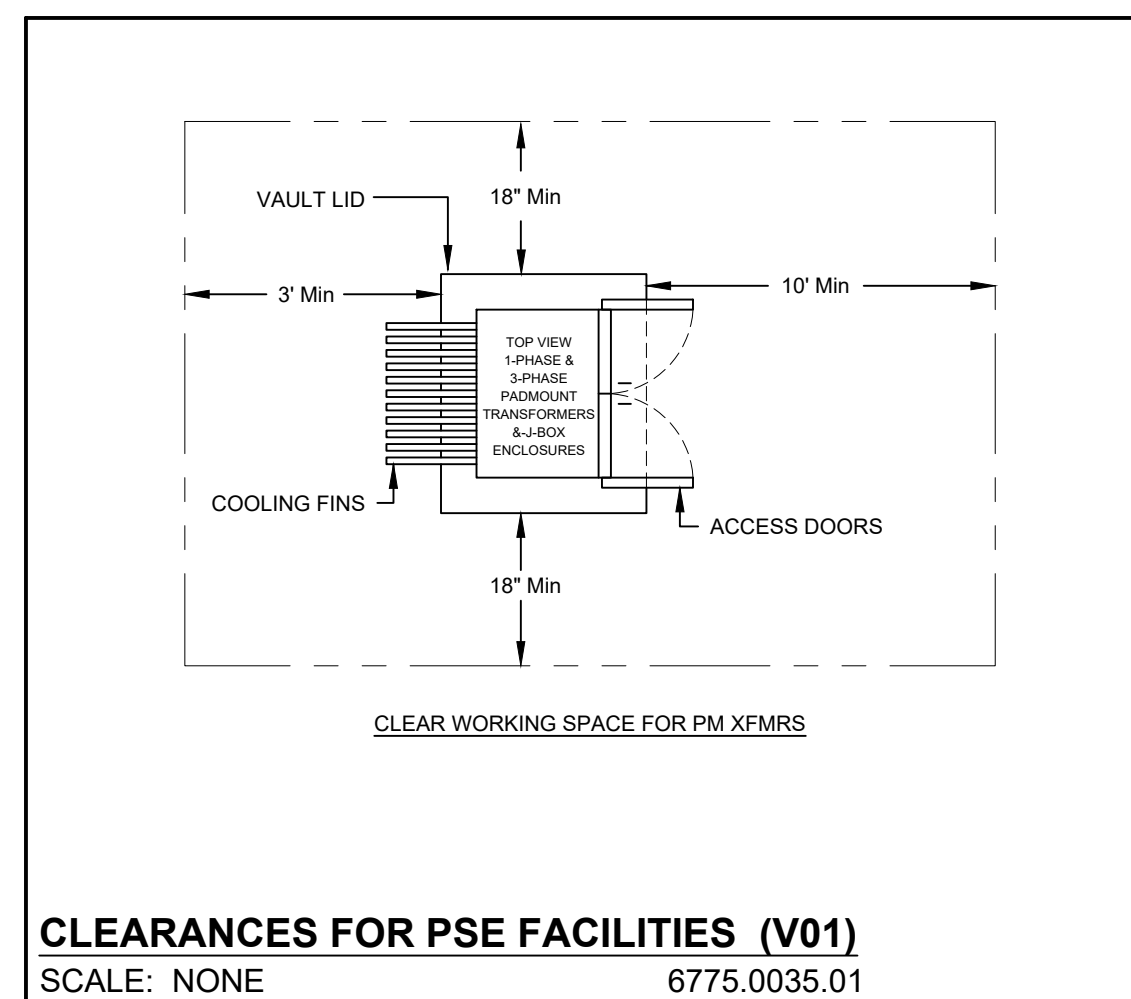
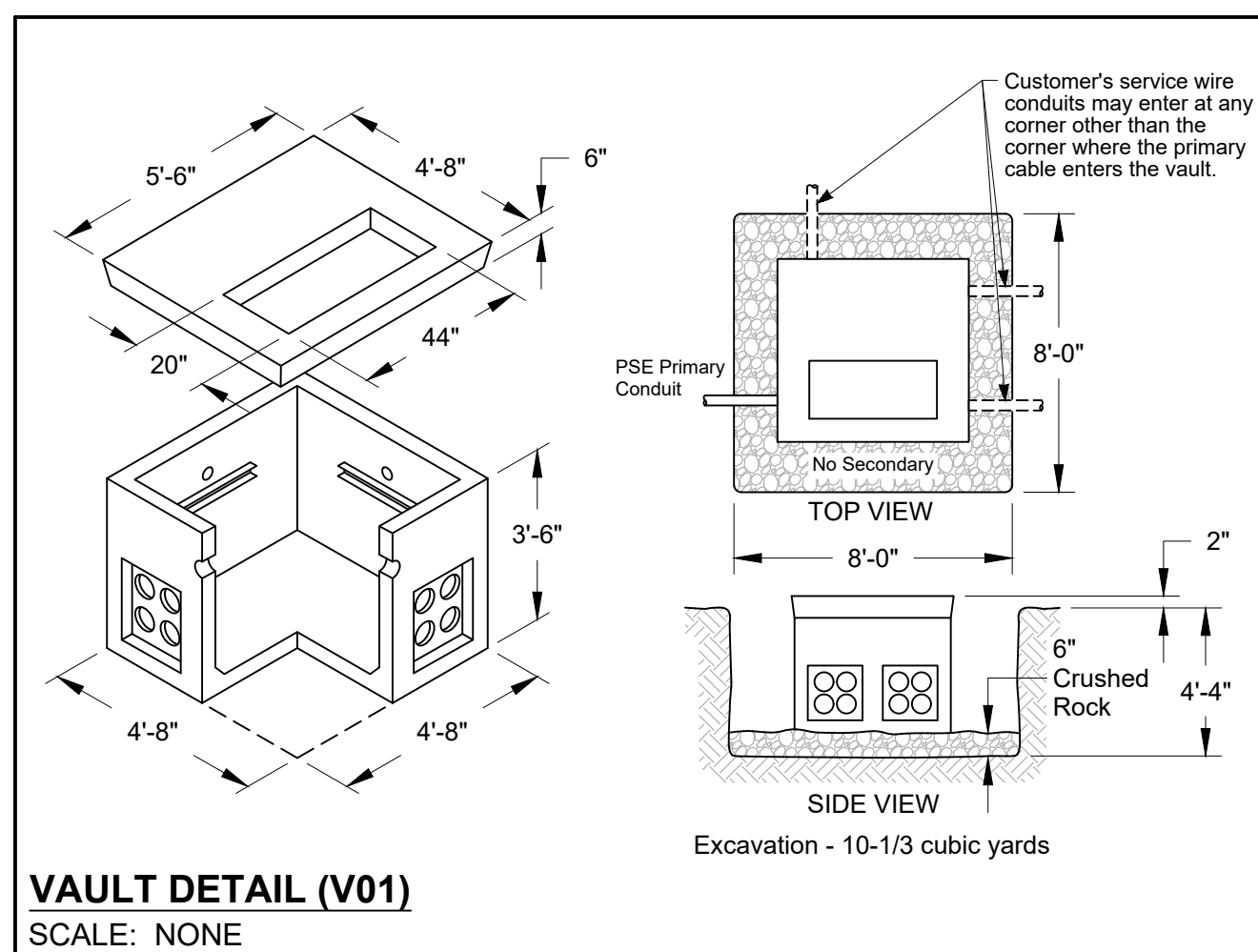
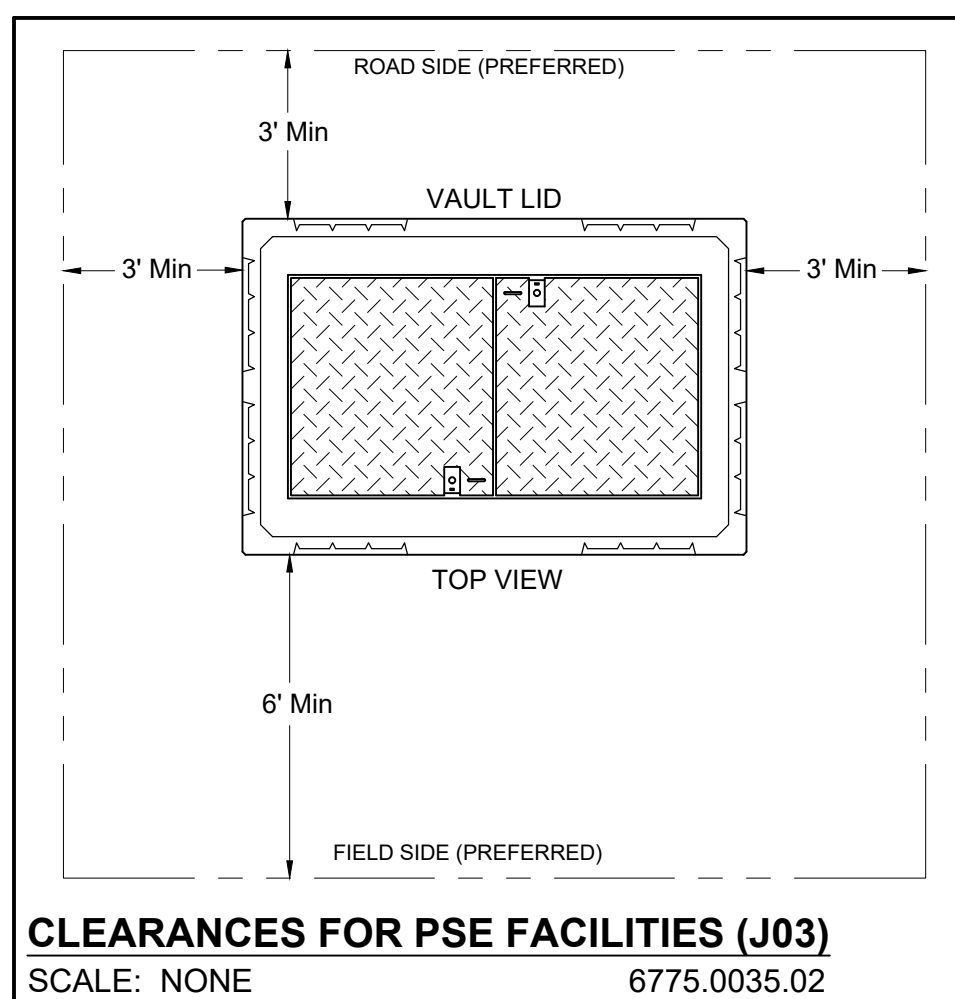
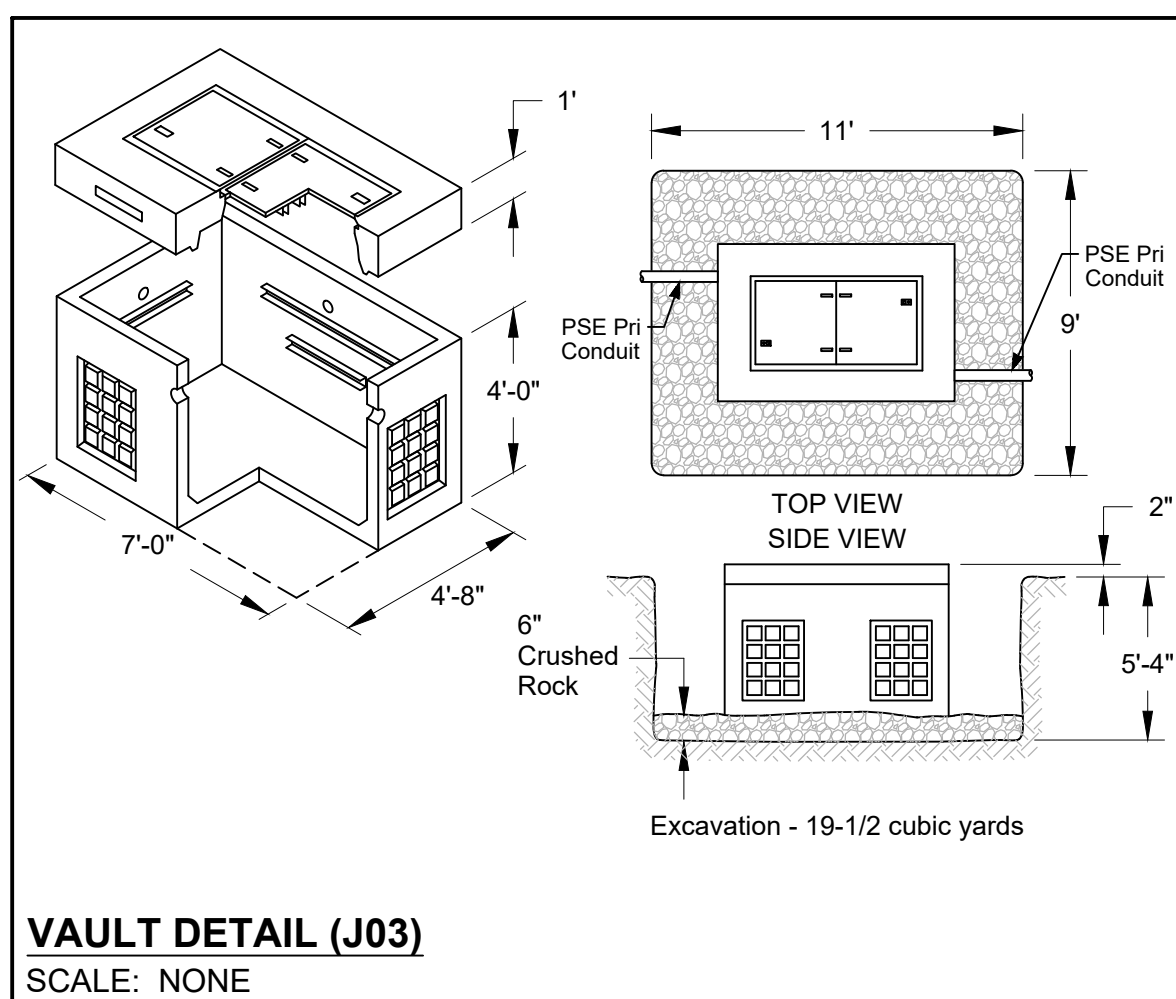

Project Manager Contact Information:

Manager: Shannon Tincknell
Cell Phone: 253-303-1638
E-Mail: Shannon.Tincknell@pse.com

For contacts below dial 1-888-CALL PSE (225-5773)

CALL (800) 424-5555

2 BUSINESS DAYS BEFORE YOU DIG

PSE Locates Req'd		Yes	THIS SKETCH NOT TO BE RELIED UPON FOR EXACT LOCATION OF EXISTING FACILITIES			
Outages Req'd		Yes	REAL ESTATE/EASEMENT		PERMIT	
Flagging Req'd		Yes	N/A		N/A	
3			FUNCTION		CONTACT	PHONE NO DATE
2			PROJECT MGR		S.Tinknell	253-303-1638 07/09/21
1			ENGR - POWER		M.Taylor	85-5970 07/09/21
REV#	DATE	BY	DESCRIPTION			
COUNTY	Emer Sect	Gas Wk Ctr	POWER WK CTR		DRAWN BY	M.Taylor 85-5970 07/09/21
Thurston			QSTHLE		CHECKED BY	
1/4 SEC	OP MAP		PLAT MAP		APPROVED BY	R.walsh 253.245.0798 8.18.21
SW¼, Sect16, T18, R01W					FOREMAN #1	
U-MAP NO (POWER)	OH CKT MAP	UG CKT MAP	CIRCUIT NO		FOREMAN #2	
1801W063	1801W056	1801W063	PLG-16		MAPPING	

JOINT FACILITIES ARRANGEMENTS				
UTILITIES				
CONTACT				
PHONE#				



Lacey City Hall EV
Cmrcl - 3Ø UG Line Extension
420 College St SE Lacey, WA 98503

AUD	INCIDENT	MAOP
	Gas Order	Elect Order 105097439
	SCALE AS NOTED	PAGE 02/02

Aug 09, 2021 11:06am J:\Electric_Southwest\THURSTON\Shannon_Tincknell\Non-Residential aka Commercial\105097520_SchDistrictEVChrgSta.CAD\105097520_SchDistrictEVChrgSta.dwg By: pscourt

MAPS & RECORDS

NOTE: CORRECTED FACILITIES SHOWN

CIRCUIT FEET REM'VD: 250'
CIRCUIT FEET ADDED: 311'
Sq. Footage: N/A
Panel Size: 200AMP
Heat Type: ELECTRIC
Est. Demand: 5.76kW
LRC: 65
% V. Drop: 0.5%
% Flicker: 1.5%

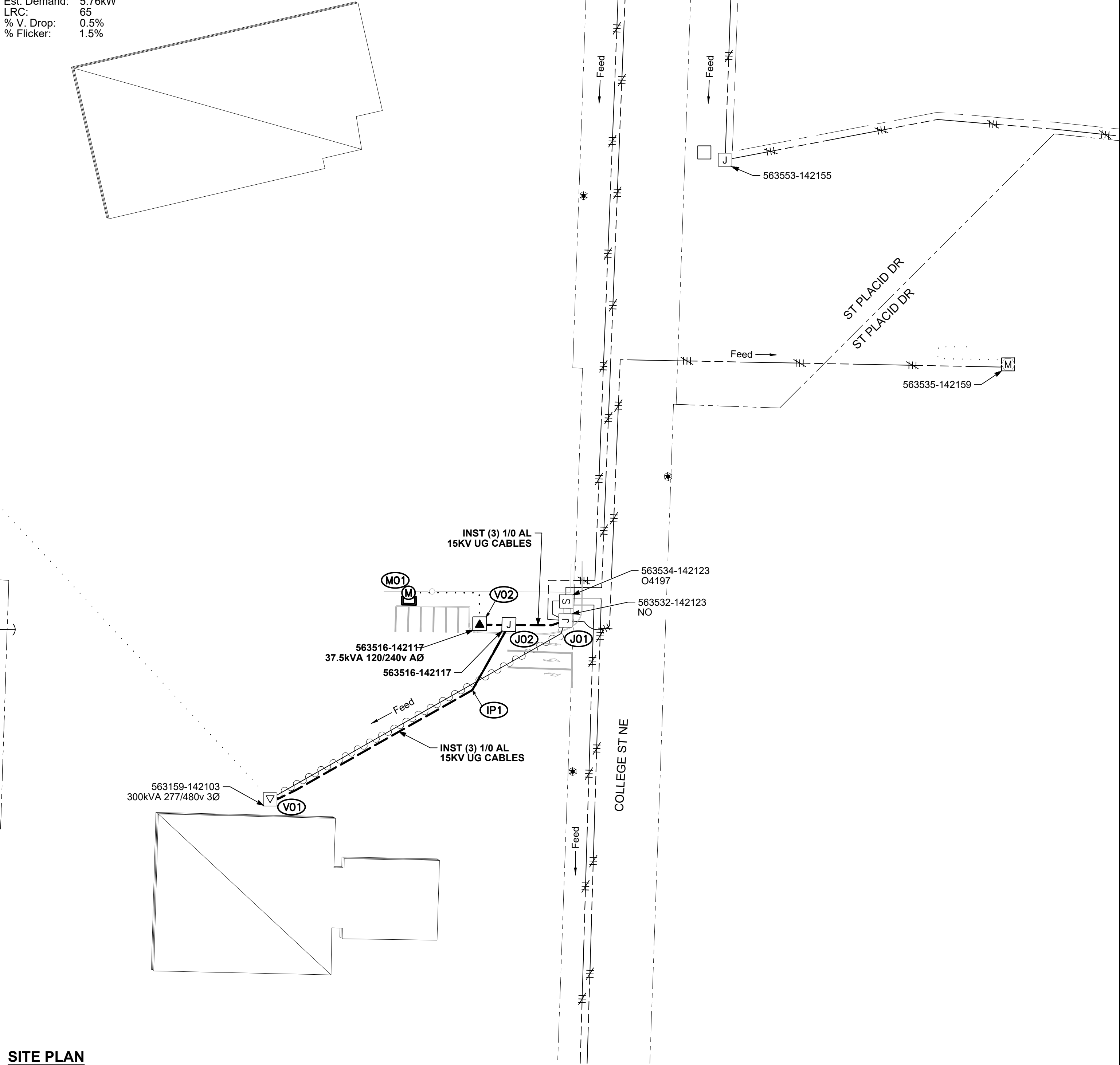

SITE PLAN
SCALE: 1" = 50'

SITE SPECIFIC NOTES

AT IP1

INTERCEPT EXIST 4" CONDUIT & REROUTE INTO J02

AT V01

CUT & REMV EXIST ELBOWS & PULL OUT EXIST CBLS (A0-15391, B0-15392 & C0-15393)
INST (3) L/B ELBOWS 2-57(3)

AT J01

INST (3) L/B ELBOWS

AT J02

INST 4'-8" x 7' VAULT & COVER (MID #: 7663200) 3-21 6055.1030
INST (3) 4POS J-BOX
INST (7) L/B ELBOWS & (5) INSULATED CAPS
SEE CABLE DIAGRAM (Page 02) FOR CABLE #'S
INST GRID# 563515-142120

AT V02

INST UNISTRUT MP HH & GNDS 3-19a
SET 37.5 kVA, 120/240V PM XFMR
INST (3) L/B ELBOWS & (1) INSULATED CAP
SEE CABLE DIAGRAM (Page 02) FOR CABLE #
INST GRID# 563516-142117

AT M01

PERM METER

J01 to V01:

REMV 3Ø CABLE ±250' 2-55 (250)

J02 to IP1:

INST PSE PROVIDED 4" DB120 SCH40 CONDUITS ±54' 2-36(54)

J02 to V01:

INST (3) 1/0 PRI CABLES 235' IN CUST PROVIDED TRENCH & PSE PROVIDED 4" DB120 SCH40 CONDUITS, SEE CABLE DIAGRAM (Page 02) FOR CABLE #'S (TOTAL BILLABLE LGTH = ±215') 2-55(215)

J01 to J02:

INST (3) 1/0 PRI CABLES 57' IN CUST PROVIDED TRENCH & PSE PROVIDED 4" DB120 SCH40 CONDUITS, SEE CABLE DIAGRAM (Page 02) FOR CABLE #'S (TOTAL BILLABLE LGTH = ±37')

J02 to V02:

INST (1) 1/0 PRI CABLE ±40' IN CUST PROVIDED TRENCH & PSE PROVIDED 2" DB120 SCH40 CONDUIT, SEE CABLE DIAGRAM (Page 02) FOR CABLE # (TOTAL BILLABLE LGTH = ±20')

CUSTOMER NOTE:

CUSTOMER RESPONSIBLE FOR INSTALLING CONDUIT & 3/8" NYLON PULL ROPE. SITE MUST BE READY 1-WEEK PRIOR TO CONSTRUCTION DATE

WIRE REMOVAL TABLE

Work Location		Wire Size & Type	Quantity	Length (per conductor)	Remarks
From	To				
J01	V01	(3) 1/0 UG	3	250'	A0-15391,B0-15392 & C0-15393

TRANSFORMER INSTALLATION (PM)

Installed at site: V02

Grid Number: 563516-142117

kVA Rating: 37.5kVA 120/240v

Material ID#: 6247000

Foreman to redline the following information

Company ID#:

Primary phase connected to:

Tested Secondary Voltage

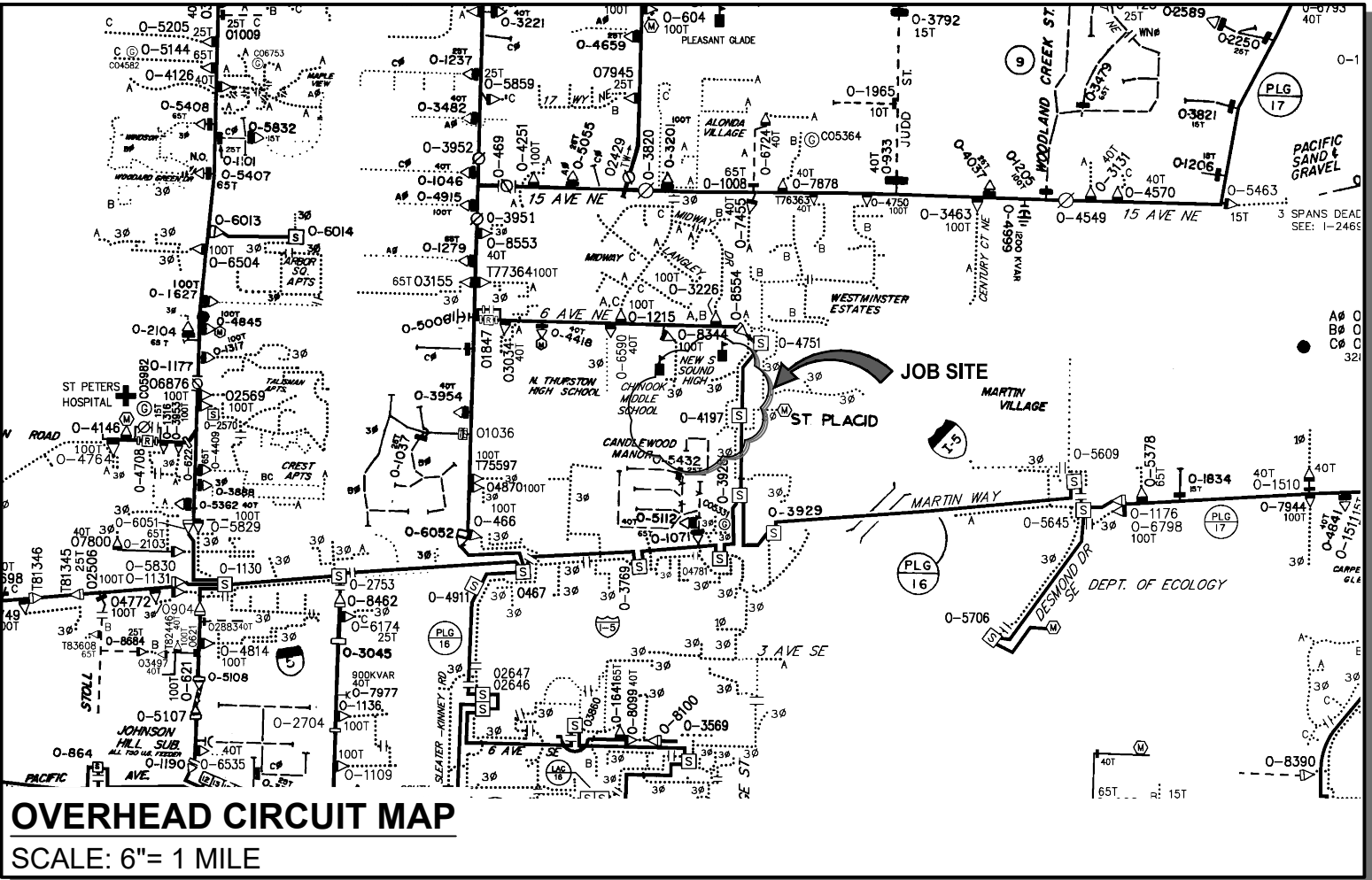

OVERHEAD CIRCUIT MAP

SCALE: 6"= 1 MILE

POWER GENERAL NOTES - COMMERCIAL PROJECT

- All materials to be installed in accordance with Puget Sound Energy's (PSE) standards. Any deviation from this work sketch must be AUTHORIZED by PSE's Project Manager and NOTED on the Foremans' Copy.
- All switching arrangements and/or outage arrangements are to be made with the Project Manager at least three (3) working days in advance.
- Contact the Utilities Underground Location Center (1-800-424-5555) at least 48 hours prior to commencing work to get the underground facilities located.
- STAKING: The customer will provide all staking (transformer, handhole, trench, grade, lot, pole, sidewalk, etc.). See sketch and details for locations. Equipment locations must be approved by the Project Manager.
- SITE PREPARATION: The work area will be at or near finished grade, clear of trench spoils or construction materials which would restrict construction and/or equipment access, before work can begin.
- Roads shall be paved or have a compacted, crushed rock base in place.
- CLEARANCES: Transformers require a minimum of 6 feet from fire fighting equipment, 10 feet from combustible walls, overhangs, doors, and windows, and a minimum of 5 feet from the back of curb (or guard posts will be required per PSE standards). All conduits and vaults are to be at least 5 feet away from water, storm and sewer lines when paralleling them in the right of way, and at least 1 foot when crossing them.
- All work is to be done in accordance with local municipal and county permit requirements as applicable.
- Customer/Developer is responsible to provide, install and maintain all secondary service cables, conduits and crossings from the individual unit's meter base to the designated connection point.
- Inclement weather conditions may cause delays in construction times and dates.
- EXCAVATION: The customer is to provide all trenching, backfill, vault excavations, compaction and restoration per this sketch and per PSE standards. A minimum protective cover of 36" is required over PSE's primary voltage equipment and 24" is required of PSE's secondary voltage equipment. The customer will provide any and all shoring or they will side slope the trench to 1:1.

EROSION & SEDIMENT CONTROL REQUIREMENTS

EROSION & SEDIMENT CONTROL SHALL BE PER PSE STANDARD PRACTICE 0150.3200 TECHNIQUES FOR TEMPORARY EROSION & SEDIMENT CONTROL & ANY ADDITIONAL LOCAL JURISDICTION REQUIREMENTS. (LOCAL JURISDICTIONS MAY HAVE ADDITIONAL REQUIREMENTS INCLUDING NOTES DETAILING WHERE EROSION OR SEDIMENT CONTROL STRUCTURES ARE TO BE INSTALLED, CROSS SECTION DETAILS OF THE TYPICAL EROSION STRUCTURES, & SPECIAL REQUIREMENTS FOR WORK IN SENSITIVE AREAS.)

FOREMAN (CHECK BOX WHEN COMPLETED)		
<input type="checkbox"/>	PSE Equipment LOCKED/SECURED & Work Area left in CLEAN/SAFE Condition.	
<input type="checkbox"/>	Grid, Cable, and Switch numbers INSTALLED & VERIFIED.	
<input type="checkbox"/>	Field Changes RED-LINED on As-built.	
<input type="checkbox"/>	Material VERIFIED and CHANGES noted on Paperwork.	
<input type="checkbox"/>	Total PRIMARY Cable noted on As-built.	
<input type="checkbox"/>	Company ID's RECORDED in correct location on As-built.	
<input type="checkbox"/>	Indicate correct FUSE SIZE on As-built & VERIFY proper PHASE.	
<input type="checkbox"/>	Deviations noted on the As-built and their reason.	
<input type="checkbox"/>	I certify that the work performed meets PSE's standards and procedures and that all quality requirements are met.	
Foreman's Signature _____		
Print Name _____ Date _____		

PROJECT PHASE	NOTIF#	ORDER#
PWR	Superior	510831083
Perm. Service		101138820
Relocation		108128796
Removal		594143151
Perm Svc	511216034	104335317
Job Order	N/A	N/A
Distribution	N/A	N/A
HP Main	N/A	N/A
HP Svc/MSA	N/A	N/A
CABLE TV		
PHONE		

Project Manager Contact Information:

Manager: Shannon Tincknell
Cell Phone: 253-303-1638
E-Mail: Shannon.Tincknell@pse.com

Developer Locates Req'd	No
PSE Locates Req'd	No
Outages Req'd	Yes
Flagging Req'd	Yes

REV#	DATE	BY	DESCRIPTION	ENGR - GAS
3				
2				
1				
COUNTY	Thurston	Emer Sect	Gas Wk Ctr	POWER WK CTR
1/4 SEC		OP MAP		QSTHLE
U-MAP NO (POWER)	1801W068	OH CKT MAP	UG CKT MAP	CIRCUIT NO
				PLG-16

JOINT FACILITIES ARRANGEMENTS			
UTILITIES			
CONTACT			
PHONE#			

PSE DESIGNED BY PSE	PUGET SOUND ENERGY	School District EV Charging Station Cmtrl - 1Ø Line Extension Repl J-Box 305 College St NE Lacey, WA 98516	AUD
-------------------------------	---------------------------	--	------------

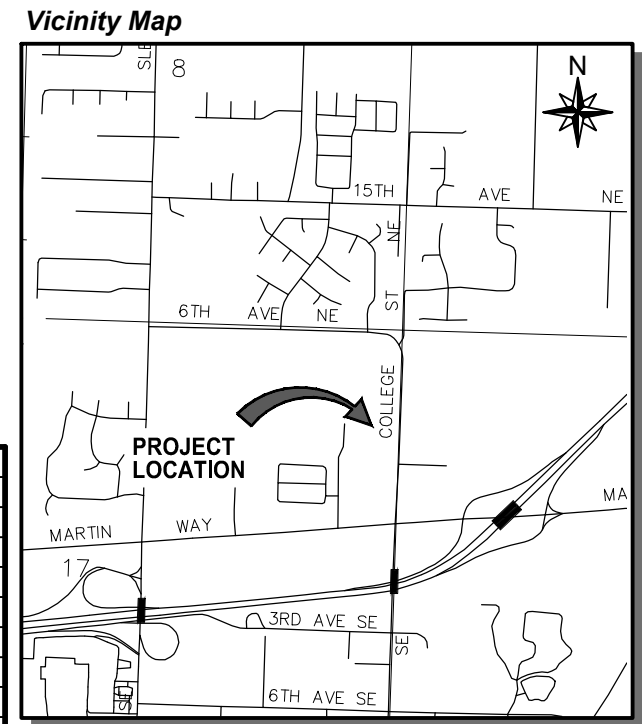

Owner / Developer Contact Info

City of Lacey
420 College St SE
Lacey, WA, 98503
ATTN: Martin Hoppe

For contacts below dial 1-888-CALL PSE (225-5773)

CALL (800) 424-5555
2 BUSINESS DAYS BEFORE YOU DIG

THIS SKETCH NOT TO BE RELIED UPON FOR EXACT LOCATION OF EXISTING FACILITIES

REAL ESTATE/EASEMENT		PERMIT	
N/A		N/A	
FUNCTION	CONTACT	PHONE NO	DATE
PROJECT MGR	S.Tincknell	253-303-1638	5/14/21
ENGR - POWER	P.Courtney	253-888-2522	6/22/21
ENGR - GAS			
DRAWN BY	P.Courtney	253-888-2522	6/22/21
CHECKED BY	R.walsh	253.245.0798	8.12.21
APPROVED BY			
FOREMAN #1			
FOREMAN #2			
MAPPING			

INCIDENT			
Gas Order	Elect Order	105097520	
SCALE	AS NOTED	PAGE	01/02

Aug 09, 2021 - 11:07am J:\Electric_Southwest\THURSTON\Shannon_Tincknell\Non-Residential aka Commercial\105097520_SchDistrictEVChrgSta.dwg By: pscourt

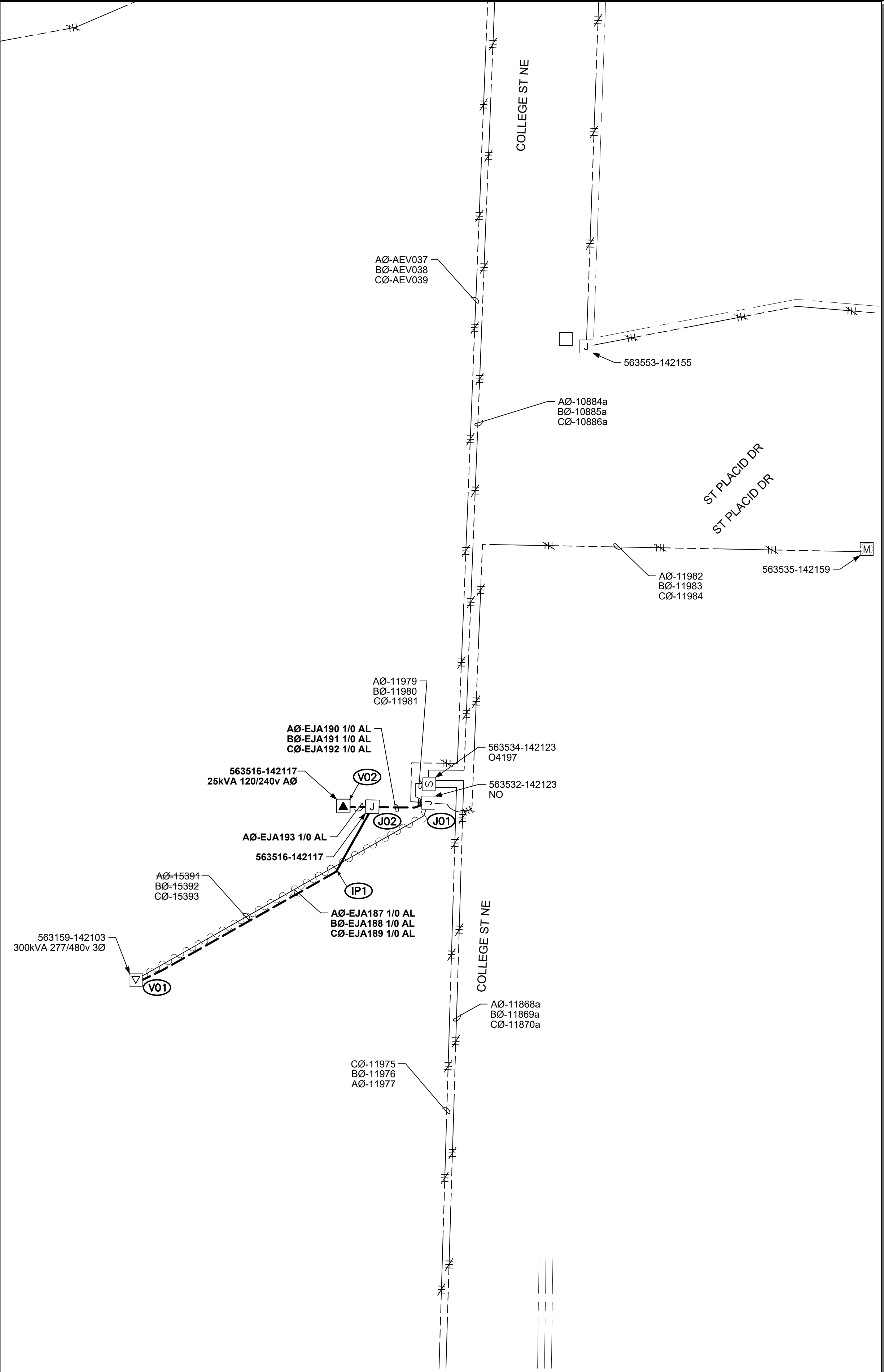

PRIMARY CONDUIT & CABLE ONE-LINE DIAGRAM
SCALE: NONE

Primary Cable & Conduit Table (Foreman to Complete)

LOCATION		CONDUIT											PRIMARY CABLE											QTY OF LUBE (gal.)		AS BUILT INFORMATION		
From	To	Size (in)	Qty	Design Length (ft)	Actual Length (ft)	TYPE			BENDS				PULL (lbs)	PULL Rev (lbs)	Cable Size	Design Length (ft)	Actual Length (ft)	CABLE NUMBERS			MANUFACTURING INFORMATION						FOR FEEDER CABLE ONLY Check applicable box	
						DB120	HDPE	SCH 80	90°	45°	22°	11°						A	B	C	Manufacturer	Compound	Year	Tape	CN	#4/0 NEU	Design	As Built
IP1	J02	4"	1	54'		X			0	0	0	0	37.1	37.1	PRI 12KV 1/0 UG	74'												
J02	V01	4"		Exist		X									PRI 12KV 1/0 UG	215'		EJA187	EJA188	EJA189								
J01	J02	4"	1	37'		X			0	0	0	0	107	107	PRI 12KV 1/0 UG	57		EJA190	EJA191	EJA192								
J02	V02	2"	1	20'		X			1	0	0	0	43	43.7	PRI 12KV 1/0 UG	40'		EJA193										

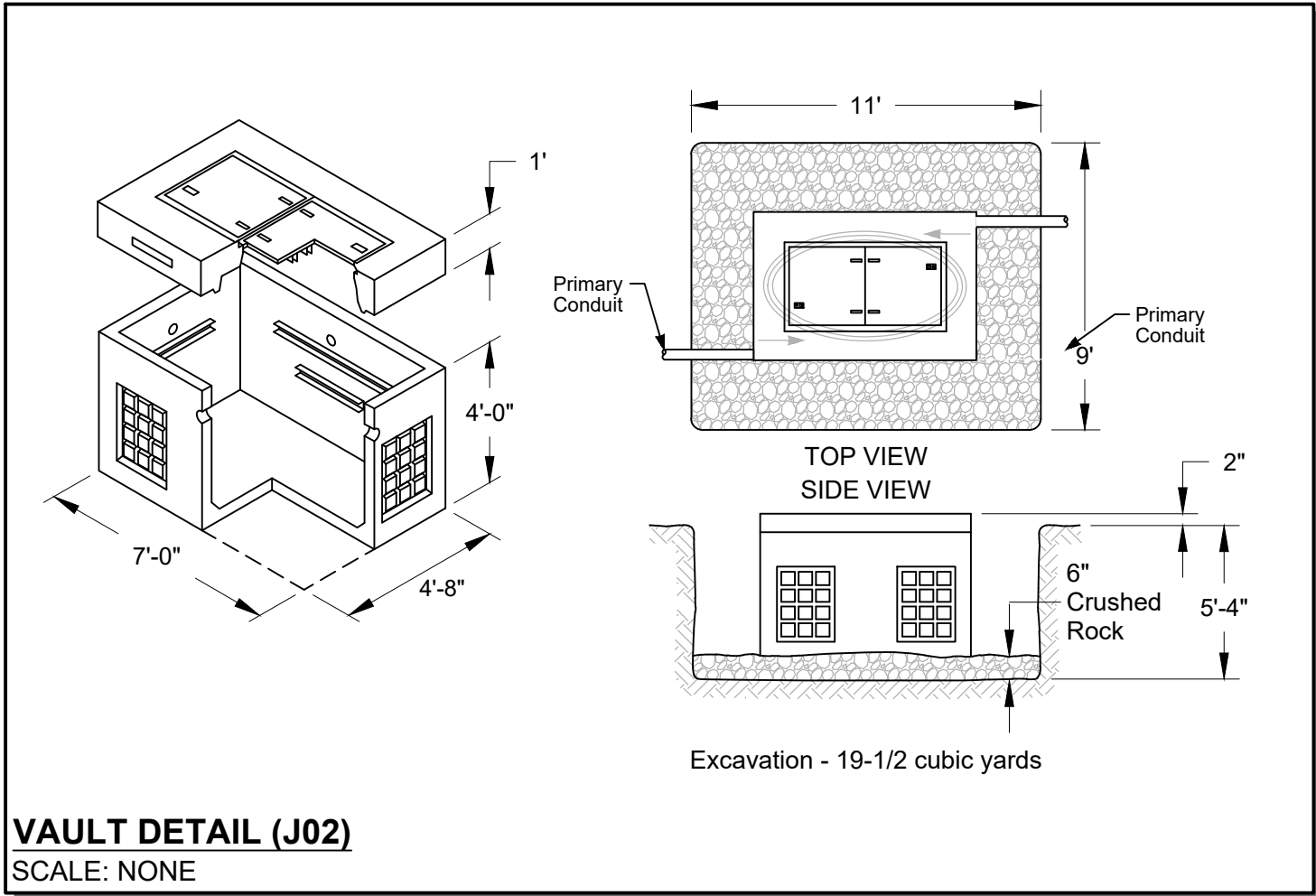

VAULT DETAIL (J02)
SCALE: NONE

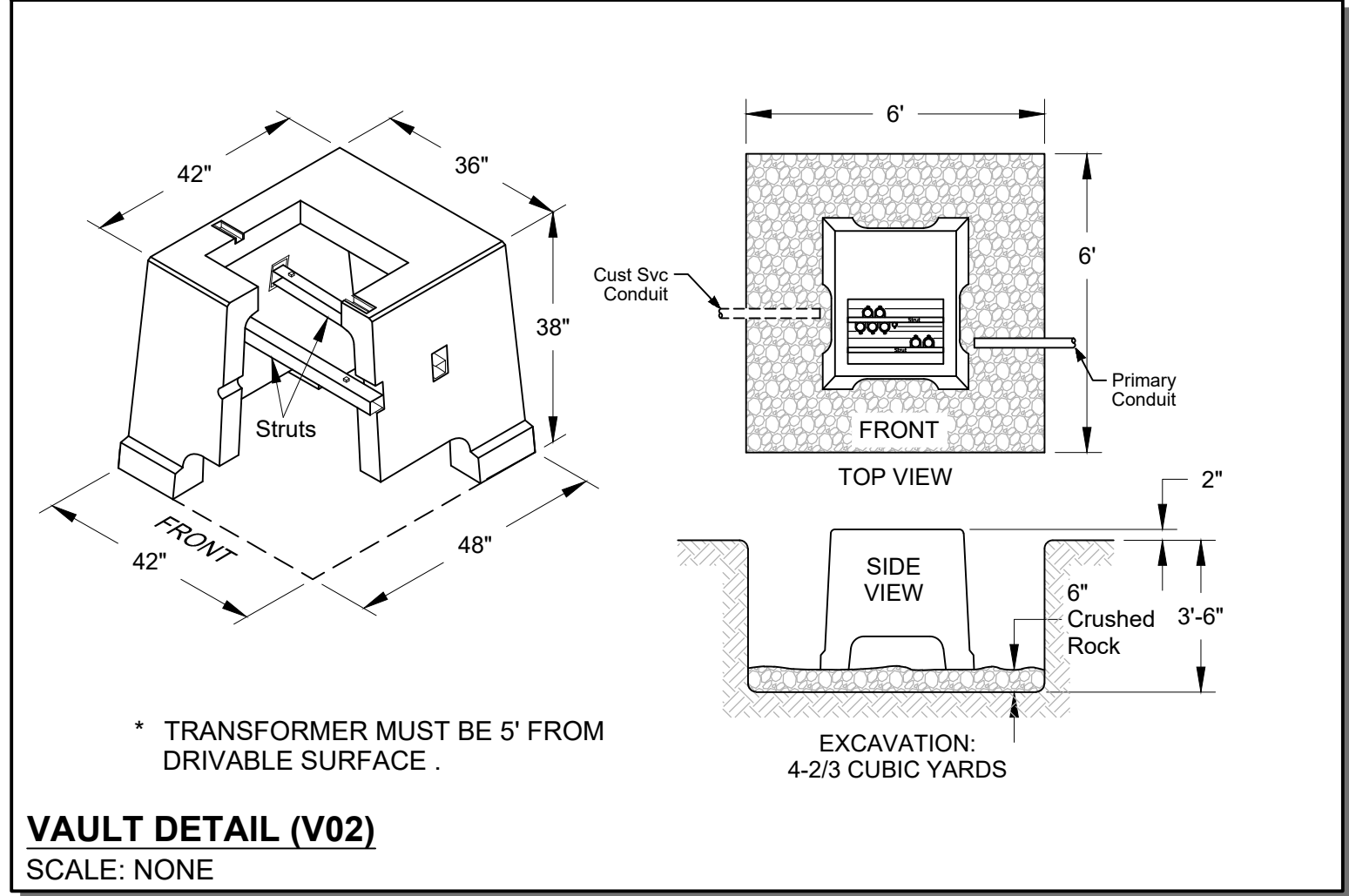

VAULT DETAIL (V02)
SCALE: NONE

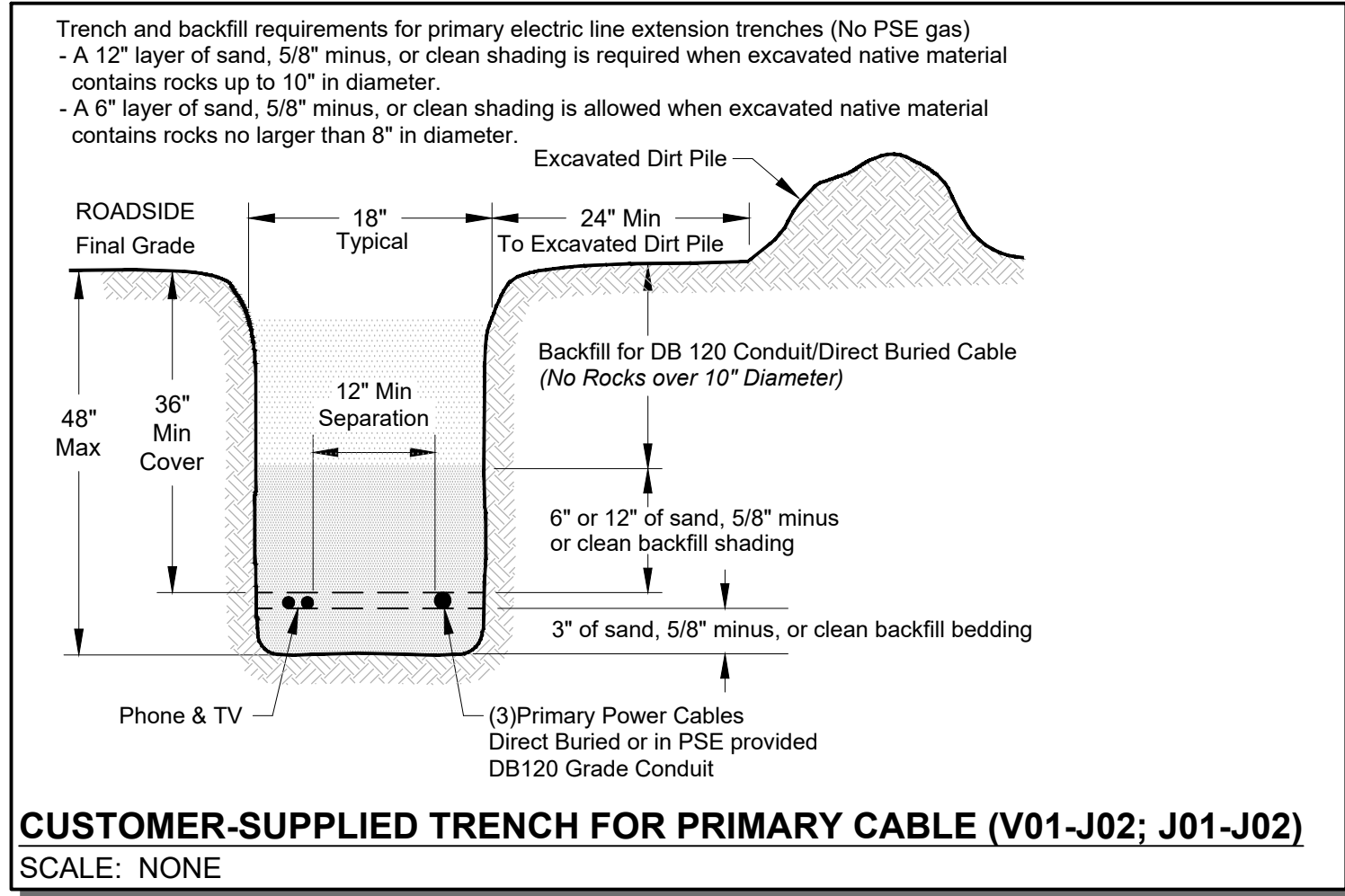

CUSTOMER-SUPPLIED TRENCH FOR PRIMARY CABLE (V01-J02; J01-J02)
SCALE: NONE

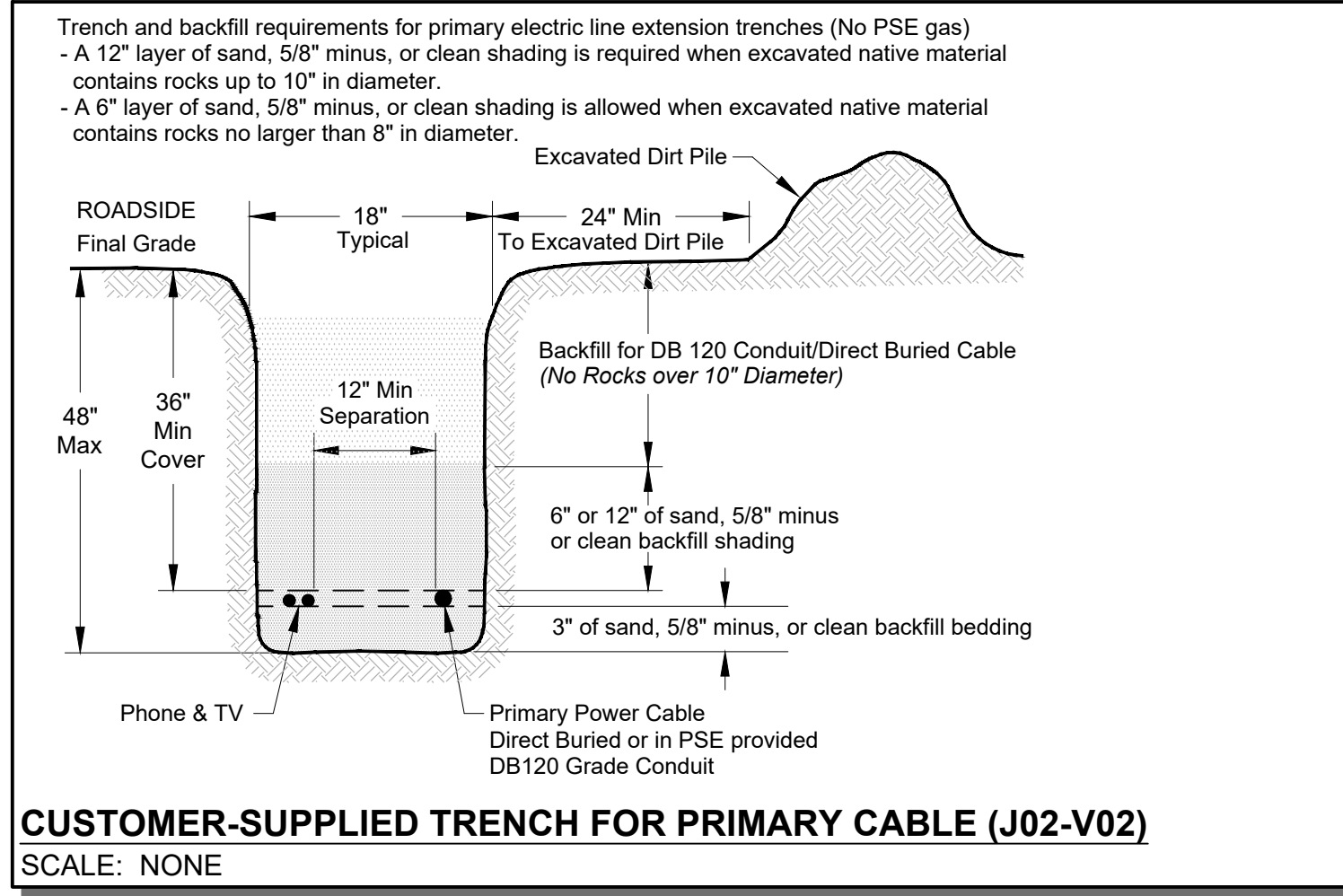

CUSTOMER-SUPPLIED TRENCH FOR PRIMARY CABLE (J02-V02)
SCALE: NONE

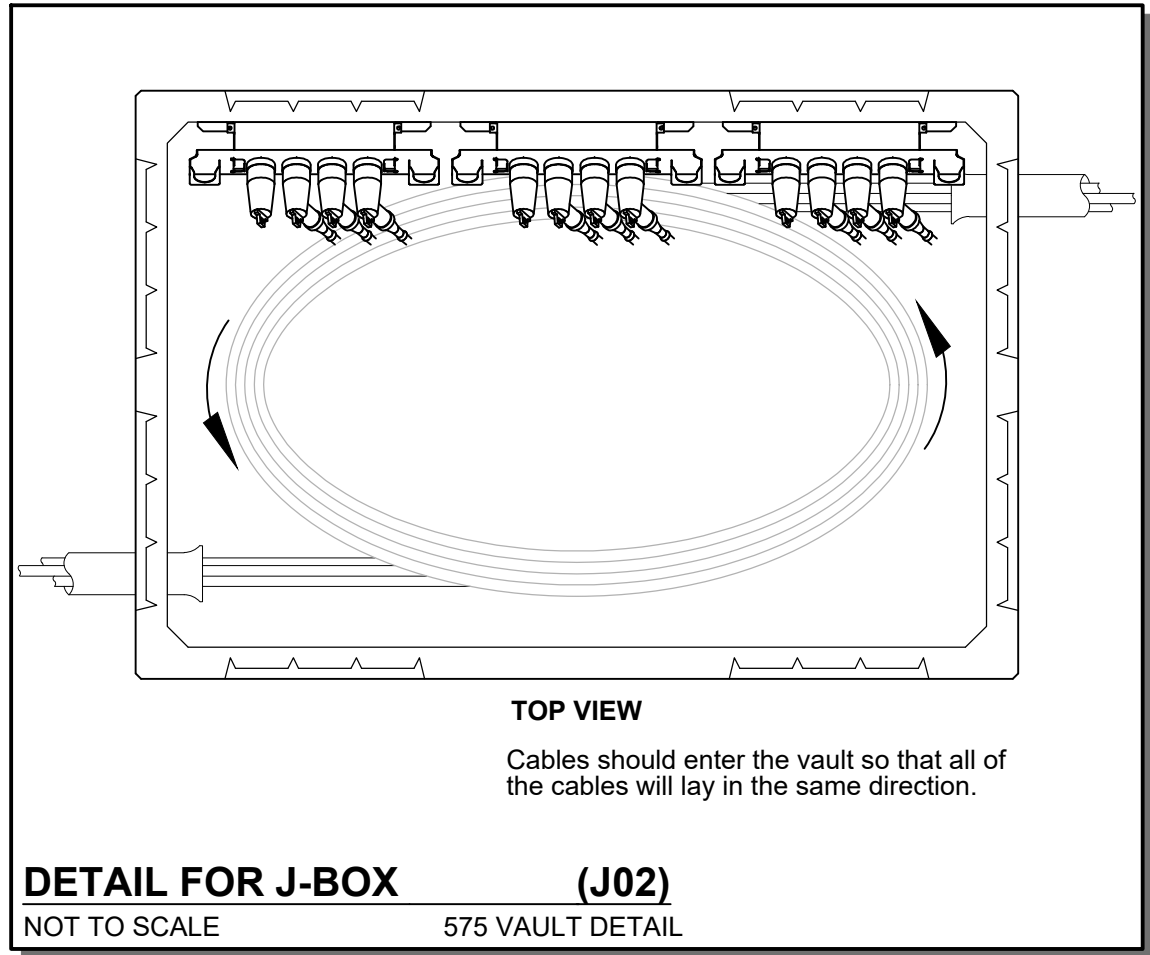

DETAIL FOR J-BOX (J02)
NOT TO SCALE 575 VAULT DETAIL

Project Manager Contact Information:
Manager: Shannon Tincknell
Cell Phone: 253-303-1638
E-Mail: Shannon.Tincknell@pse.com

For contacts below dial 1-888-CALL PSE (225-5773)

CALL (800) 424-5555
2 BUSINESS DAYS BEFORE YOU DIG
THIS SKETCH NOT TO BE RELIED UPON FOR EXACT LOCATION OF EXISTING FACILITIES

REAL ESTATE/EASEMENT	PERMIT
N/A	N/A

REV#	DATE	BY	DESCRIPTION	ENGR - GAS
3				
2				
1				

COUNTY	Emer Sect	Gas Wk Ctr	POWER WK CTR	QSTHLE	DRAWN BY	APPROVED BY	FOREMAN #1	FOREMAN #2	MAPPING
Thurston					P. Courtney				

U-MAP NO (POWER)	OH CKT MAP	UG CKT MAP	CIRCUIT NO	PLG-16
1801W065	1801W068	1801W065		

JOINT FACILITIES ARRANGEMENTS

UTILITIES CONTACT	PHONE#

PSE
PUGET SOUND ENERGY
DESIGNED BY PSE

School District EV Charging Station
Cmtrl - 3Ø Line Extension Repl J-Box
305 College St NE Lacey, WA 98516

INCIDENT	MAOP
Gas Order	Elect Order

SCALE: AS NOTED
PAGE: 02/02

105097520