

SEC 11, TWN 18, RGE 1W, W.M.

THE LANDING AT HAWKS PRAIRIE

SITE PLAN REVIEW

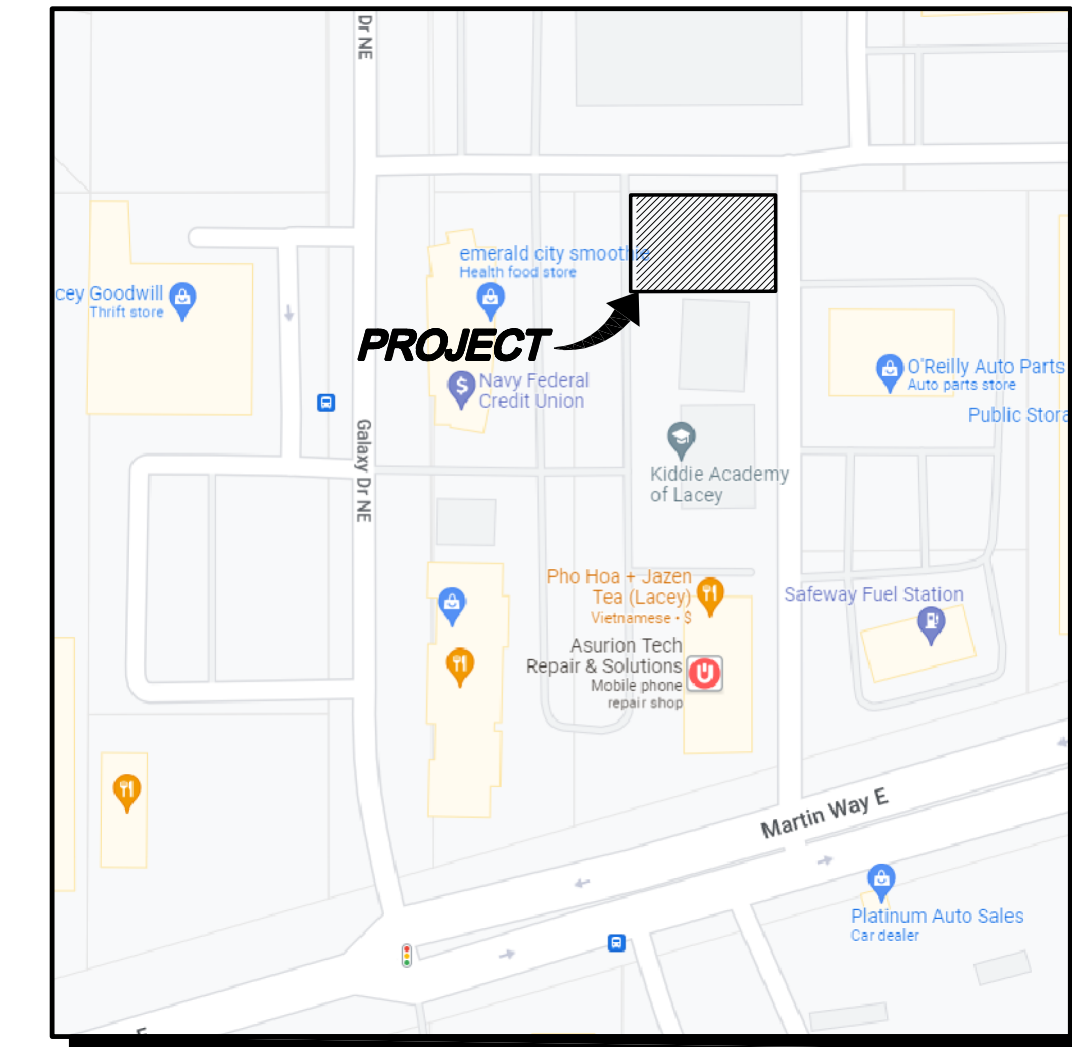
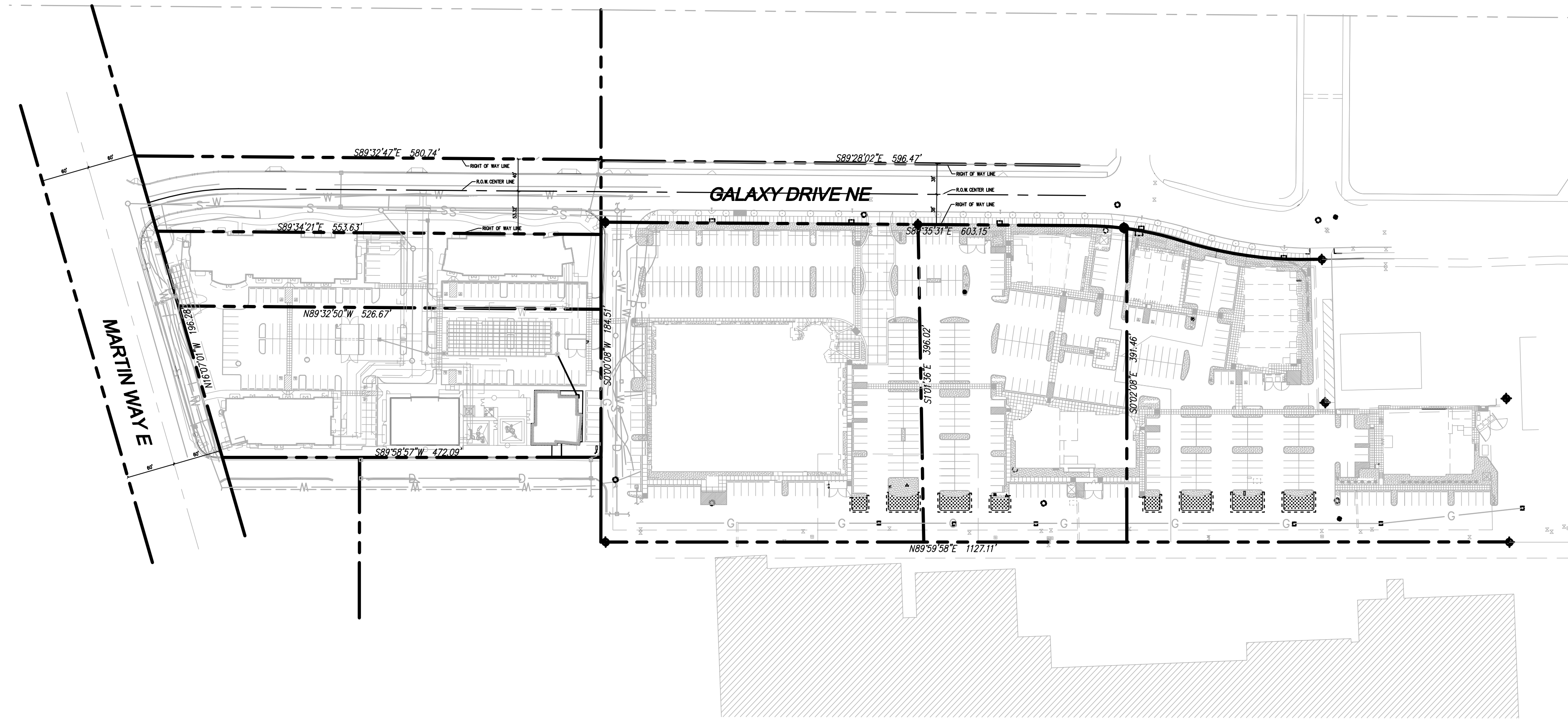

VICINITY MAP
NOT TO SCALE

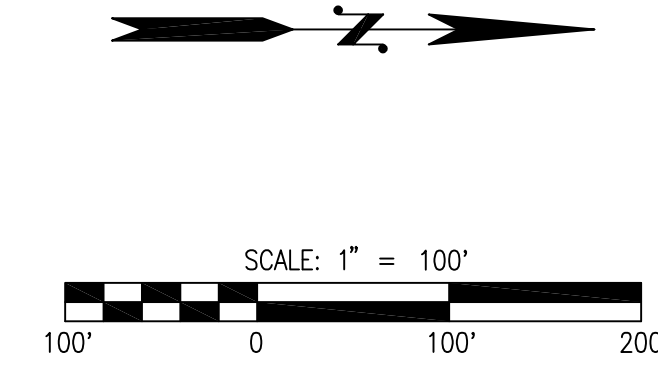

SHEET LIST TABLE		
SHEET NUMBER	SHEET TITLE	DESCRIPTION
1	CS-01	COVER SHEET
2	EX-01	EXISTING CONDITIONS PLAN
3	EC-01	DEMOLITION AND TESC PLAN
4	SP-01	SITE IMPROVEMENT PLAN
5	UT-01	UTILITIES PLAN

CONTACT LIST
OWNER/APPLICANT/DEVELOPMENT MANAGER:
MSGS ARCHITECTS
510 CAPITAL WAY SOUTH
OLYMPIA WA 98501
CONTACT: GARNER MILLER

CIVIL ENGINEER:
LDC, INC.
1411 STATE AVE NE, STE 200
OLYMPIA, WA 98506
CONTACT: ROSS JARVIS, PE
PHONE: (425) 806-1869
FAX: (425) 492-2893
EMAIL: RJJARVIS@LDCORP.COM

PROJECT INFORMATION
TAX PARCEL: 11811430400 / 82730000100 / 82730000200
SITE ADDRESS: 1120 GALAXY DRIVE NE / 1200 GALAXY DRIVE NE / 1300 GALAXY DRIVE NE
SITE AREA: 8,600 SF (0.20 ACRES)
CURRENT ZONING: GC

SURVEY INFORMATION
VERTICAL DATUM
CITY OF LACEY NGVD29
HORIZONTAL DATUM
CITY OF LACEY COORDINATE SYSTEM

UTILITY NOTE
THE CONTRACTOR SHALL VERIFY THE LOCATION OF ALL EXISTING UTILITIES PRIOR TO ANY CONSTRUCTION. AGENCIES INVOLVED SHALL BE NOTIFIED WITHIN A REASONABLE TIME PRIOR TO THE START OF CONSTRUCTION.



NO.	DATE	REVISIONS DESCRIPTION

LDC Surveying Engineering Planning
Woodinville
Olympia
1411 State Avenue NE, #200
Olympia, WA 98506
www.LDCcorp.com
F: 425-806-1869

MSGS ARCHITECTS
THE LANDING AT HAWKS PRAIRIE
PHASE II - NEW BUILDING
COVER SHEET



JOB NUMBER: C22213
DRAWING NAME: CV-01
DESIGNER: R.WEEDEN
DRAFTING BY: A.WHITE
DATE: JULY 2022
SCALE: 1" = 100'
JURISDICTION: LACEY, WA

CV-01
SHEET 1 OF 5

Drawing: F:\Civil\2022\C22-213 The Landing at Hawks Prairie (Drawings\Preliminary)\Archive\C22213-CV-01.dwg Plotted: Jun 30, 2022 - 10:51am

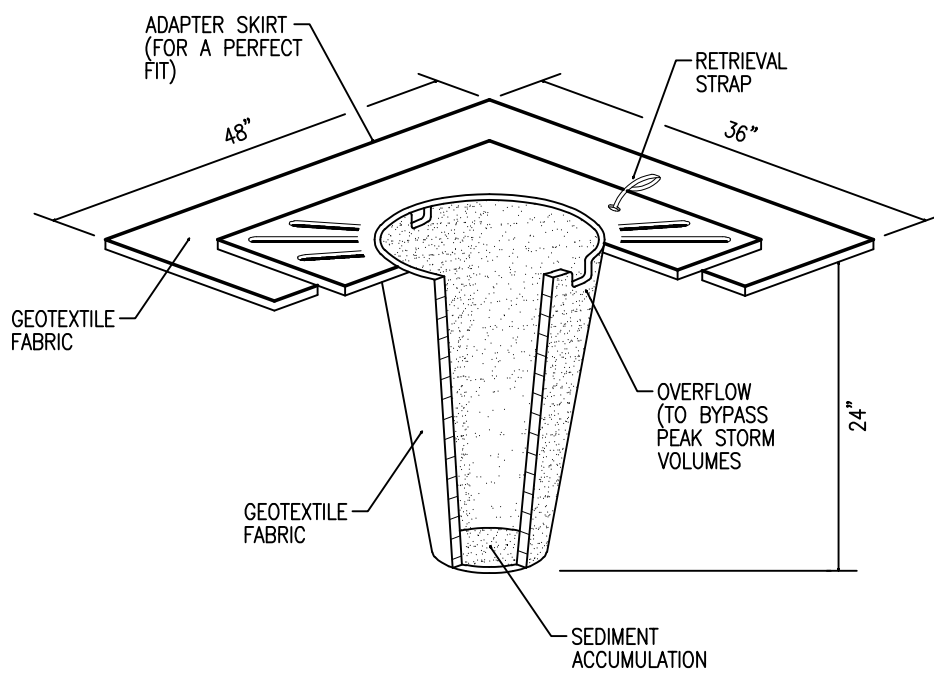
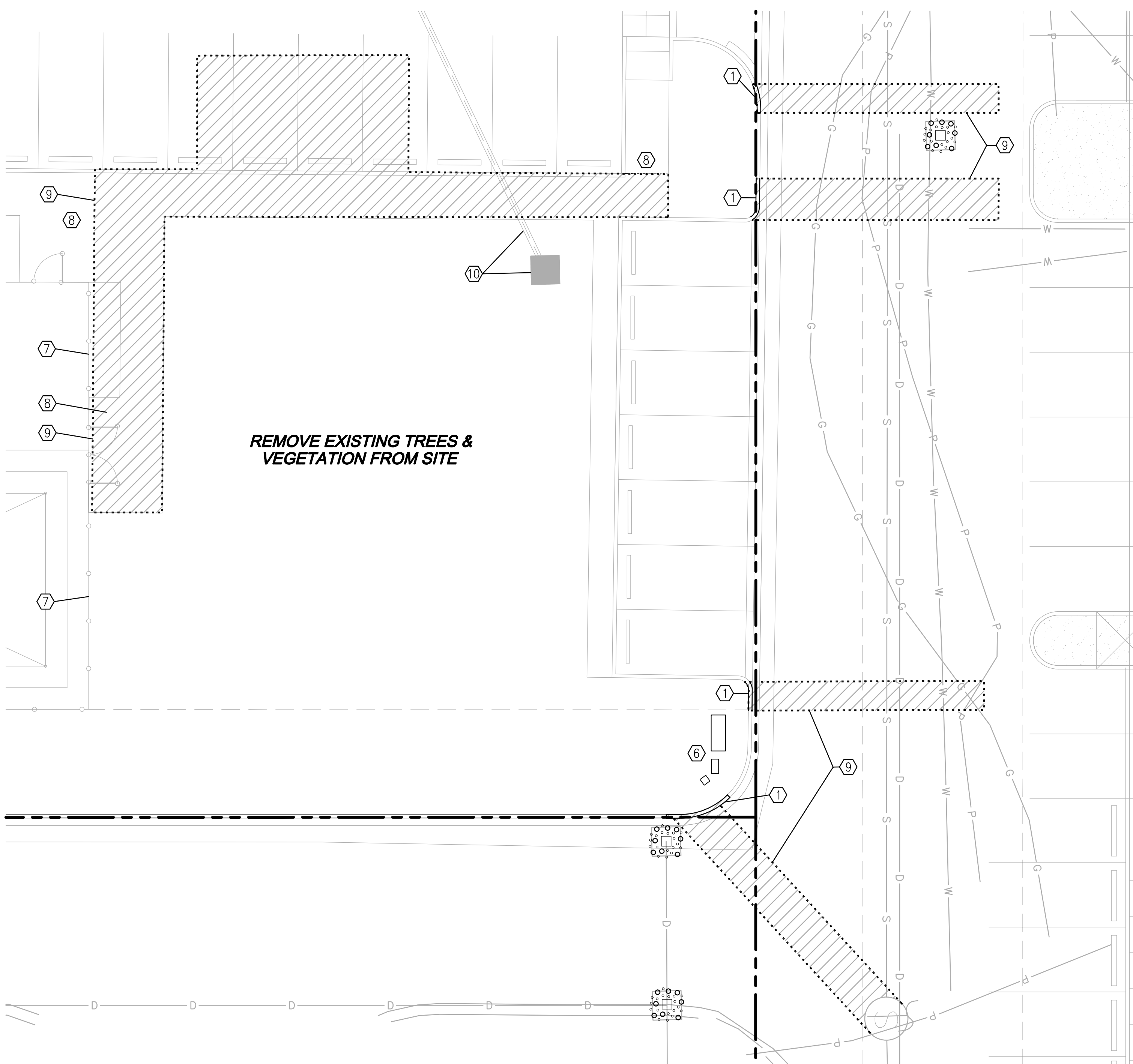
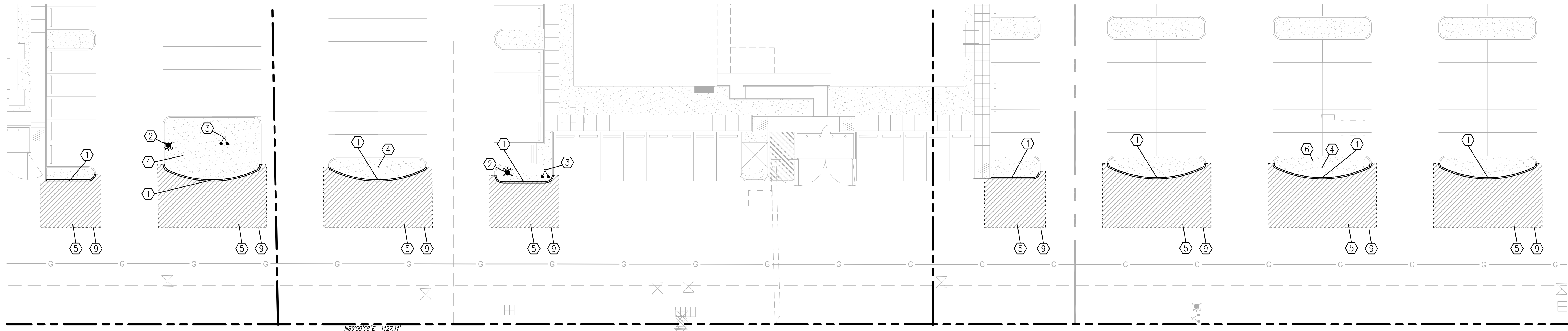

STORM DRAIN INLET PROTECTION
NOT TO SCALE

LEGEND

- STORM DRAIN INLET PROTECTION
- SAWCUT LINE
- EXISTING CURB
- REMOVE & DISPOSE OF EX. SIDEWALK, CURBS & ASPHALT PAVEMENT

NOTES

1. REMOVE & DISPOSE OF EXISTING CEMENT CONCRETE CURB TO NEAREST JOINT
2. PROTECT IN-PLACE HYDRANT ASSEMBLY
3. PROTECT IN-PLACE FIRE DEPARTMENT CONNECTION
4. PROTECT IN-PLACE EX. LIGHTPOLE & BASE
5. REMOVE EX. ASPHALT PAVING & BASE
6. PROTECT IN-PLACE MONUMENT SIGN
7. PROTECT IN-PLACE PLAYGROUND FENCE
8. PROTECT IN-PLACE EX. SIDEWALK
9. SAWCUT AT LIMITS (TYP.)
10. REMOVE & DISPOSE OF EXISTING STORM STRUCTURE. CAP AND PLUG EXISTING STORM LINE, FILL WITH CDF

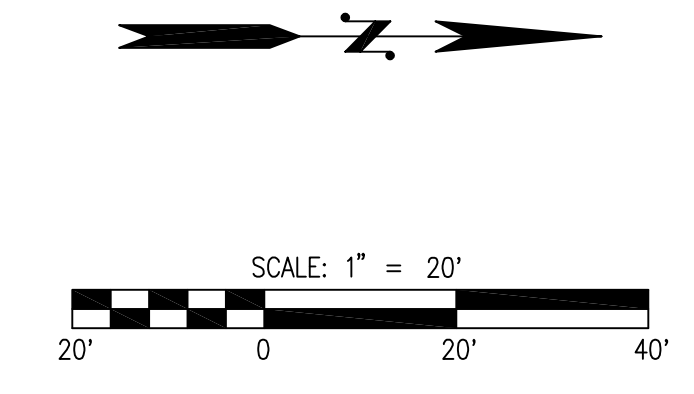
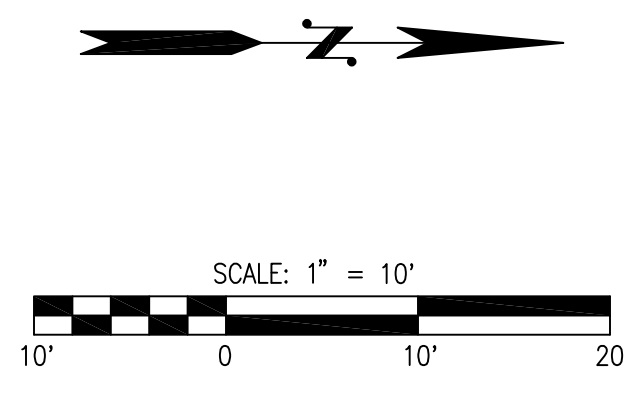

UTILITY NOTE

THE CONTRACTOR SHALL VERIFY THE LOCATION OF ALL EXISTING UTILITIES PRIOR TO ANY CONSTRUCTION. AGENCIES INVOLVED SHALL BE NOTIFIED WITHIN A REASONABLE TIME PRIOR TO THE START OF CONSTRUCTION.

Call 2 Business Days Before You Dig
811 or 1-800-424-5555
Utilities Underground Location Center

NO.	DATE	DESCRIPTION

LDC
Woodville
1411 State Avenue NE, #200
Olympia, WA 98506
T: 425.806.1869
www.LDCcorp.com
F: 425.882.8993

Surveying
Engineering
Planning

Kent

MSGs ARCHITECTS

**THE LANDING AT HAWKS PRAIRIE
PHASE II - NEW BUILDING**

DEMOLITION & TESC PLAN

JOB NUMBER:	C22213
DRAWING NAME:	EC-01
DESIGNER:	R.WEEDEN
DRAFTING BY:	A.WHITE
DATE:	JULY 2022
SCALE:	AS SHOWN
JURISDICTION:	LACEY, WA

Drawing: F:\CWA\2022\C22-213 - The Landing at Hawks Prairie (Drawings\Preliminary)\Archive\C22213-EC-01.dwg Plotted: Jun 30, 2022 - 10:53am

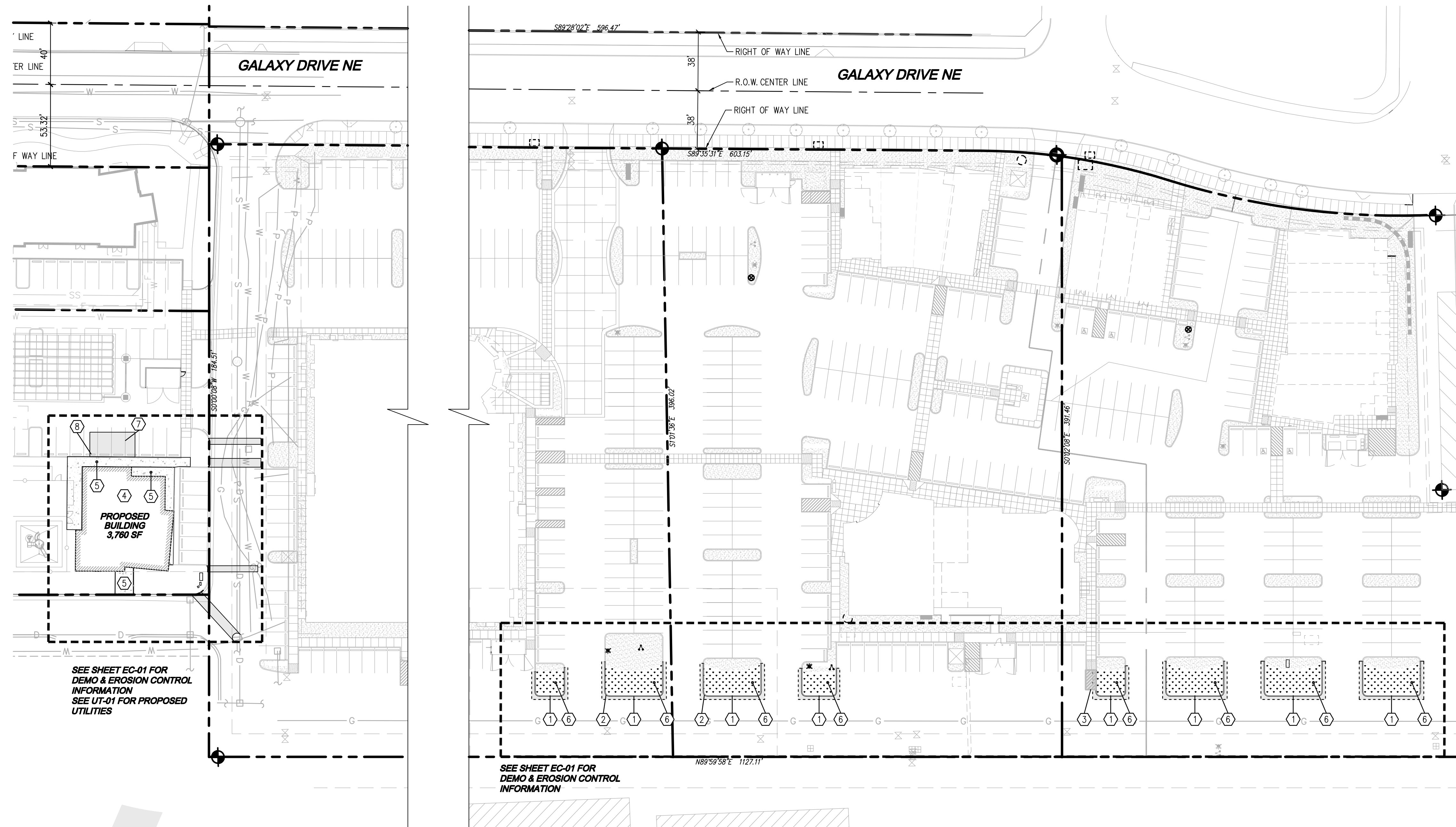

SITE PLAN LEGEND

- PROPOSED BUILDING
- PROPOSED LANDSCAPE AREA
- PROPOSED ASPHALT PAVING AREA
- PROPOSED CONCRETE SIDEWALK AREA
- PROPOSED TRAFFIC CURB

SITE PLAN NOTES

1. INSTALL NEW TRAFFIC CURB
2. PAINT CURB FIRE TRUCK RED & STENCIL "NO PARKING FIRELANE" ON CURB FACE. MATCH ORIGINAL PAINT LIMITS
3. 4" WIDE WHITE STRIPING @ 45°
PAINT 2 COATS TRAFFIC WHITE WITH 7MIL DFT PER COAT (TYP.)
4. PROPOSED BUILDING
5. PROPOSED CEMENT CONCRETE SIDEWALK W/INTEGRAL CURB
6. LANDSCAPING BY OTHERS
7. 4" WIDE WHITE PARKING STALL STRIPE
PAINT 2 COATS TRAFFIC WHITE WITH 7MIL DFT PER COAT (TYP.)
8. RE-INSTALL PARKING WHEEL STOPS (TYP.)

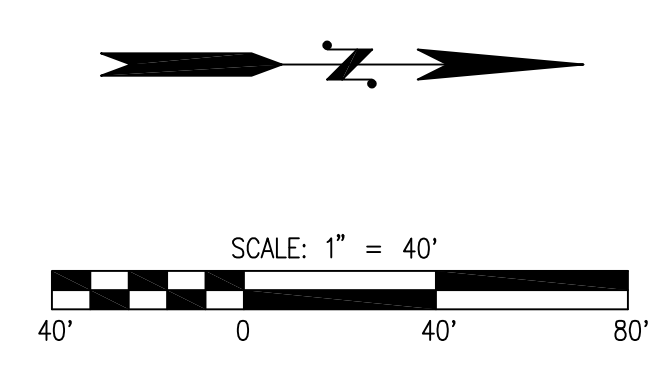

UTILITY NOTE

THE CONTRACTOR SHALL VERIFY THE LOCATION OF ALL EXISTING UTILITIES PRIOR TO ANY CONSTRUCTION. AGENCIES INVOLVED SHALL BE NOTIFIED WITHIN A REASONABLE TIME PRIOR TO THE START OF CONSTRUCTION.

Call 2 Business Days Before You Dig
811 or 1-800-424-5555
Utilities Underground Location Center

NO.	DATE	DESCRIPTION

LDC Surveying Engineering Planning
Kent
1411 State Avenue NE, #200
Olympia, WA 98506
www.LDCcorp.com
F: 425-482-8993

MSG'S ARCHITECTS
THE LANDING AT HAWKS PRAIRIE
PHASE II - NEW BUILDING
OVERALL SITE PLAN

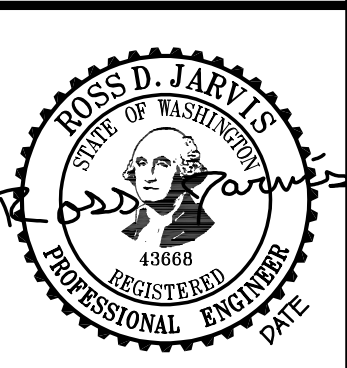

JOB NUMBER: C22213
DRAWING NAME: SP-01
DESIGNER: R.WEEDEN
DRAFTING BY: A.WHITE
DATE: JUNE 2022
SCALE: 1" = 40'
JURISDICTION:

SP-01
SHEET 4 OF 5

SEC 11, TWN 18, RGE 1W, W.M.

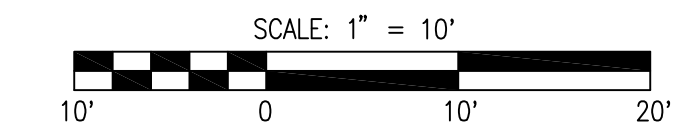

LEGEND

SYMBOL	DESCRIPTION
	WATER PIPE
	SEWER PIPE
	FIRE HYDRANT
	VALVE
	FIRE DEPARTMENT CONNECTION
	WATER METER
	RPBA
	SEWER CLEANOUT
	TYPE 1 CB
	POST INDICATOR VALVE (PIV)

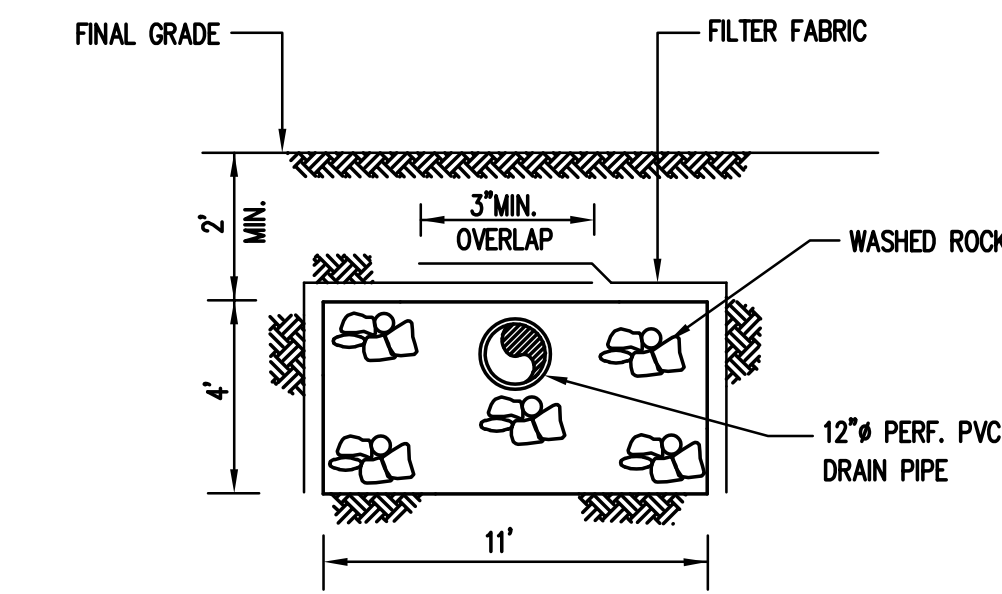

ROCK GALLERY DETAIL
NTS

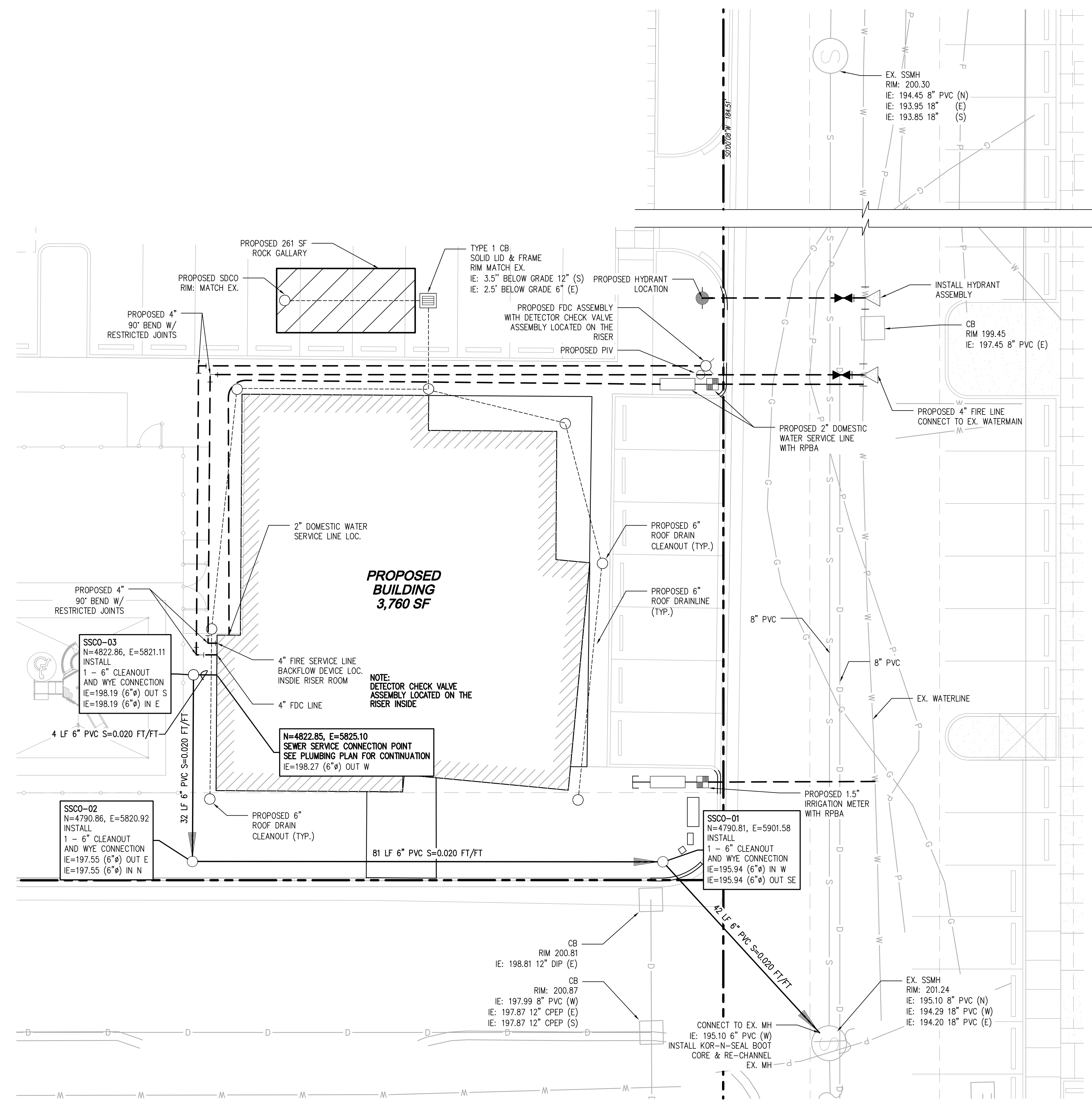

UTILITY NOTE

THE CONTRACTOR SHALL VERIFY THE LOCATION OF ALL EXISTING UTILITIES PRIOR TO ANY CONSTRUCTION. AGENCIES INVOLVED SHALL BE NOTIFIED WITHIN A REASONABLE TIME PRIOR TO THE START OF CONSTRUCTION.

Call 2 Business Days Before You Dig
811 or 1-800-424-5555
Utilities Underground Location Center

NO.	DATE	DESCRIPTION

LDC
Woodruffville
1411 State Avenue NE #200
Olympia, WA 98516
www.LDCcorp.com
T: 425-896-1868
F: 425-892-2893

MSGS ARCHITECTS
THE LANDING AT HAWKS PRAIRIE
PHASE II - NEW BUILDING
UTILITIES PLAN



JOB NUMBER:	C22213
DRAWING NAME:	UT-01
DESIGNER:	R.WEEDEN
DRAFTING BY:	A.WHITE
DATE:	JULY 2022
SCALE:	1" = 10'
JURISDICTION:	LACEY WA

Drawing: P:\Civil\2022\C22213 - The Landing at Hawks Prairie Drawings (Preliminary) - Arch\w\22213-UT-01.dwg Plotted: Jun 30, 2022 - 2:19pm