

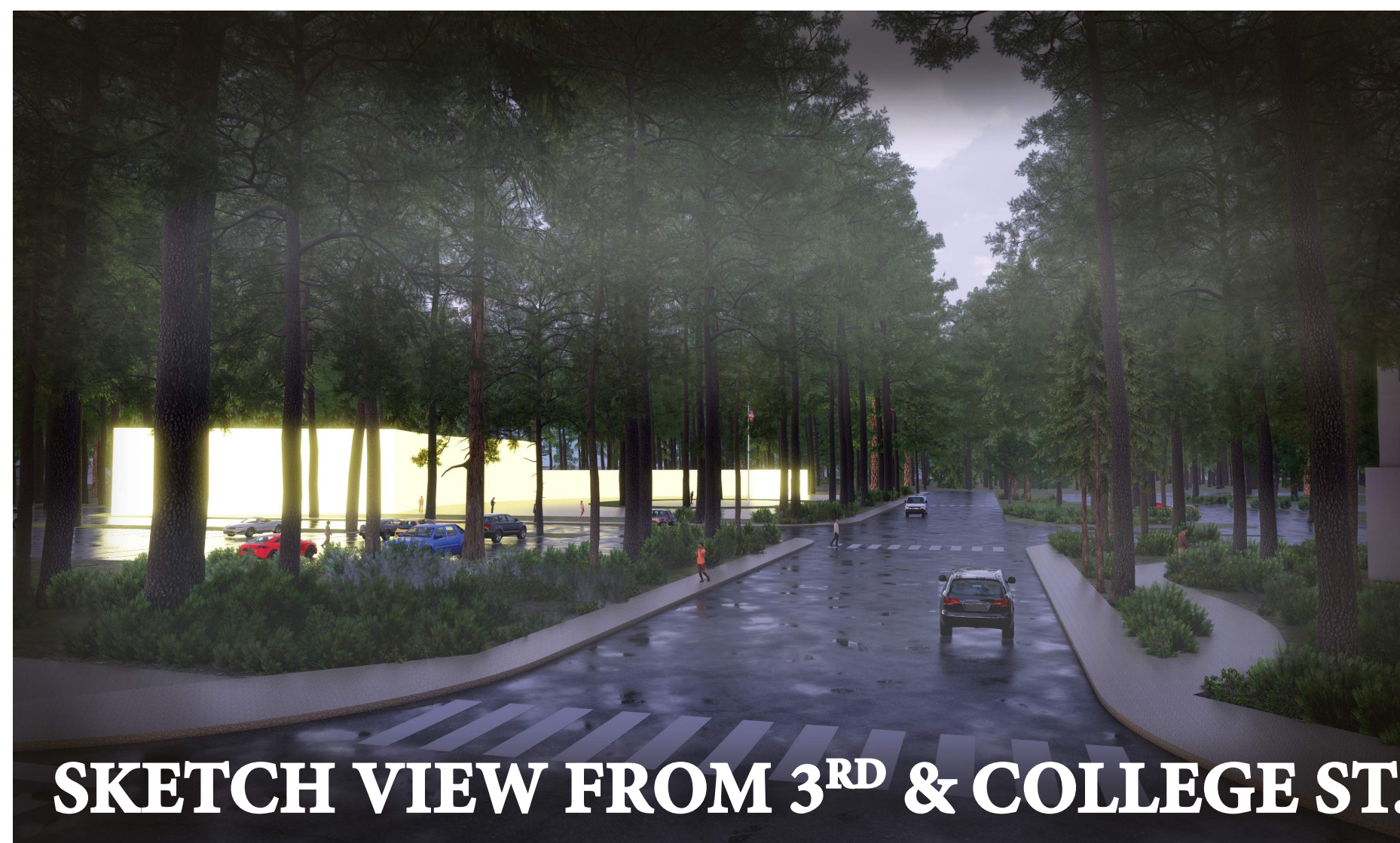

FUTURE LACEY POLICE STATION

COMMUNITY FOCUS AND SAFETY

The design of the new Lacey Police Station will emphasize community engagement, accommodate contemporary police programs, and enhance public safety.



SKETCH VIEW FROM 3RD & COLLEGE ST.

LOCATION

The City of Lacey (City) has entered into an agreement with Saint Martin's University to purchase a parcel of land adjacent to the City Hall campus.



LOBBY

NEW POLICE STATION DESIGN

The new Lacey Police Station is currently in the design phase. It is anticipated to be approximately 40,000 square feet to meet the needs of our full-service law enforcement agency — serving one of the fastest growing communities in western Washington — for the next 30-40 years.

FACILITY ENHANCEMENTS

The new facility will include the following enhancements with an emphasis on accessibility, diversity, equity, and inclusion:

- **Community-Engagement Spaces** for community events and meetings.
- **Safe Spaces** for custody exchanges and e-commerce transactions.
- **Improved Investigations Space** with safe, comfortable interview rooms that offer privacy for victims and witness, and safe, secure rooms to interview suspects.
- **Enhanced Training Areas** with designated spaces for classroom-based training, work out/physical training areas, and firearms training.
- **Emergency Operations Center (EOC)** that will withstand a natural disaster and allow for continuity of government services during a critical event (i.e. natural disaster, etc.).
- **Improved Officer Safety** including safe evidence handling and storage spaces, improved separation of secure spaces, and secure parking for personal and staff vehicles.



MEETING ROOM

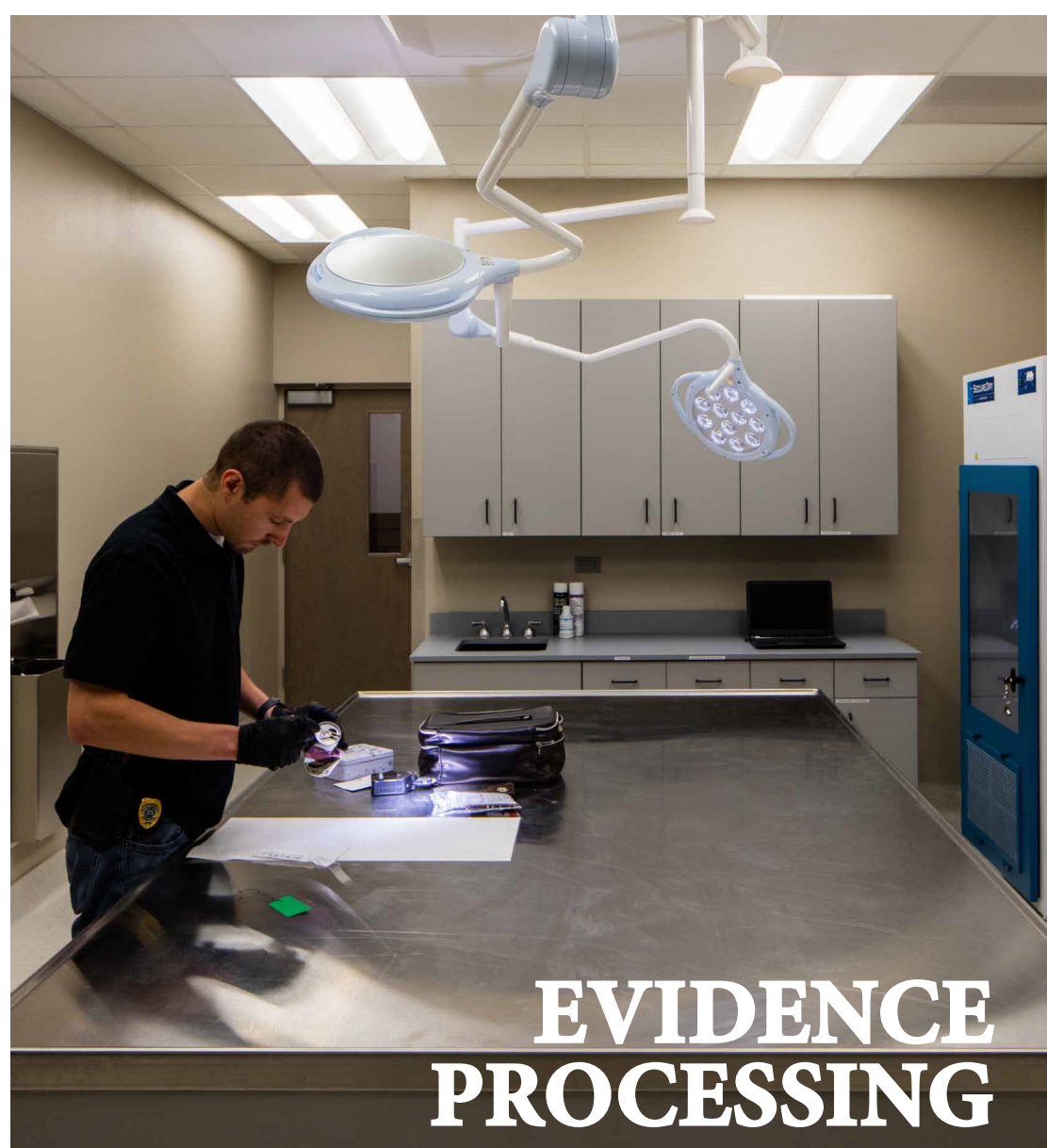

EVIDENCE PROCESSING

PROGRAMMING IMPROVEMENTS

The new facility will improve the Police Department's ability to provide programming with an emphasis on innovation, technology, and wellness, including:

- **Community Outreach Programs:** Mobile Outreach Team (emotional & mental health support) and Domestic Violence Victim Advocacy Groups.
- **Specialized Policing Programs:** Traffic Enforcement, Community Resource Unit, School Resource Officers, and Lacey Resource Unit Volunteers.



REPORT-WRITING ROOM



OFFICE/WORK AREA

LEARN MORE

To find out more, visit CityOfLacey.org/FutureLPDStation or scan:



PROJECT TIMELINE

2019

The City completed an analysis and needs assessment of the Lacey Police Department (LPD).

2022

The City contracted with KMB and Roth Shepard Architects to complete a schematic design of the new facility, based on the 2019 needs-assessment study.

The LPD formed a Community Advisory Panel to provide input and feedback throughout the new facility design process.

2025

The LPD seeks to open new police station.