

LANDSCAPE NOTES AND SOIL QUALITY

1. PROVIDE LANDSCAPE PLANTING TO SCREEN ALL OUTDOOR UTILITY EQUIPMENT. PLANT OPTIONS INCLUDE: BLUE ICE ARIZONA CYPRESS, PURPLE ROCK ROSE, PINK PRINCESS ESCALLONIA, OR PACIFIC WAX MYRTLE.
2. LANDSCAPE AREAS SHOULD BE DEEP-TILLED TO A DEPTH OF AT LEAST TWELVE (12) INCHES TO FACILITATE DEEP WATER PENETRATION AND SOIL OXYGENATION. PROVIDE SOIL AMENDMENTS ENCOURAGED TO IMPROVE WATER DRAINAGE, MOISTURE PENETRATION OR WATER-HOLDING CAPACITY. FOR ALL NEWLY LANDSCAPED AREAS ORGANIC MATTER SHOULD BE INCORPORATED TO A DEPTH OF FOUR (4) TO SIX (6) INCHES TO FACILITATE DEEP WATER PENETRATION AND SOIL OXYGENATION.
3. CONTRACTOR SHALL PROVIDE 4" DEPTH IMPORTED TOPSOIL AT SEED MIX AREAS AND 9" DEPTH IMPORTED TOPSOIL AT ALL LANDSCAPE PLANTING AREAS.
4. COMPACT ALL SEED MIX AREAS IN TWO DIRECTIONS WITH ROLLER PRIOR TO HYDROSEEDING.
5. IMPORTED TOPSOIL SHALL BE 3-WAY MIX.
6. CONTRACTOR SHALL PROVIDE 2" DEPTH FINE COMPOST MULCH THROUGHOUT LANDSCAPE PLANTING AREAS.
7. CONTRACTOR SHALL GUARANTEE ALL PLANT MATERIALS FOR A PERIOD OF (1) ONE YEAR FROM TIME OF COMPLETION OF WORK.
8. TREES PLANTED FIVE FEET OR LESS FROM PAVED SURFACES SHALL BE PLANTED WITH ROOT CONTROL BARRIER.

PLANT LEGEND

QTY	BOTANICAL NAME	COMMON NAME	SIZE & SPACING
TREES			
3	CERCIDIPHYLLUM JAPONICUM	KATSURA TREE	2" CALIPER, 30" O.C., 5' GRAFT
9	CUPRESSUS ARIZONICA VAR. GLABRA	BLUE ICE SMOOTH CYPRESS	6'-8" HEIGHT, SPACING PER PLAN
13	CUPRESSUS x LEYLANDII	LEYLAND CYPRESS	7' MIN. HEIGHT, 10' O.C SPACING
100	THUJA OCCIDENTALIS 'SMARAGD'	EMERALD GREEN ARBOVITAE	4' HEIGHT, 4' O.C SPACING
SHRUBS			
84	CISTUS X PURPUREA	PURPLE ROCK ROSE	MIN. 16" HT., 4' O.C. SPACING
40	MYRICA CALIFORNICA	PACIFIC WAX MYRTLE	MIN. 16" HT., 10" O.C. SPACING
87	AZALEA 'PURPLE GEM'	PURPLE GEM AZALEA	2 GALLON, 3' O.C. SPACING
24	CORNUS SERICEA 'KELSEY'	KELSEY DOGWOOD	MIN. 16" HT., 3' O.C. SPACING
5	CALAMAGROSTIS 'KARL FOERSTER'	KARL FOERSTER FEATHER REED GRASS	2 GALLON, 3' O.C. SPACING
GROUND COVER			
102	ARCTOSTYPYLLOS UVA-URSI	KINNIKINICK	1 GALLON, 30" O.C. SPACING
40	CALLUNA VULGARIS 'FIRE STAR'	FIRE STAR CALLUNA	1 GALLON, 30" O.C. SPACING

MISCELLANEOUS

	3"-6" DRAIN ROCK
	5/8" MINUS CRUSHED ROCK PATH
	DARK BARK MULCH

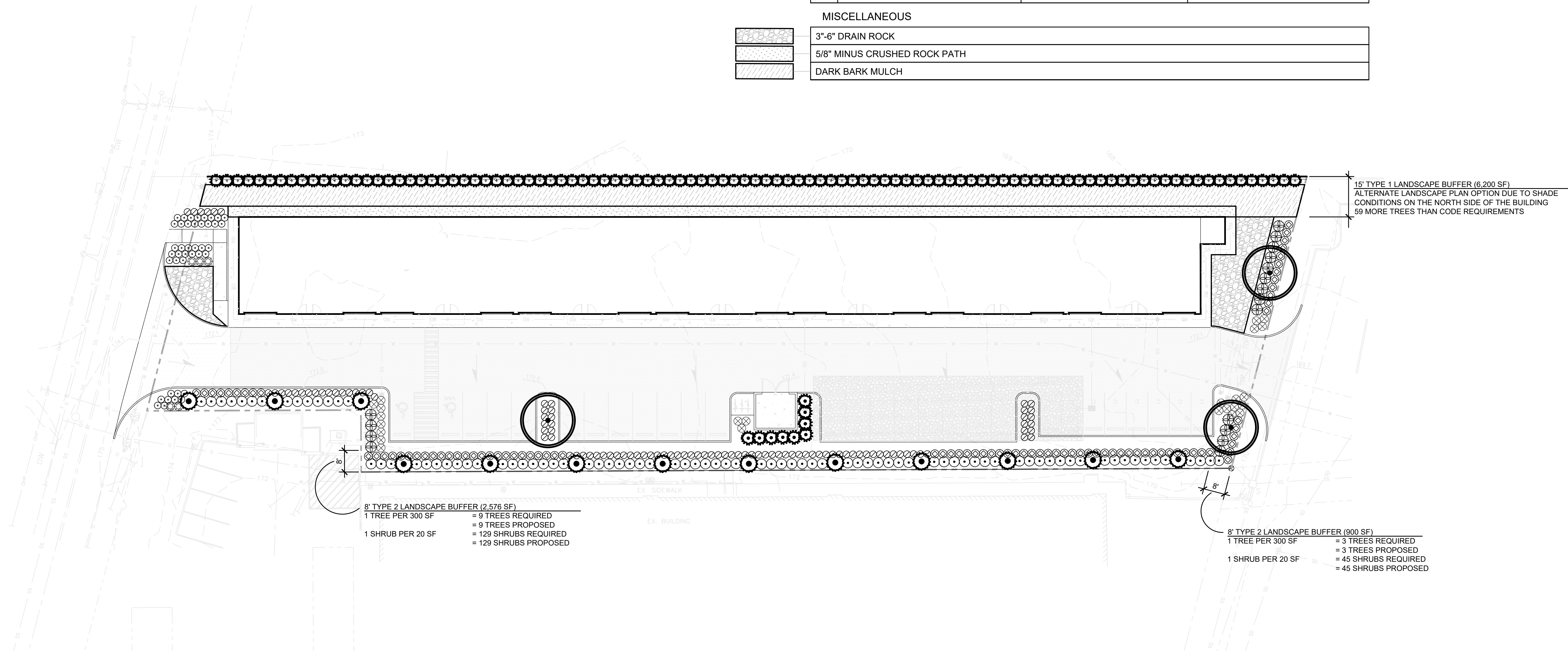

Ulery Street Development
1070 ULERY STREET SOUTHEAST
LACEY, WA 98503

Eric J. Williams, Landscape Architect
LANDSCAPE ARCHITECTURE & SITE PLANNING
1529 SOUTH SEASHORE DRIVE
TACOMA, WA 98465
253-676-4173
wstudio70@yahoo.com

Drawing:
LANDSCAPE PLAN

Date: May 30, 2023
Job #: ulery 2023
Scale: 1"=20'-0"
Design: E.J.W.
Drawn: E.J.W.
Check:
Revisions:

Sheet:
L1.00

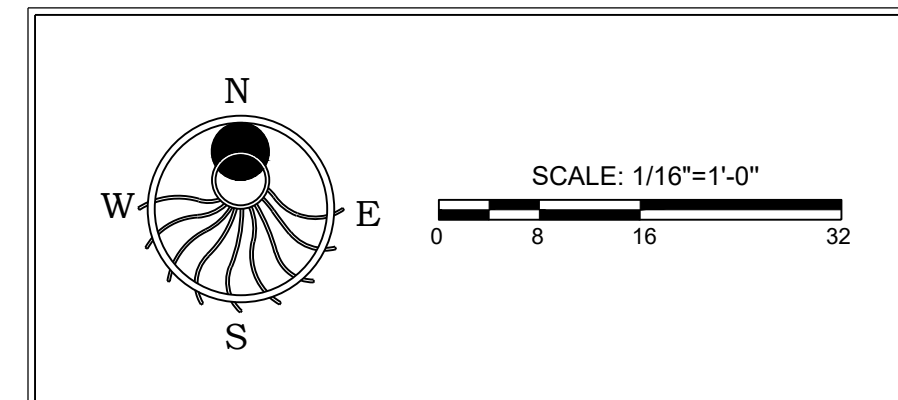

PLANT LEGEND

QTY	BOTANICAL NAME	COMMON NAME	SIZE & SPACING
TREES			
3	CERCIDIPHYLLUM JAPONICUM	KATSURA TREE	2" CALIPER, 30' O.C., 5' GRAFT
9	CUPRESSUS ARIZONICA VAR. GLABRA	BLUE ICE SMOOTH CYPRESS	6'-8' HEIGHT, SPACING PER PLAN
13	CUPRESSUS x LEYLANDII	LEYLAND CYPRESS	7' MIN. HEIGHT, 10' O.C SPACING
100	THUJA OCCIDENTALIS 'SMARAGD'	EMERALD GREEN ARBOVITAE	4' HEIGHT, 4' O.C SPACING
SHRUBS			
84	CISTUS X PURPUREA	PURPLE ROCK ROSE	MIN. 16" HT., 4' O.C. SPACING
40	MYRICA CALIFORNICA	PACIFIC WAX MYRTLE	MIN. 16" HT., 10' O.C. SPACING
87	AZALEA 'PURPLE GEM'	PURPLE GEM AZALEA	2 GALLON, 3' O.C. SPACING
24	CORNUS SERICEA 'KELSEY'	KELSEY DOGWOOD	MIN. 16" HT., 3' O.C. SPACING
5	CALAMAGROSTIS 'KARL FOERSTER'	KARL FOERSTER FEATHER REED GRASS	2 GALLON, 3' O.C. SPACING
GROUND COVER			
102	ARCTOSTYLOS UVA-URSI	KINNIKINNICK	1 GALLON, 30" O.C. SPACING
40	CALLUNA VULGARIS 'FIRE STAR'	FIRE STAR CALLUNA	1 GALLON, 30" O.C. SPACING
MISCELLANEOUS			
	3"-6" DRAIN ROCK		
	5/8" MINUS CRUSHED ROCK PATH		
	DARK BARK MULCH		

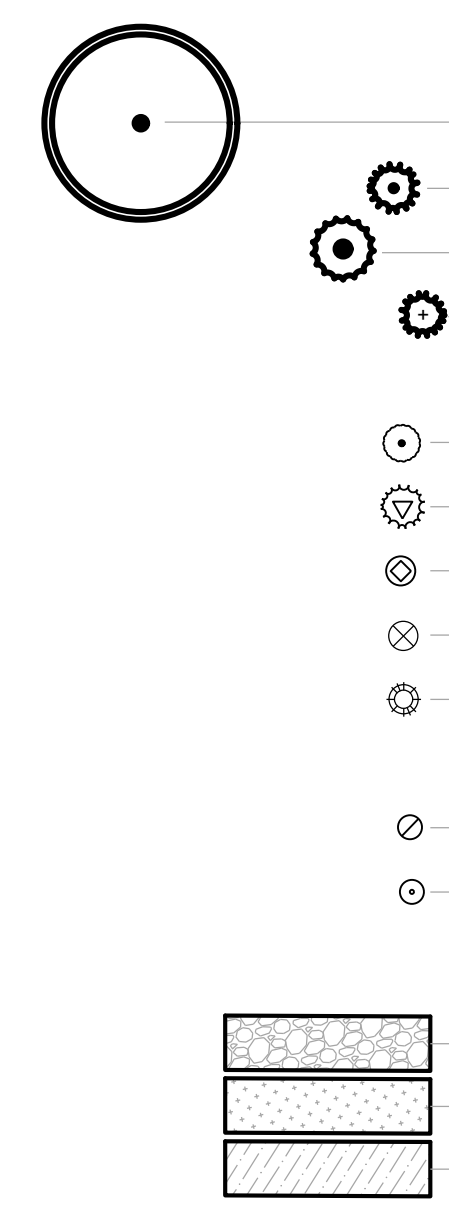

PLANT IMAGES



KATSURA TREE

BLUE ICE SMOOTH CYPRESS

LEYLAND CYPRESS

PURPLE ROCK ROSE

PACIFIC WAX MYRTLE

FIREPOWER HEAVENLY BAMBOO

PURPLE GEM AZALEA

KELSEY DOGWOOD

KARL FOERSTER FEATHER REED GRASS

KINNIKINNICK

FIRE FLY CALLUNA

Drawing:
PLANT LEGEND AND IMAGES

Date: May 30, 2023
 Job # ulery 2023
 Scale: NTS
 Design: EJW
 Drawn: EJW
 Check: _____
 Revisions: _____

Sheet:
L1.01

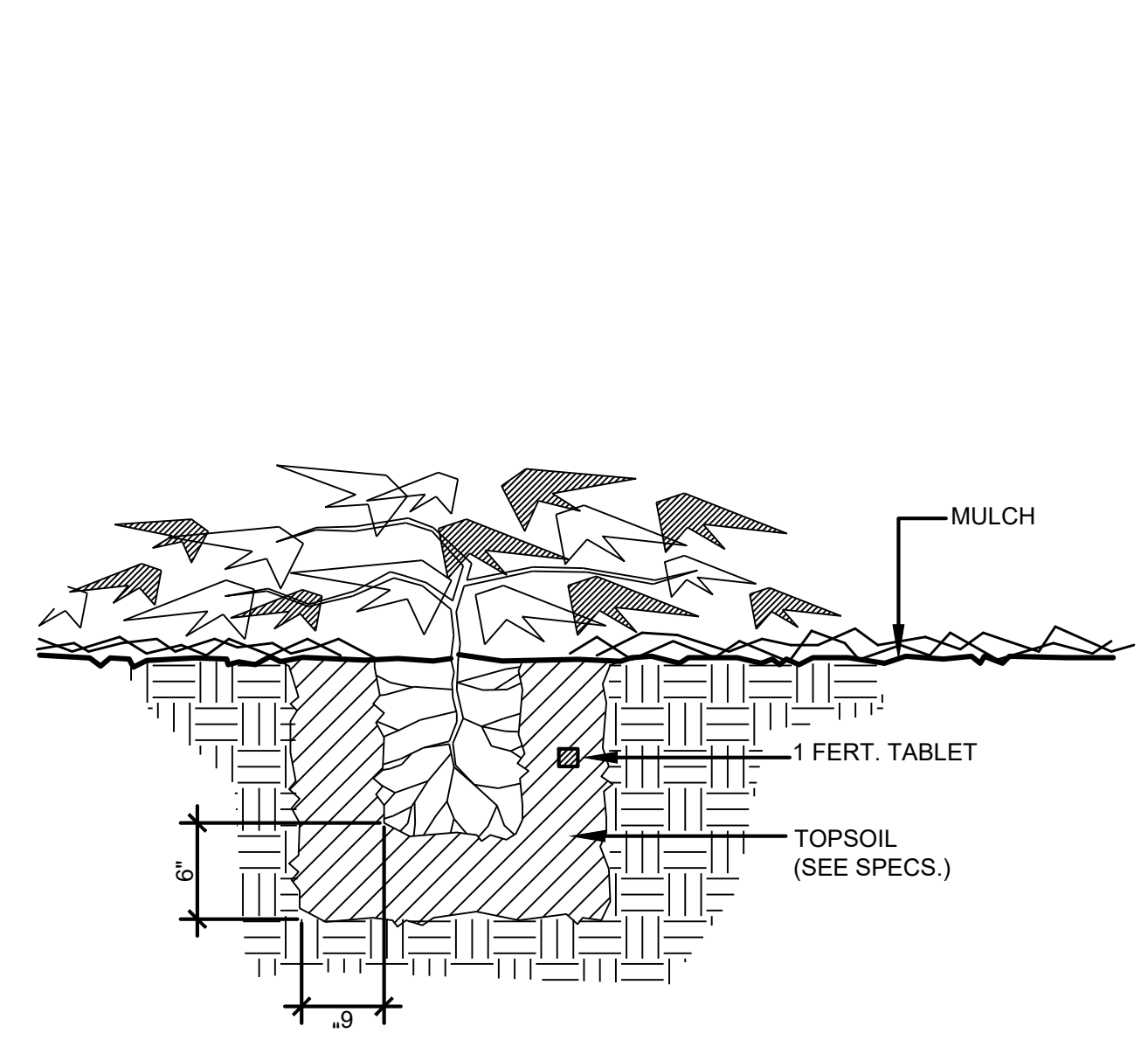

1 GROUNDCOVER PLANTING
 NOT TO SCALE

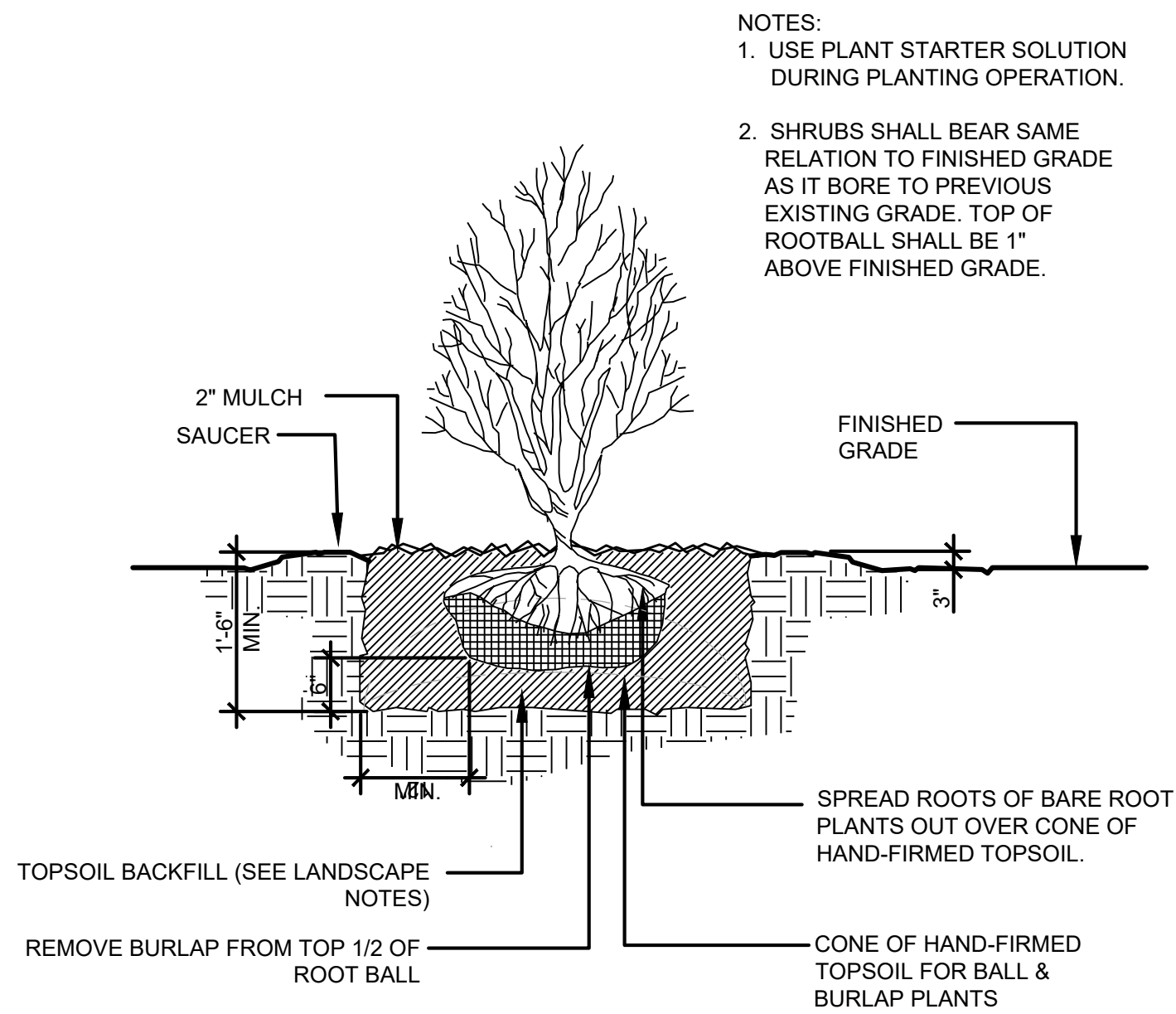

2 SHRUB PLANTING
 NOT TO SCALE

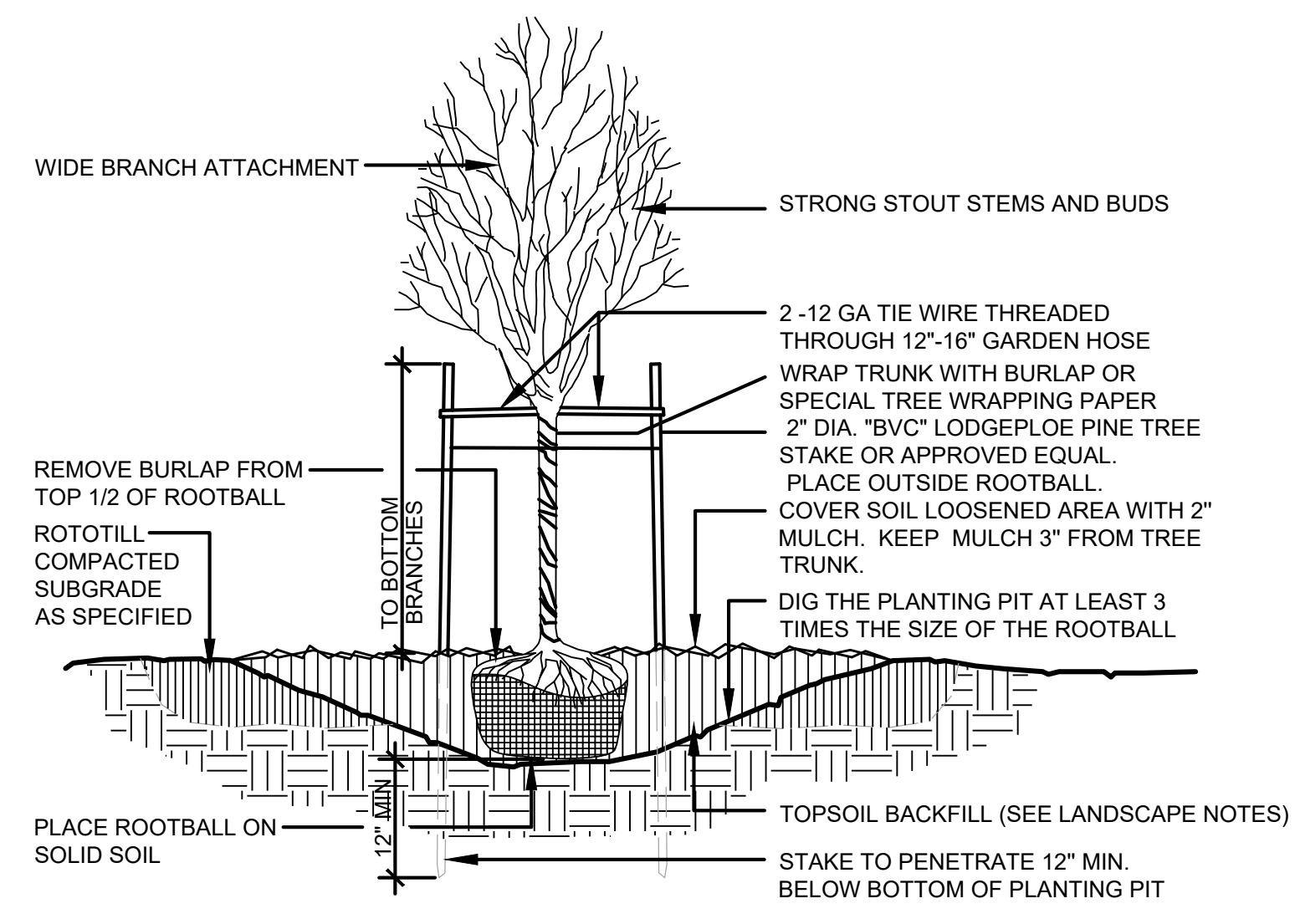

3 DECIDUOUS TREE PLANTING with STAKING
 NOT TO SCALE

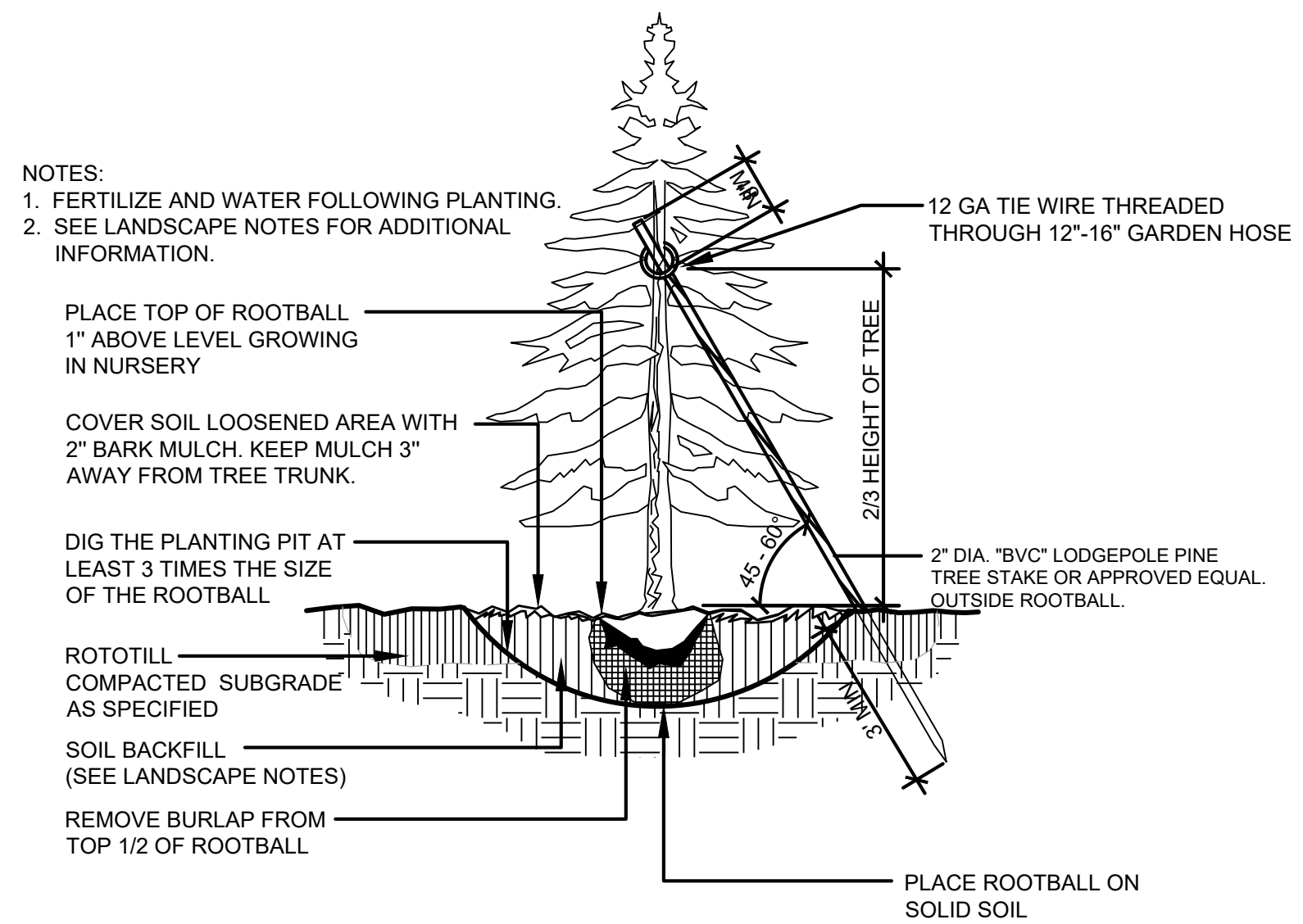

4 EVERGREEN TREE PLANTING with STAKING
 NOT TO SCALE

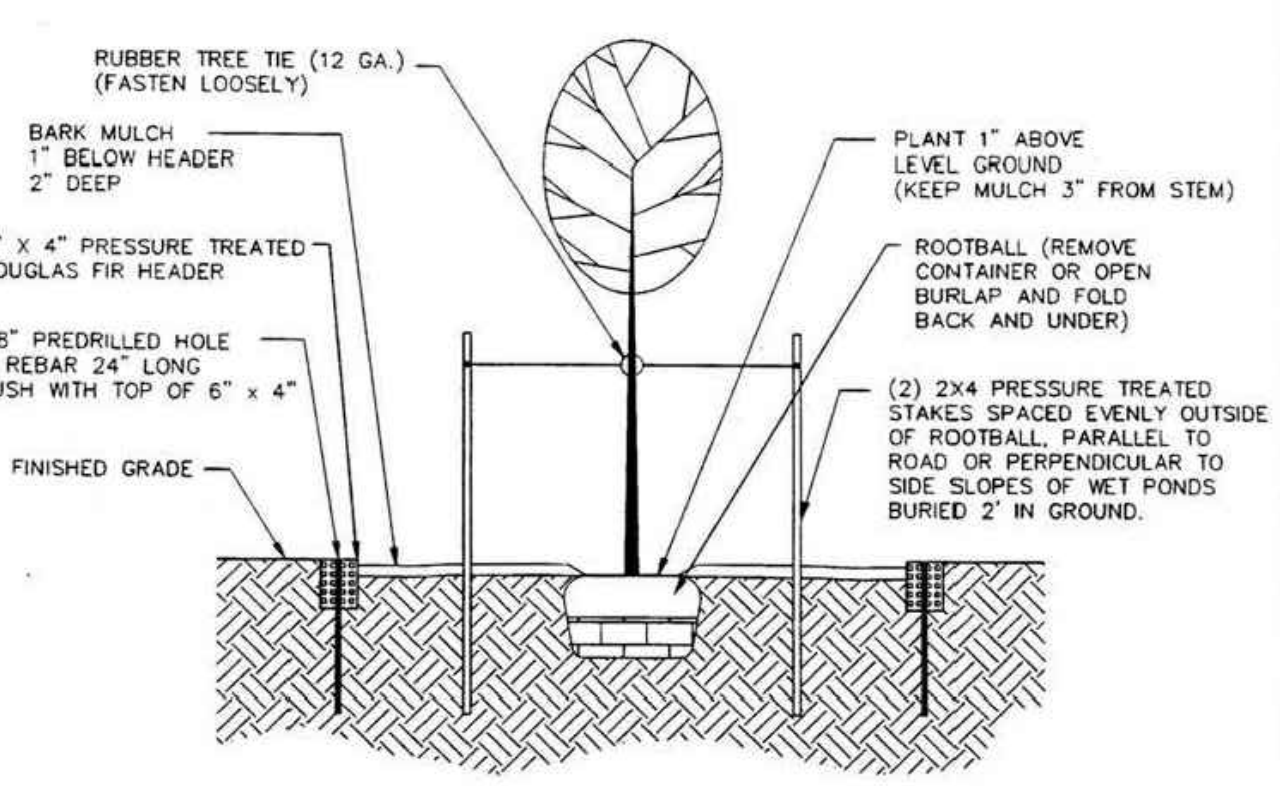
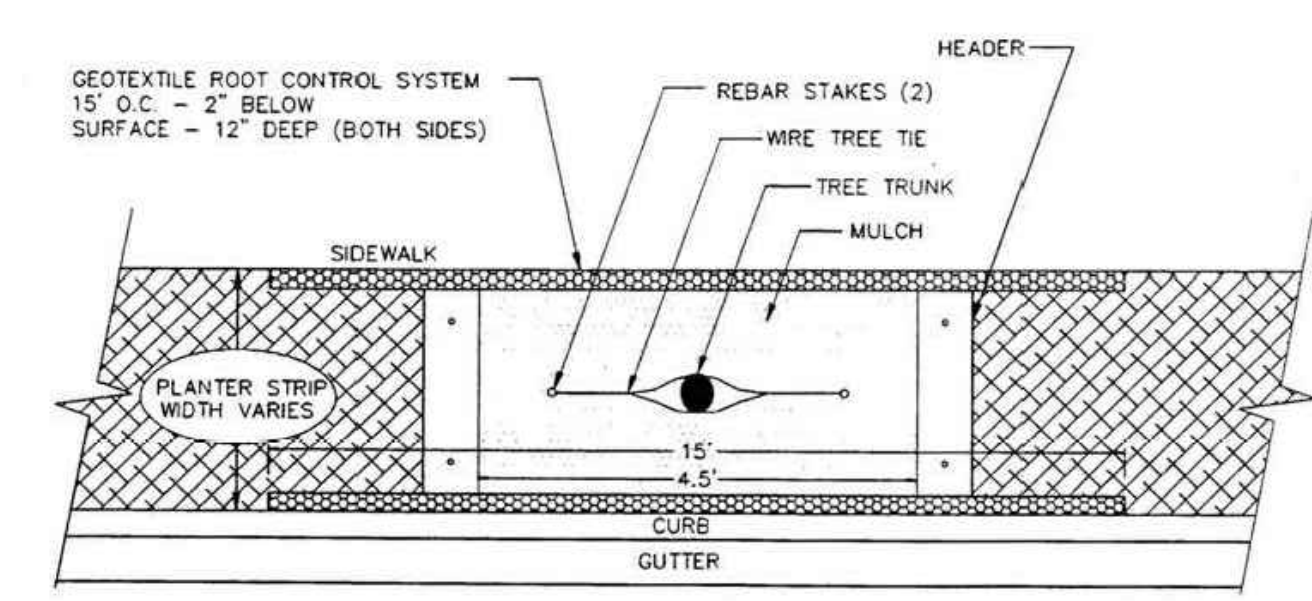

5 TREE PLANTER AND BARRIER DETAIL
 NOT TO SCALE

NOTES:
 1. THE GEOTEXTILE ROOT CONTROL SYSTEM SHALL BE 12 INCH BIOBARRIER STRIPS, OR CITY APPROVED EQUAL.