

2024 WATER ANNUAL VALVES

LACEY CONTRACT # PW 2022-30
SECTION 8, 11, 17, 23, 32, 33, AND 34, T18N, R1W, W.M.

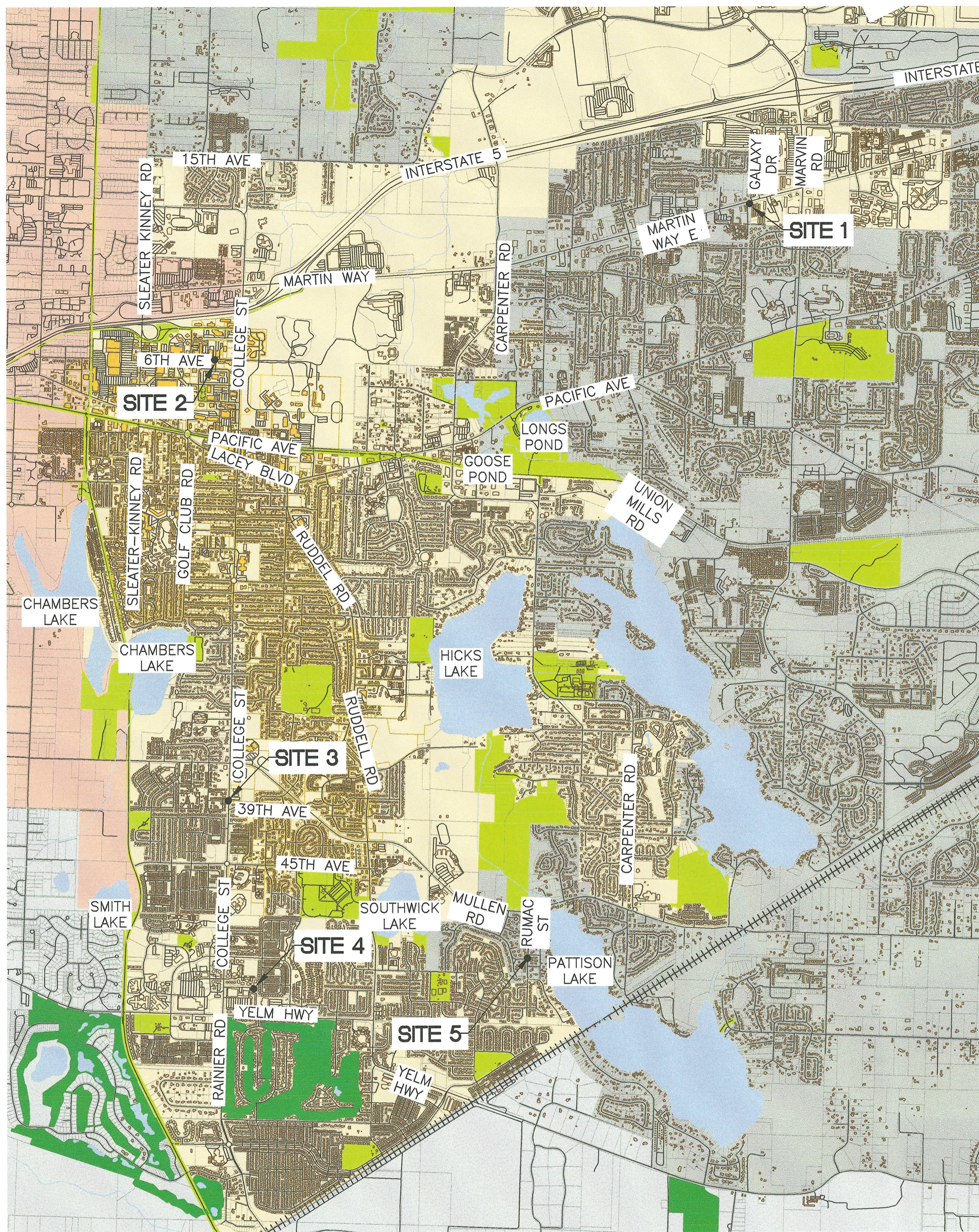

SHEET INDEX		
Sheet Title	Sheet Number	Sheet Title
CS	1	COVER SHEET
GN	2	GENERAL NOTES
WA1	3	WATER PLANS
DT1	4	DETAILS SHEET

LACEY CITY OFFICIALS

MAYOR: Andy Ryder
DEPUTY MAYOR: Malcom Miller
CITY COUNCIL: Lenny Greenstein
 Michael Steadman
 Carolyn Cox
 Robin Vazquez
 Nicolas Dunning
CITY MANAGER: Rick Walk
CITY ATTORNEY: David S. Schneider
CITY ENGINEER: Aubrey Collier, P.E., S.E.
DIRECTOR OF PUBLIC WORKS: Scott Egger, P.E.

Scott Egger
 DIRECTOR OF PUBLIC WORKS 6/5/24
 DATE

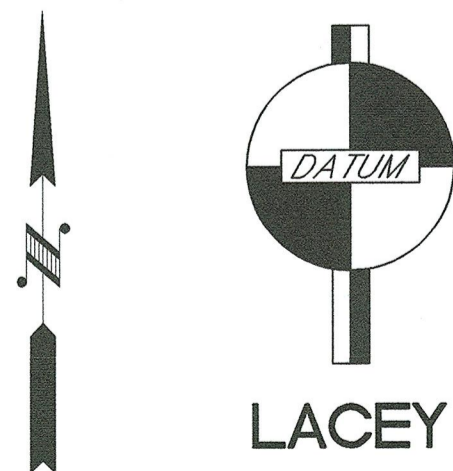

VICINITY MAP
CITY OF LACEY, WASHINGTON
SCALE : 1" = 2000'

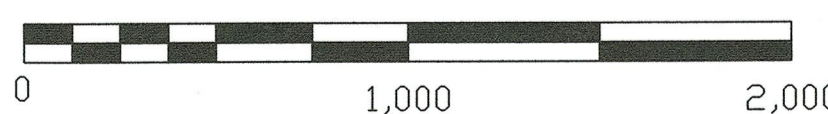

- LACEY CITY LIMITS
- OLYMPIA CITY LIMITS
- URBAN GROWTH AREA

CITY OF LACEY, WASHINGTON
DEPARTMENT OF PUBLIC WORKS
420 COLLEGE STREET SE
LACEY, WA 98503-1238 (360) 491-5600

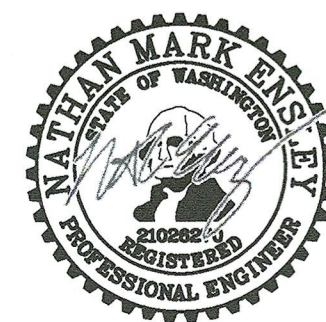
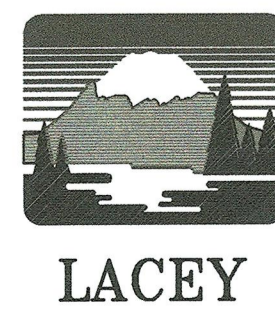

DESIGNED: NME
 DRAFTED: NME
 CHECKED: NME
 HORZ. SCALE:
 VERT. SCALE:
 FILE: WA24AV_CS

2024 WATER ANNUAL VALVES
COVER SHEET

REVISION BLOCK			PAGE NO.	SHEET NO.
NO.	DATE	DESCRIPTION	CS	1
			DWG NO.	OF
			D-24-08	4

BLOCK LEGEND:

PROPOSED	EXISTING
SURVEY MONUMENT	
CATCH BASIN TYPE 1	
STORM MANHOLE & CB TYPE 2	
FIRE HYDRANT	
AIR & VACUUM RELEASE VALVE	
WATER METER	
WATER VALVE	
REDUCER	
SPRINKLER HEAD	
SEWER MANHOLE	
SANITARY SEWER CLEAN OUT	
GAS VALVE	
SIGN	
POLE ANCHOR	
POWER TRANSFORMER	
POWER POLE	
POWER VAULT	
TRAFFIC LOOP	
TRAFFIC SIGNAL	
STANDARD TRAFFIC SIGNAL CONTROLLER	
STREET LIGHT	
JUNCTION BOX	
ELECTRICAL SERVICE	
CABLE TV PEDESTAL	
TELEPHONE MANHOLE	
TELEPHONE PEDESTAL	
TREE GRATE	
CONIFER TREE	
DECIDUOUS TREE	
COMMERCIAL SIGN	

LINETYPE LEGEND:

8+00	CONSTRUCTION BASELINE
	EASEMENT
	ROAD CENTERLINE
	BARB WIRE FENCE
	CHAIN LINK FENCE
	CONCRETE FENCE
	ROCK FENCE
	WIRE FENCE
	WOOD FENCE
	GRAVEL
	TOE OF SLOPE
	TOP OF SLOPE
	DITCH
	STORM (PAINTED)
	SEWER (PAINTED)
	NEW SEWER
	RIGHT OF WAY
	OVERHEAD CABLE
	UNDERGROUND CABLE (PAINTED)
	GAS (PAINTED)
	OVERHEAD PHONE
	OVERHEAD FIBER OPTIC
	UNDERGROUND PHONE (PAINTED)
	UNDERGROUND FIBER OPTIC (PAINTED)
	OVERHEAD ELECTRIC
	UNDERGROUND ELECTRIC (PAINTED)
	WATER (PAINTED)
	NEW WATER
	RECLAIMED WATER (PAINTED)
	ABANDON EXISTING UTILITY (SEE PLAN)

CONSTRUCTION HATCH TYPES:

	HOT MIX ASPHALT PATCH
	CONCRETE SIDEWALK

ABBREVIATIONS:

	DEFLECTION ANGLE
EP	EDGE OF PAVEMENT
RT	RIGHT
LT	LEFT
I.E.	INVERT ELEVATION
P.C.	POINT OF CURVATURE
P.I.	POINT OF INTERSECTION
P.T.	POINT OF TANGENCY
R.	RADIUS
R.P.	RADIUS POINT
R/W	RIGHT-OF-WAY
ROW	RIGHT-OF-WAY
EX.	EXISTING
EXIST.	EXISTING
STA	STATION
S/W	SIDEWALK
C.S.B.C.	CRUSHED SURFACING BASE COURSE
C.S.T.C.	CRUSHED SURFACING TOP COURSE
CL, \mathcal{C}	CENTERLINE
CB	CATCH BASIN
N/A	NOT APPLICABLE
A/C	ASPHALT CONCRETE
ACP	ASPHALT CONCRETE PAVEMENT
D.I.	DUCTILE IRON
SD	STORM DRAIN
SS	SANITARY SEWER
RPBA	REDUCED PRESSURE BACKFLOW ASSEMBLY
DIA, ϕ	DIAMETER
A.P.	ANGLE POINT
V.P.I.	VERTICAL POINT OF INTERSECTION
V.P.C.	VERTICAL POINT OF CURVATURE
V.P.T.	VERTICAL POINT OF TANGENCY
EL.	ELEVATION
S.Y.	SQUARE YARD
C.Y.	CUBIC YARD
TYP.	TYPICAL
LUM.	LUMINAIRE
L.F.	LINEAR FEET
RD.	ROAD
DR.	DRIVE
PKWY.	PARKWAY
CONST.	CONSTRUCTION
FT.	FOOT
D/W	DRIVEWAY
APPROX.	APPROXIMATELY
U.O.N.	UNLESS OTHERWISE NOTED

CHANNELIZATION NOTES:

- CONTRACTOR SHALL REFRESH ALL EXISTING STRIPING AS DIRECTED BY THE ENGINEER.
- WHERE NEW CHANNELIZATION IS BEING INSTALLED ON EXISTING PAVEMENT, CONTRACTOR SHALL PREPARE EXISTING ROADWAY SURFACE PRIOR TO INSTALLATION AS DIRECTED BY ENGINEER.
- CONTRACTOR SHALL REMOVE EXISTING STRIPING OUTSIDE THE PAVING LIMITS AS DIRECTED BY THE ENGINEER. ANY EXISTING THERMOPLASTIC LINES IN CONFLICT WITH THE PROPOSED CHANNELIZATION SHALL BE REMOVED PRIOR TO PLACING NEW CROSSWALK LINES AND/OR STOP BARS.
- FOR PROFILED PLASTIC LINE SEE WSDOT STANDARD PLAN M-20.20-01.

CONSTRUCTION NOTES:

- CALL 48 HOURS BEFORE YOU DIG 1-800-424-5555 OR 811.
- THE CONTRACTOR SHALL FIELD VERIFY UTILITY LOCATIONS PRIOR TO CONSTRUCTION.
- THE CONTRACTOR SHALL NOT REMOVE ANY TREES UNLESS INDICATED ON PLANS OR DIRECTED BY ENGINEER.
- THE CONTRACTOR SHALL MATCH OVERLAY TO EXISTING PAVEMENT AND DRIVEWAYS AS DIRECTED BY THE ENGINEER.
- GRINDING LIMITS AND PAVEMENT REPAIR LIMITS SHALL BE IDENTIFIED BY THE ENGINEER IN THE FIELD AND MAY VARY FROM THOSE SHOWN ON THE PLANS.
- THE CONTRACTOR SHALL VERIFY QUANTITIES OF VALVE BOX, CATCH BASINS, AND MANHOLE COVERS TO BE RAISED OR ADJUSTED PRIOR TO PAVING OPERATIONS.
- THE CONTRACTOR SHALL VERIFY VALVE BOX, CATCH BASIN, AND MANHOLE COVER DIMENSIONS AS WELL AS REQUIRED ADJUSTMENT HEIGHTS OF THE PAVING RISERS TO MATCH FINAL OVERLAY GRADES.
- THE CONTRACTOR SHALL RESTORE ALL LANDSCAPING TO EQUAL OR BETTER THAN ORIGINAL CONDITIONS AS DIRECTED BY THE ENGINEER.
- THE CONTRACTOR SHALL PROTECT ALL EXISTING SURVEY MONUMENTS AND PROPERTY CORNERS. THE CONTRACTOR SHALL BE RESPONSIBLE FOR ALL COSTS ASSOCIATED WITH RESTORING MONUMENTS OR PROPERTY CORNERS OUTSIDE OF THE CONSTRUCTION LIMITS.
- ALL PAVEMENT REPAIR EXCAVATION AND DIGOUTS SHALL BE COMPLETED PRIOR TO PAVEMENT PLANING.
- PAVEMENT REPAIR AREAS MAY REQUIRE EXTRA EXCAVATION AS DIRECTED BY THE ENGINEER.

EROSION CONTROL NOTE:

CONTRACTOR IS RESPONSIBLE FOR ESTABLISHING MAINTAINING EROSION CONTROL BMP'S IN ACCORDANCE WITH DEPARTMENT OF ECOLOGY REQUIREMENTS WHERE APPLICABLE TO MITIGATE SEDIMENT-LADEN RUNOFF FROM LEAVING THE WORK AREAS. REFER TO SECTION 8-01 OF THE PROJECT SPECIFICATIONS FOR INFORMATION RELATED TO WORK DESCRIPTION AND PAYMENT.

REVISION BLOCK		
NO.	DATE	DESCRIPTION

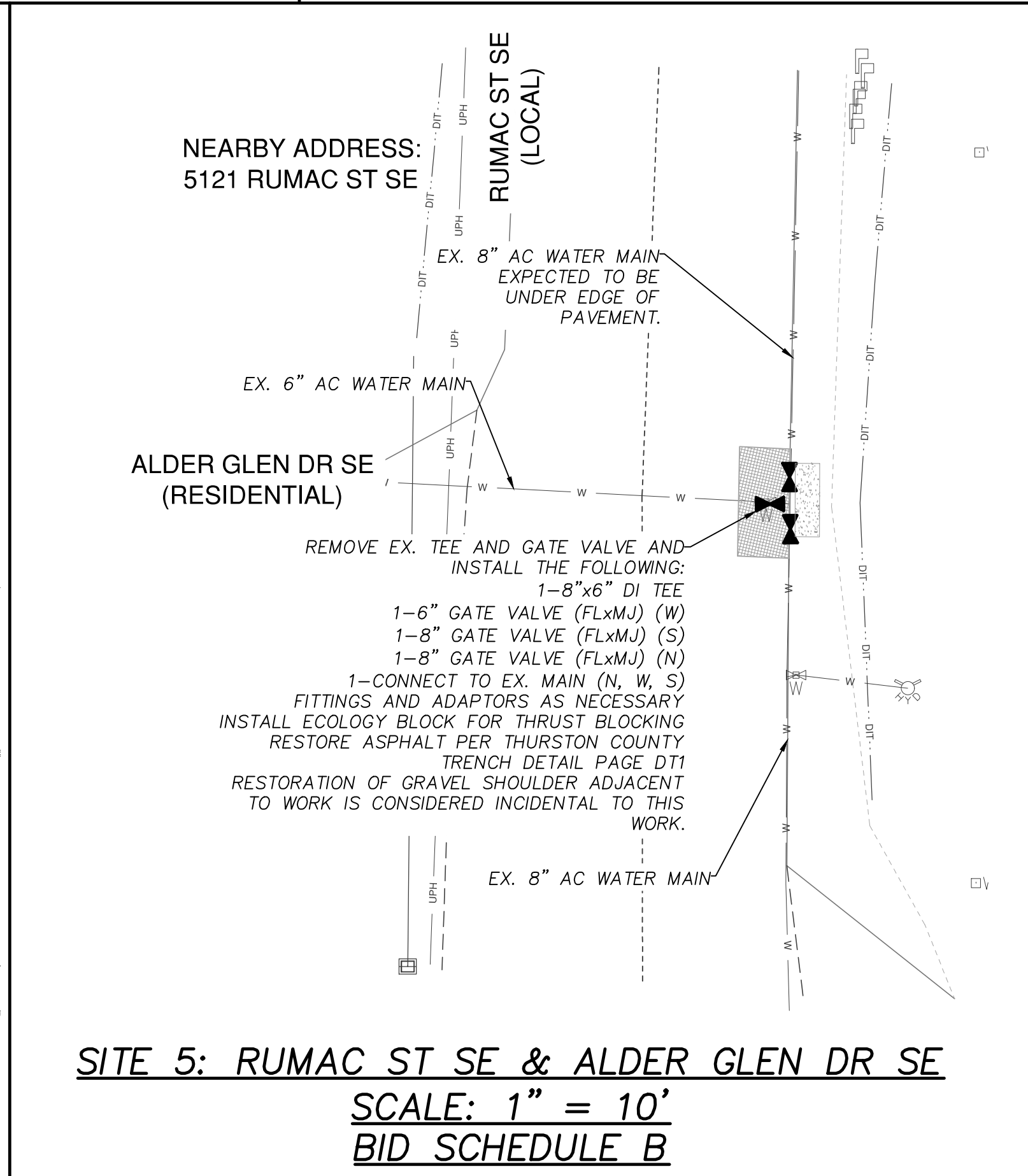
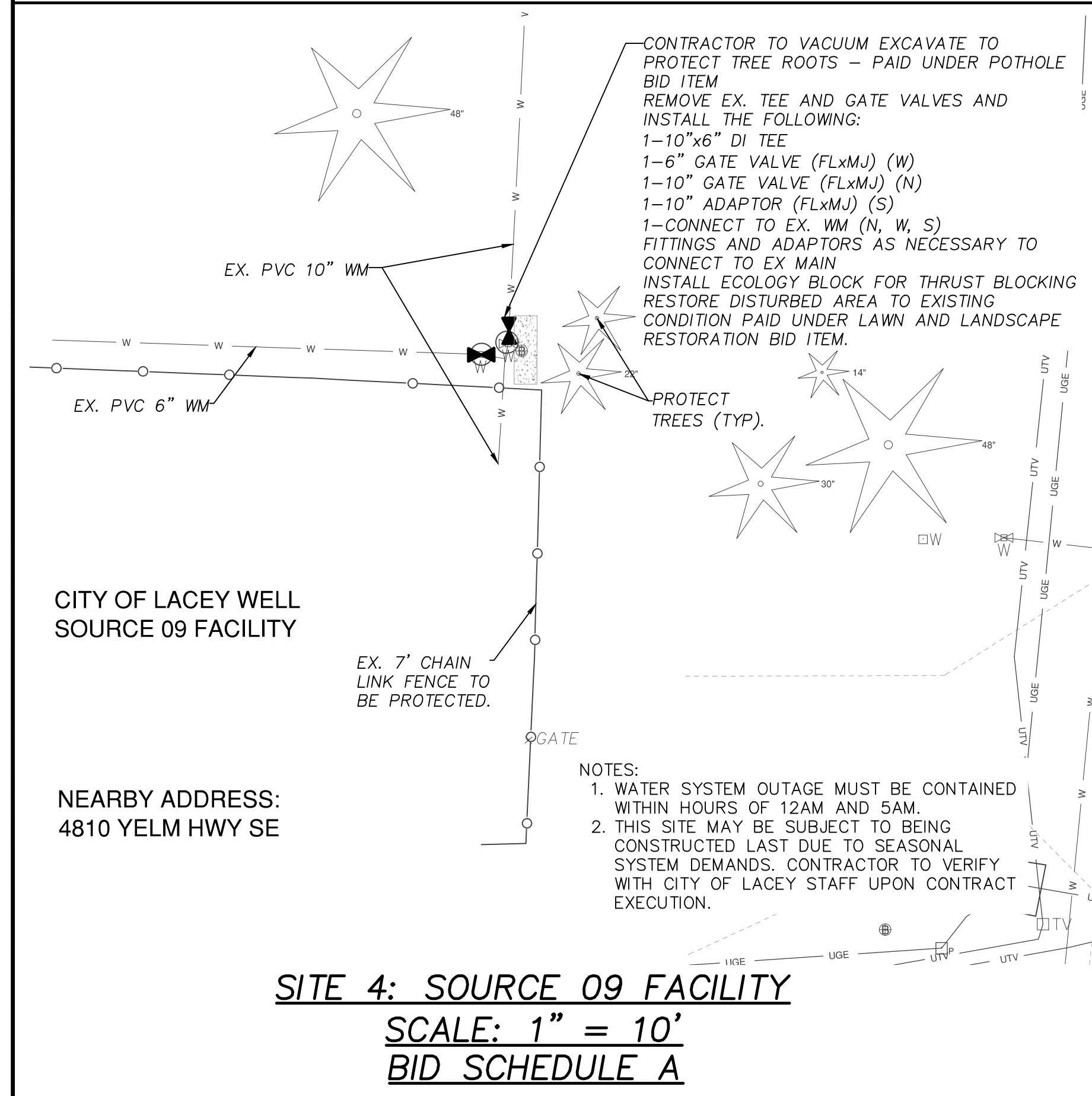
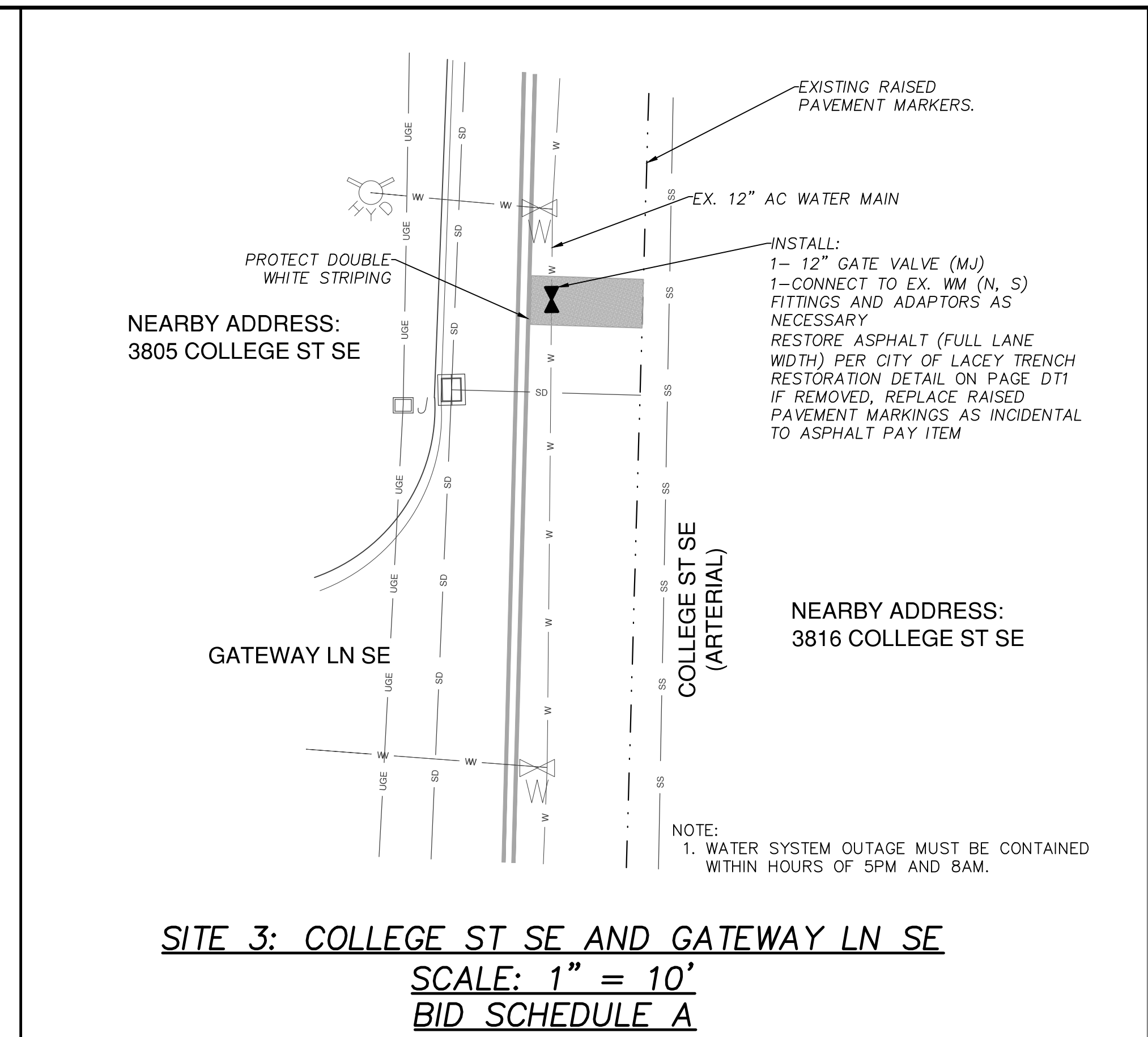
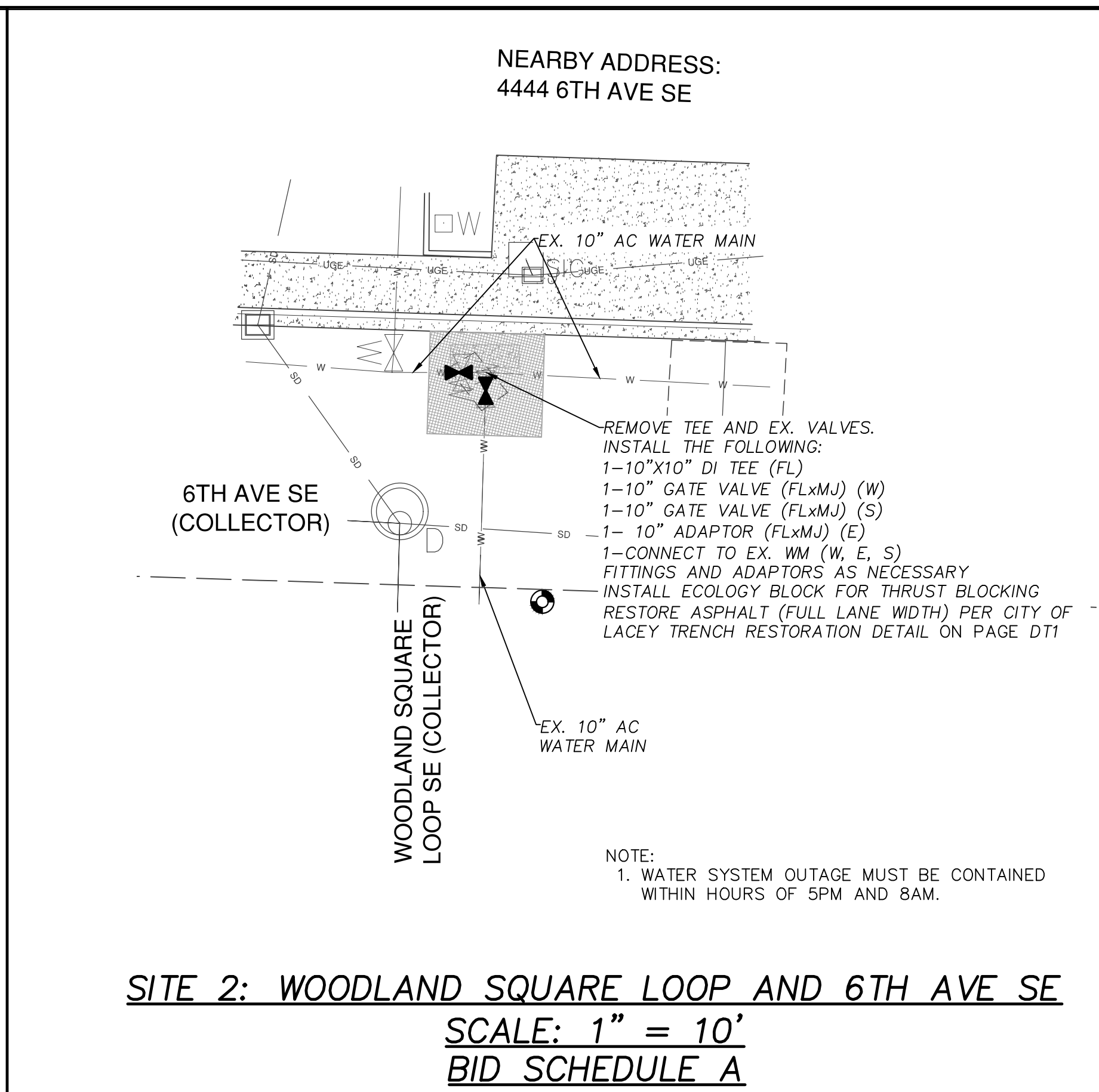
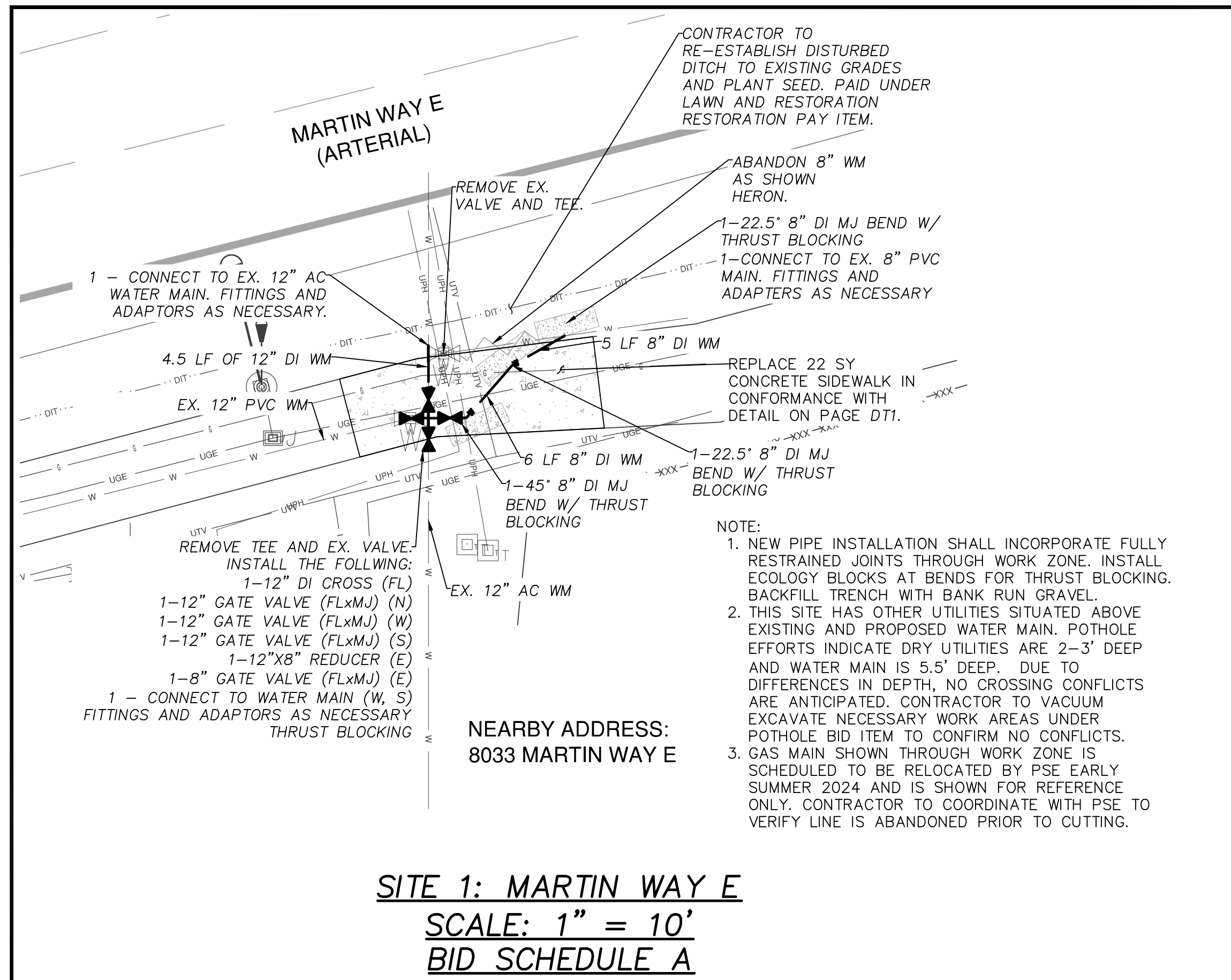

SCALE: 1"=10'

CITY OF LACEY COORDINATE SYSTEM

WATER GENERAL NOTES:

1. EXISTING PIPE SHALL BE EXPOSED AT EACH CONNECTION POINT TO VERIFY FITTINGS AND ADAPTORS REQUIRED A MINIMUM OF 72 HOURS PRIOR TO DISTRIBUTING SHUTDOWN NOTICES. ALL FITTINGS REQUIRED TO COMPLETE THE CONNECTION SHALL BE ONSITE PRIOR TO SHUTDOWN.
2. THE CONTRACTOR SHALL POT HOLE ALL UTILITY CROSSING CONFLICTS. THE CONTRACTOR SHALL INFORM THE ENGINEER OF ALL CONFLICTS WITH THE PROPOSED PIPE PRIOR TO PIPE INSTALLATION.
3. UNLESS OTHERWISE NOTED ON PLAN OR DIRECTED BY THE ENGINEER ALL NEW WATER MAIN SHALL HAVE A MINIMUM OF 42" OF COVER.

EROSION CONTROL NOTE:

CONTRACTOR IS RESPONSIBLE FOR ESTABLISHING MAINTAINING EROSION CONTROL BMP'S IN ACCORDANCE WITH CITY OF LACEY AND DEPARTMENT OF ECOLOGY REQUIREMENTS WHERE APPLICABLE TO MITIGATE SEDIMENT-LADEN RUNOFF FROM LEAVING THE WORK AREAS. REFER TO SECTION 8-01 OF THE PROJECT SPECIFICATIONS FOR INFORMATION RELATED TO WORK DESCRIPTION AND PAYMENT. IF THE CITY INSPECTOR OR ENGINEER REQUIRES SITE-SPECIFIC BMP'S NOT SPECIFICALLY CALLED OUT, THIS WILL BE PAID UNDER THE EROSION CONTROL PAY ITEM.

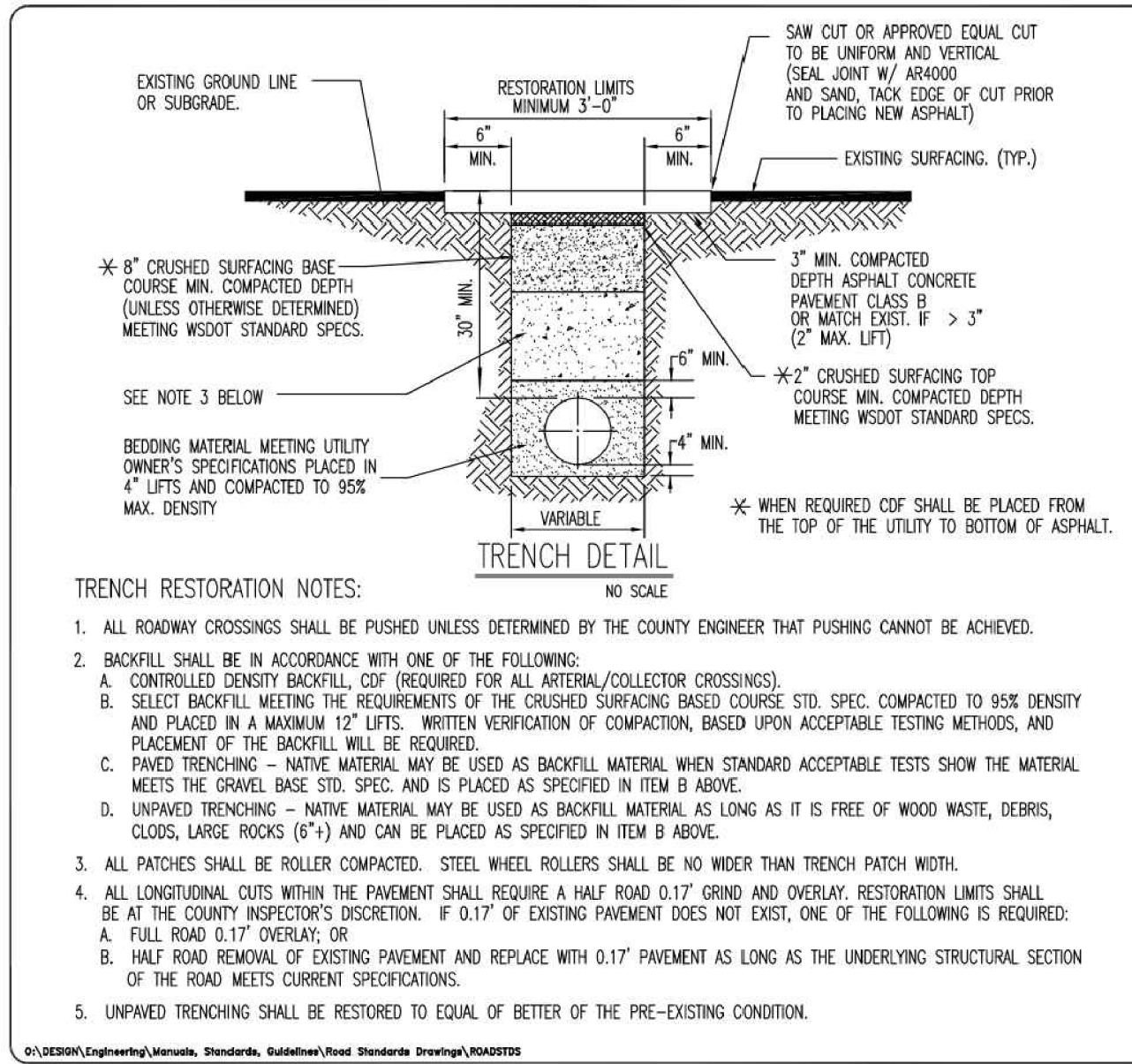

LAST REVISED 12/2019

THURSTON COUNTY
DEPARTMENT OF PUBLIC WORKS

THURSTON COUNTY
PUBLIC WORKS

DEVELOPMENT
REVIEW

ROADWAY
STANDARDS

UTILITY
TRENCH
DETAIL

APPENDIX 12 - A

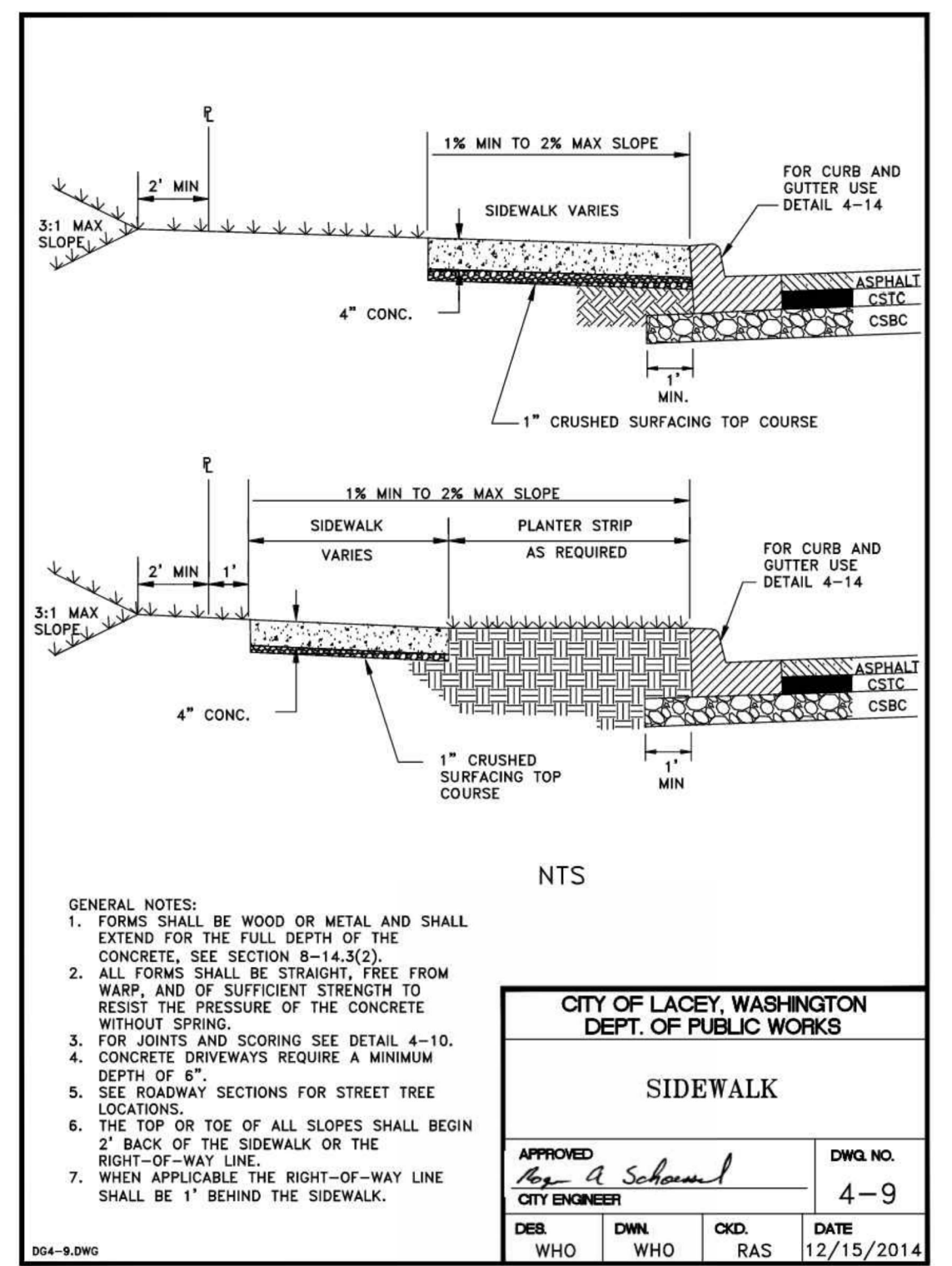
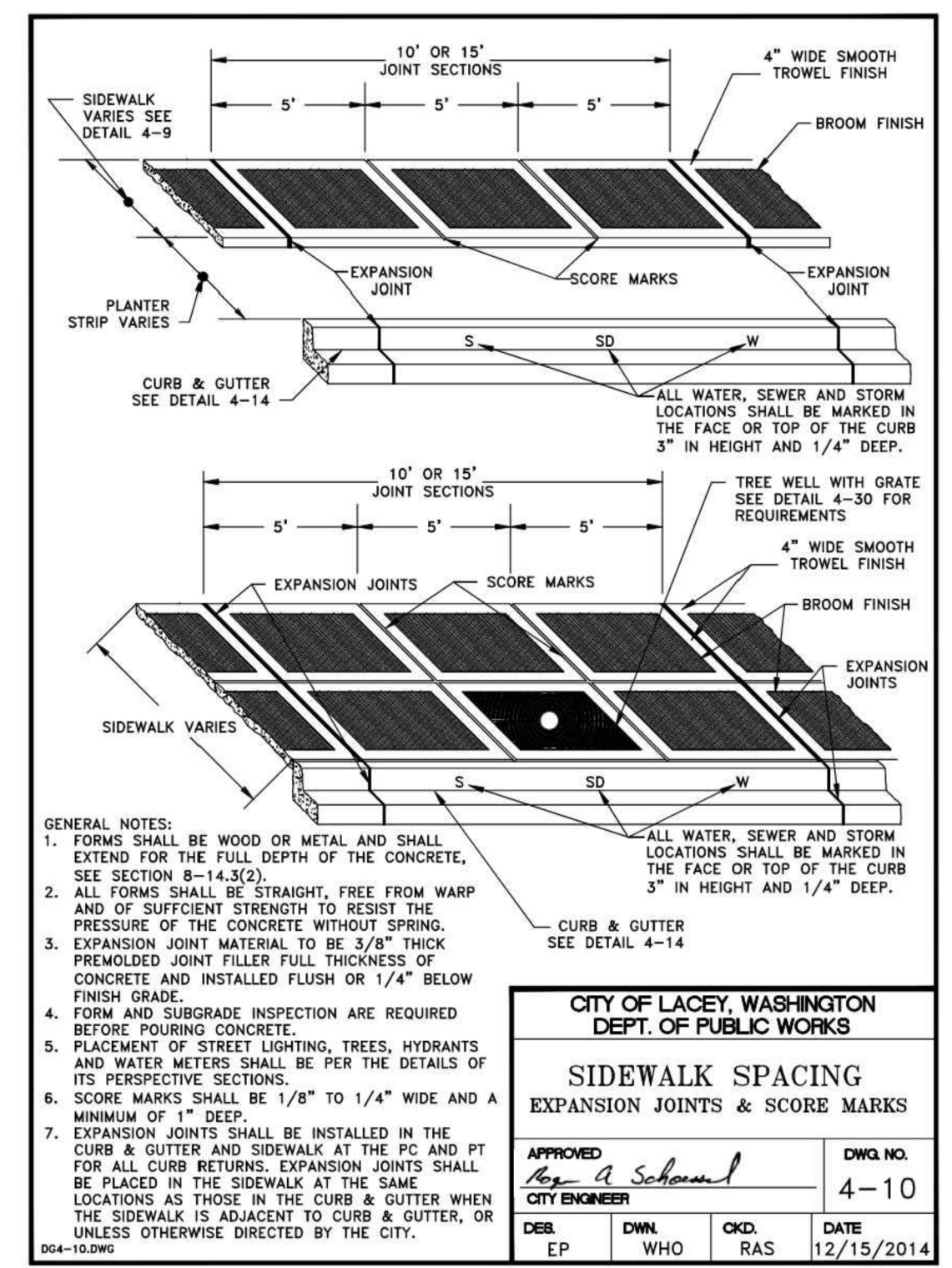
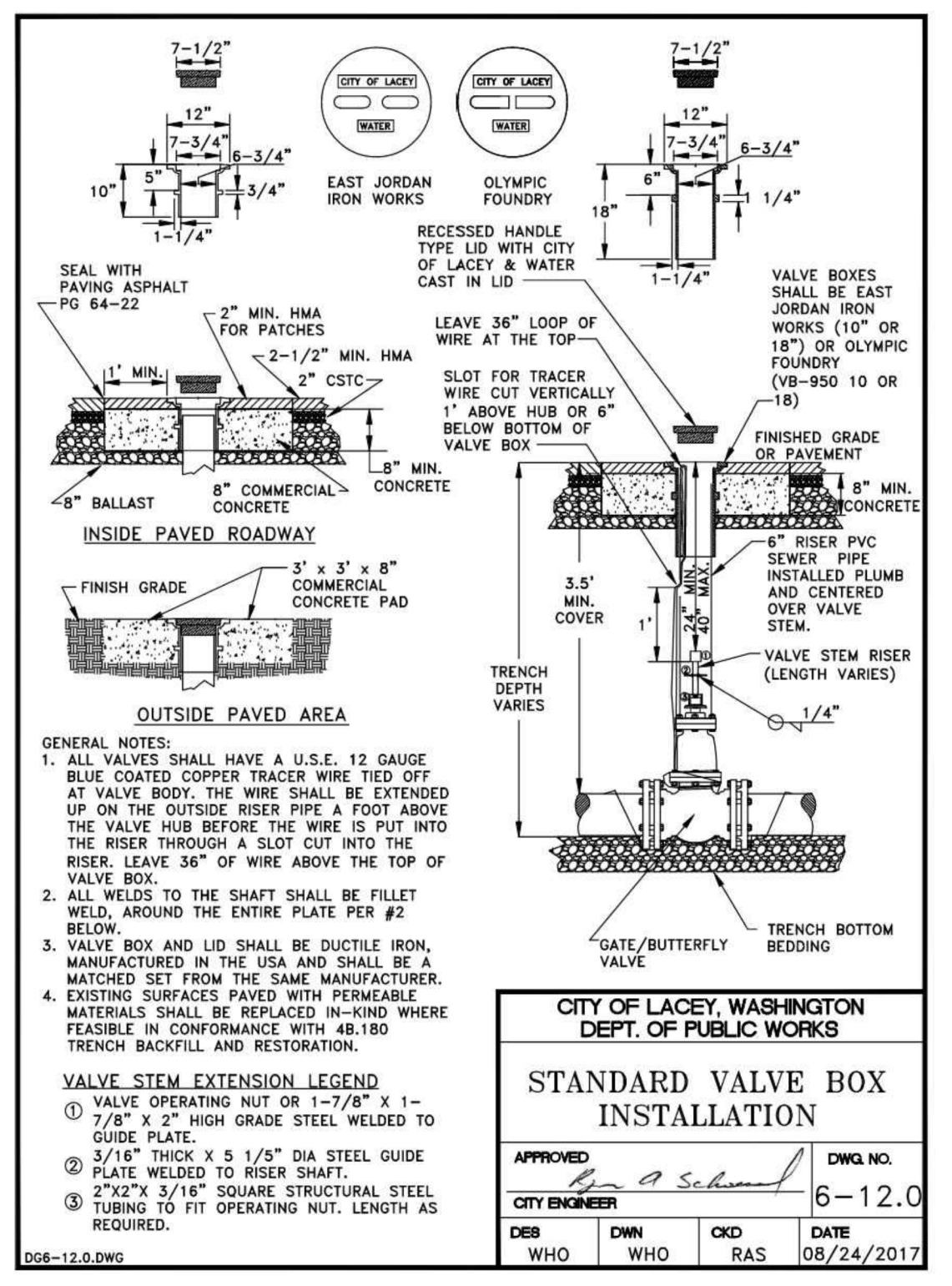
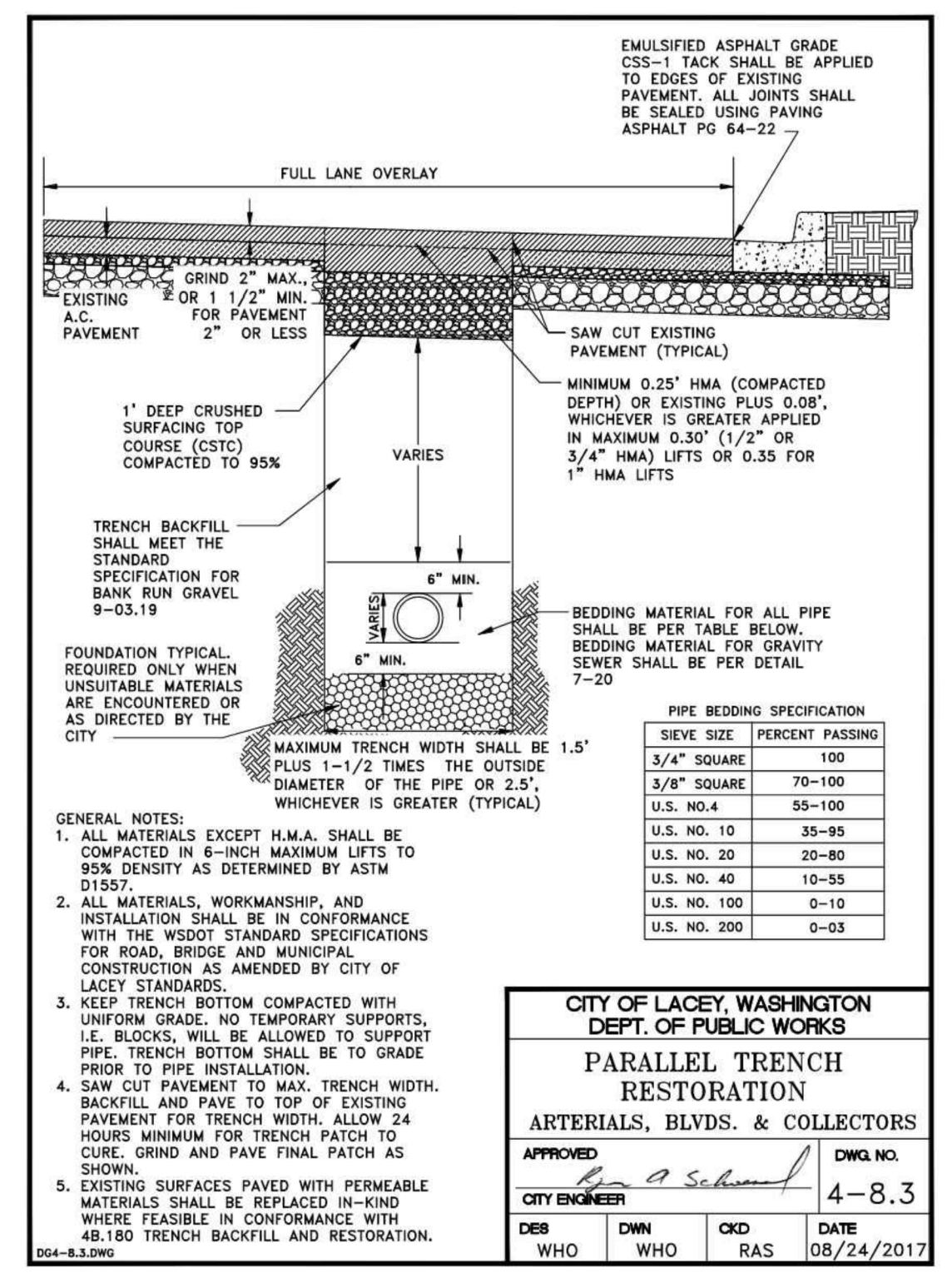
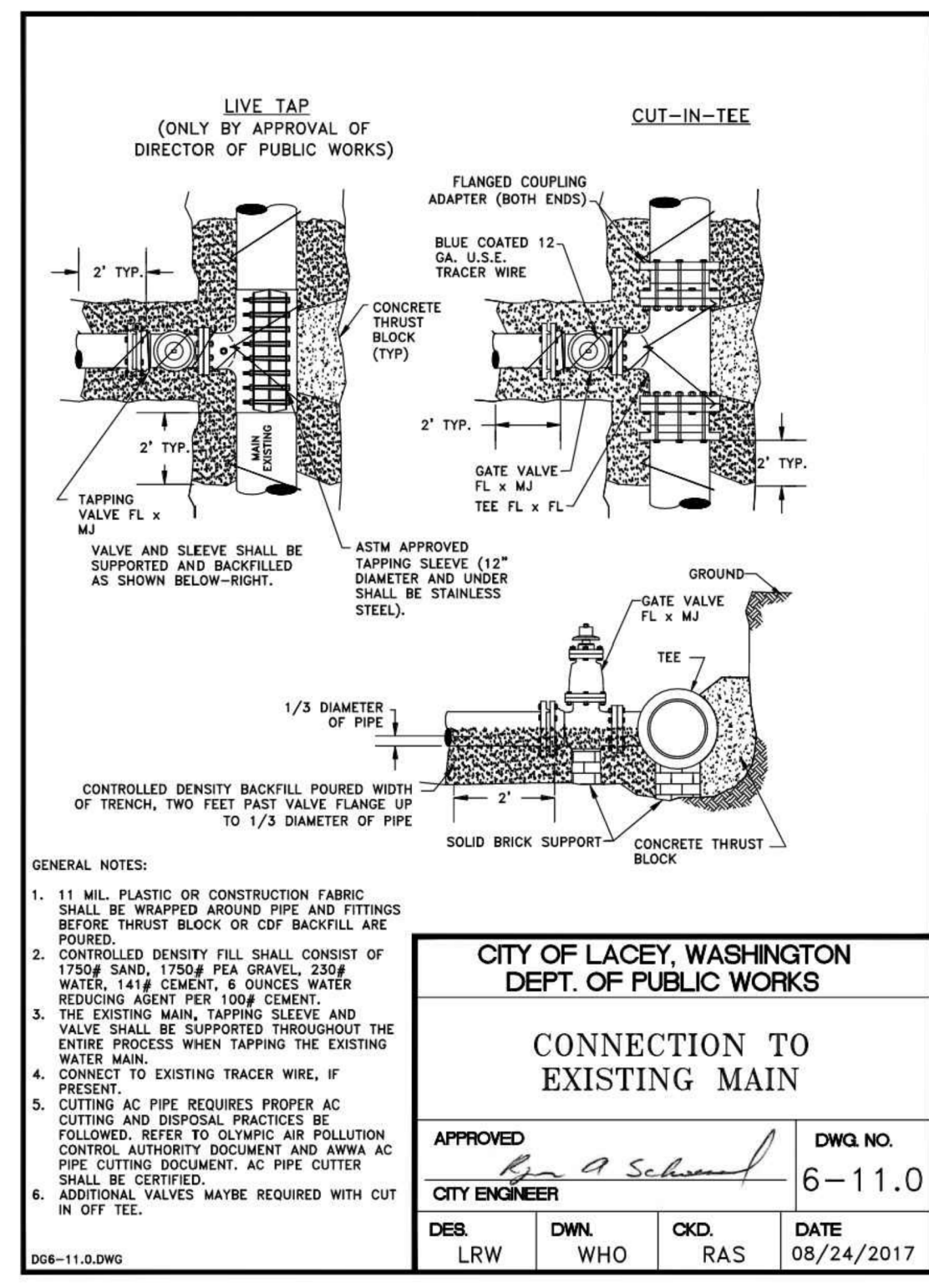

CITY OF LACEY, WASHINGTON
DEPARTMENT OF PUBLIC WORKS
420 COLLEGE STREET SE
LACEY, WA 98503-1238 (360) 491-5600



DESIGNED: NME
DRAFTED: NME
CHECKED: NME
HORZ. SCALE: 1"=10'
VERT. SCALE:
FILE: WA24AV_UT

**2024 WATER ANNUAL VALVES
DETAILS SHEET**

REVISION BLOCK			PAGE NO.	SHEET NO.
NO.	DATE	DESCRIPTION		
			DT1	4
			DWG NO.	OF
			D-24-08	4