

8TH AVENUE REHABILITATION

LACEY CONTRACT # PW 2025-01
SECTION 17, T18N, R1W

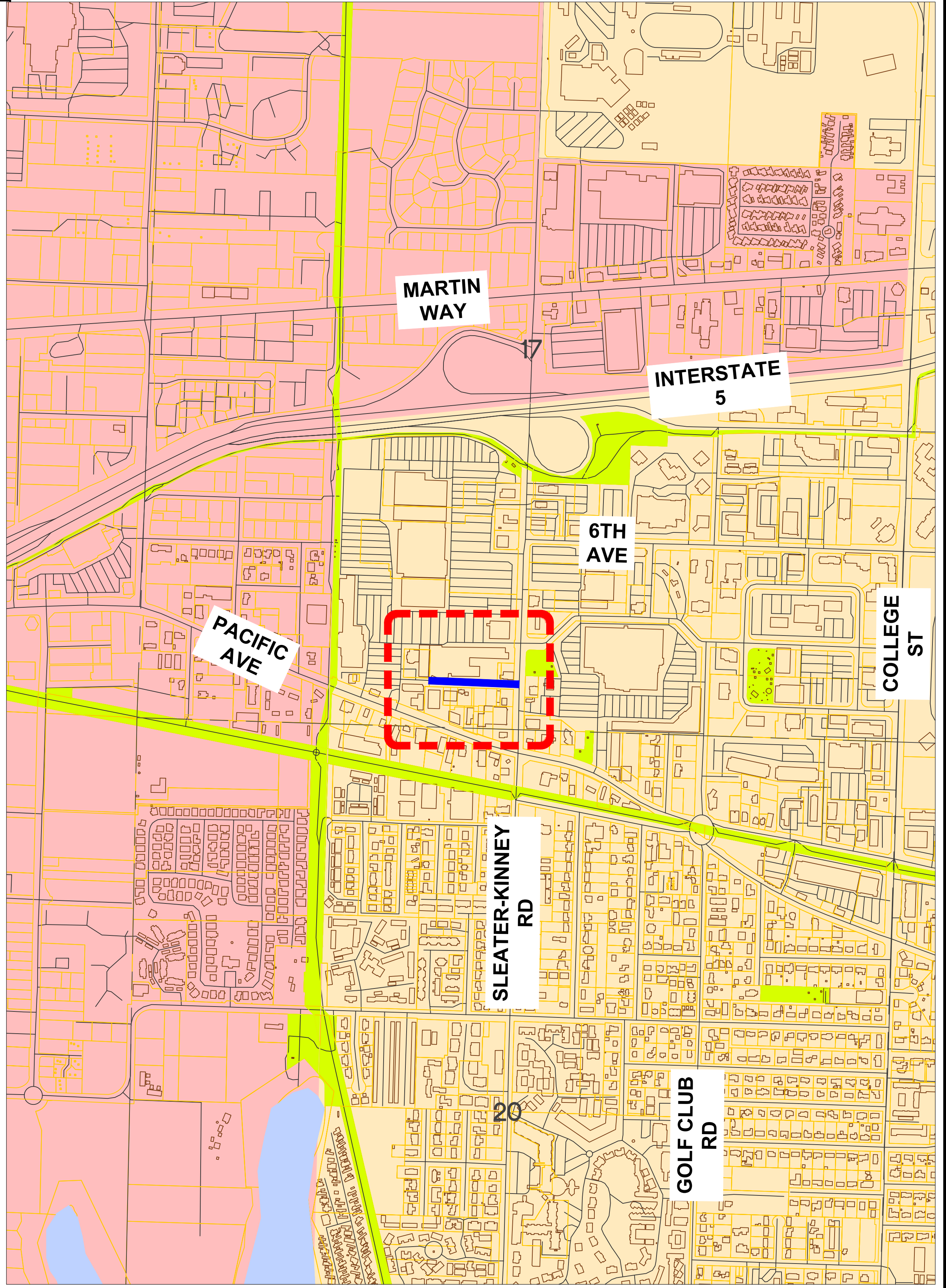

LACEY CITY OFFICIALS

MAYOR: Andy Ryder
DEPUTY MAYOR: Malcolm Miller
CITY COUNCIL: Lenny Greenstein
 Michael Steadman
 Carolyn Cox
 Robin Vazquez
 Nicholas Dunning
CITY MANAGER: Rick Walk
CITY ATTORNEY: David S. Schneider
CITY ENGINEER: Aubrey Collier, P.E., S.E.
DIRECTOR OF PUBLIC WORKS: Scott Egger, P.E.

SHEET INDEX

PAGE NO.	SHEET NO.	DESCRIPTION
1	CS	COVER SHEET
2	GN	GENERAL NOTES, LEGENDS & ABBREVIATIONS
3	XS1	TYPICAL CROSS SECTIONS
4	SD1	STORM DRAINAGE PLAN
5	SP1	SITE PREPARATION PLAN
6	P1	PAVING PLAN
7	CH1	CHANNELIZATION PLAN
8-9	DT1-2	CONSTRUCTION DETAILS

SA GM 2/28/25
 PUBLIC WORKS DIRECTOR DATE

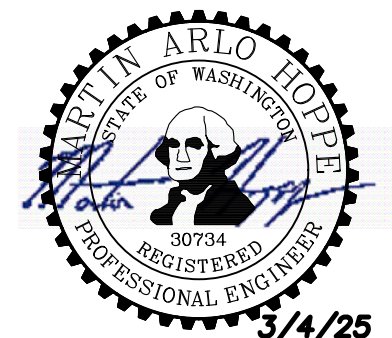

Lacey Dwg. Number :
D-25-01

VICINITY MAP
CITY OF LACEY, WASHINGTON
SCALE : 1" = 500'

- LACEY CITY LIMITS
- OLYMPIA CITY LIMITS
- URBAN GROWTH AREA

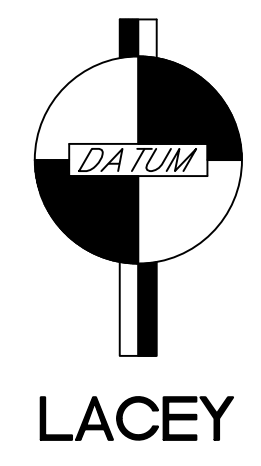

LACEY

BLOCK LEGEND:

SURVEY MONUMENT	
CATCH BASIN TYPE 1	
STORM MANHOLE & CB TYPE 2	
FIRE HYDRANT	
AIR & VACUUM RELEASE VALVE	
WATER METER	
WATER VALVE	
REDUCER	
SPRINKLER HEAD	
SEWER MANHOLE	
SANITARY SEWER CLEAN OUT	
GAS VALVE	
SIGN	
POLE ANCHOR	
POWER TRANSFORMER	
POWER POLE	
POWER VAULT	
TRAFFIC LOOP	
TRAFFIC SIGNAL	
STANDARD TRAFFIC SIGNAL CONTROLLER	
STREET LIGHT	
JUNCTION BOX	
ELECTRICAL SERVICE	
CABLE TV PEDESTAL	
TELEPHONE MANHOLE	
TELEPHONE PEDESTAL	
TREE GRATE	
CONIFER TREE	
DECIDUOUS TREE	
COMMERCIAL SIGN	

LINETYPE LEGEND:

	CONSTRUCTION BASELINE
	EASEMENT
	ROAD CENTERLINE
	BARB WIRE FENCE
	CHAIN LINK FENCE
	CONCRETE FENCE
	ROCK FENCE
	WIRE FENCE
	WOOD FENCE
	GRAVEL
	TOE OF SLOPE
	TOP OF SLOPE
	DITCH
	STORM (PAINTED)
	NEW STORM
	SEWER (PAINTED)
	NEW SEWER
	RIGHT OF WAY
	OVERHEAD CABLE
	UNDERGROUND CABLE (PAINTED)
	GAS (PAINTED)
	OVERHEAD PHONE
	OVERHEAD FIBER OPTIC
	UNDERGROUND PHONE
	UNDERGROUND FIBER OPTIC (PAINTED)
	OVERHEAD ELECTRIC
	UNDERGROUND ELECTRIC (PAINTED)
	WATER (PAINTED)
	NEW WATER
	RECLAIMED WATER (PAINTED)
	ABANDON EXISTING UTILITY

ABBREVIATIONS:

Δ	DEFLECTION ANGLE	C.S.T.C.	CRUSHED SURFACING TOP COURSE	C.Y.	CUBIC YARD
EP	EDGE OF PAVEMENT	CL, C	CENTERLINE	TYP.	TYPICAL
RT	RIGHT	CB	CATCH BASIN	LUM.	LUMINAIRE
LT	LEFT	N/A	NOT APPLICABLE	L.F.	LINEAR FEET
I.E.	INVERT ELEVATION	A/C	ASPHALT CONCRETE	RD.	ROAD
P.C.	POINT OF CURVATURE	ACP	ASPHALT CONCRETE PAVEMENT	DR.	DRIVE
P.I.	POINT OF INTERSECTION	D.I.	DUCTILE IRON	PKWY.	PARKWAY
P.T.	POINT OF TANGENCY	SD	STORM DRAIN	CONST.	CONSTRUCTION
R.	RADIUS	SS	SANITARY SEWER	FT.	FOOT
R.P.	RADIUS POINT	RPBA	REDUCED PRESSURE BACKFLOW ASSEMBLY	D/W	DRIVEWAY
R/W	RIGHT-OF-WAY	DIA, Ø	DIAMETER	APPROX.	APPROXIMATELY
ROW	RIGHT-OF-WAY	A.P.	ANGLE POINT	U.O.N.	UNLESS OTHERWISE NOTED
EX.	EXISTING	V.P.I.	VERTICAL POINT OF INTERSECTION	TBOC	TOP BACK OF CURB
EXIST.	EXISTING	V.P.C.	VERTICAL POINT OF CURVATURE	FL	FLOW LINE
STA	STATION	V.P.T.	VERTICAL POINT OF TANGENCY	LND	LANDING
S/W	SIDEWALK	EL.	ELEVATION	FOW	FRONT OF WALK
C.S.B.C.	CRUSHED SURFACING BASE COURSE	S.Y.	SQUARE YARD	BOW	BACK OF WALK

CONSTRUCTION NOTES:

- DRAWING SCALES VARY, REFERENCE DRAWING SCALES IN THE SHEET LEGEND OR TITLE BLOCK TO VERIFY SCALE
- CALL 48 HOURS BEFORE YOU DIG 1-800-424-5555 OR 811.
- THE CONTRACTOR SHALL FIELD VERIFY UTILITY LOCATIONS PRIOR TO CONSTRUCTION.
- THE CONTRACTOR SHALL NOT REMOVE ANY TREES UNLESS INDICATED ON PLANS OR DIRECTED BY ENGINEER.
- THE CONTRACTOR SHALL MATCH OVERLAY TO EXISTING PAVEMENT AND DRIVEWAYS AS DIRECTED BY THE ENGINEER.
- GRINDING LIMITS AND PAVEMENT REPAIR LIMITS SHALL BE IDENTIFIED BY THE ENGINEER IN THE FIELD AND MAY VARY FROM THOSE SHOWN ON THE PLANS.
- THE CONTRACTOR SHALL RESTORE ALL LANDSCAPING TO EQUAL OR BETTER THAN ORIGINAL CONDITIONS AS DIRECTED BY THE ENGINEER.
- THE CONTRACTOR SHALL PROTECT ALL EXISTING SURVEY MONUMENTS AND PROPERTY CORNERS. THE CONTRACTOR SHALL BE RESPONSIBLE FOR ALL COSTS ASSOCIATED WITH RESTORING MONUMENTS OR PROPERTY CORNERS OUTSIDE OF THE CONSTRUCTION LIMITS.

BASIS OF BEARING

MERIDIAN IS WASHINGTON COORDINATE SYSTEM OF 1983/91 - SOUTH ZONE DERIVED FROM TIES TO HPGN STATIONS SANDERSON, MCKENNA AND CBL1110 AND TO WSDOT GPS STATIONS G259R, GP34005-2, GP34005-4, GP34101-32, GP34101-39, HC34-2, LUHR RM2, TS34-33, TS34-59 AND TO THURSTON COUNTY GPS STATIONS U-531, AT-194, AT-352, AT-355, AT-447, AT449 AND AT-478. DISTANCES SHOWN ARE GROUND SCALE U.S. SURVEY FEET. COMBINED SCALE FACTOR (GROUND TO GRID) IS 0.999935701. SURVEY AF# 3111152 DATED 09-24-1997.

VERTICAL

THE CITY OF LACEY BENCHMARKS ARE BASED ON NGVD 29 DATUM FROM PRIMARY CONTROL ESTABLISHED BY FEDERAL AND STATE AGENCIES TO FIRST OR SECOND ORDER ACCURACY. THE CITY OF LACEY'S BENCHMARKS ARE GENERALLY TO THIRD ORDER ACCURACY.

BENCHMARK

CITY OF LACEY BM#645
CITY OF LACEY 2" SURFACE MONUMENT AT THE INTERSECTION OF SLEATER-KINNEY & 12TH AVE SE ELEV.=202.68

SOURCE OF CONTOURS

COMPILE FIELD MEASUREMENTS USING AUTOCAD CIVIL 3D-2023

SOURCE OF UTILITY MARKINGS

NO LOCATES NEEDED FOR THIS PROJECT
ALL UNDERGROUND UTILITY LOCATIONS IN THE PLANSET ARE APPROXIMATE. AS-BUILT DRAWINGS WERE UTILIZED TO SUPERIMPOSE UTILITY LOCATIONS. THESE LOCATIONS WERE DRAWN BY THE DESIGN ENGINEER AND ARE SUBJECT TO ERROR.

LIMITATION OF USE

THIS IS NOT A BOUNDARY SURVEY.

FIELD SURVEYOR & FIELD BOOK

SURVEYORS J. PERRYMAN & FB 310

METHOD OF SURVEY

SURVEY PERFORMED BY CONVENTIONAL FIELD TRAVERSE USING A LEICA TS-16 (THREE SECOND TOTAL STATION), LINEAR AND ANGULAR CLOSURE OF THE TRAVERSE MEET THE STANDARDS OF WAC 332-130-090.

BOUNDARY

THE BOUNDARY WAS COMPILED USING PHYSICAL FEATURES TIED IN THE FIELD AND DOCUMENTS OF RECORD AS SHOWN BELOW.

BLA REFERENCED
AF# 3309033, 3877993, 4906476

DEED REFERENCED
AF#4951461

CONSTRUCTION HATCH TYPES:

	ROADWAY EXCAVATION
	3.5" FIBER REINFORCED CL 1/2" PG 58H-22 HMA CROWNED SECTION
	3.5" FIBER REINFORCED CL 1/2" PG 58H-22 HMA NON-CROWNED SECTION
	CEMENT CONCRETE VALLEY GUTTER
	TRENCH RESTORATION HMA FOR PAVEMENT REPAIR CL 1/2" PG 58H-22 HMA
	COMMERCIAL HMA FOR APPROACHES

REVISION BLOCK		
NO.	DATE	DESCRIPTION

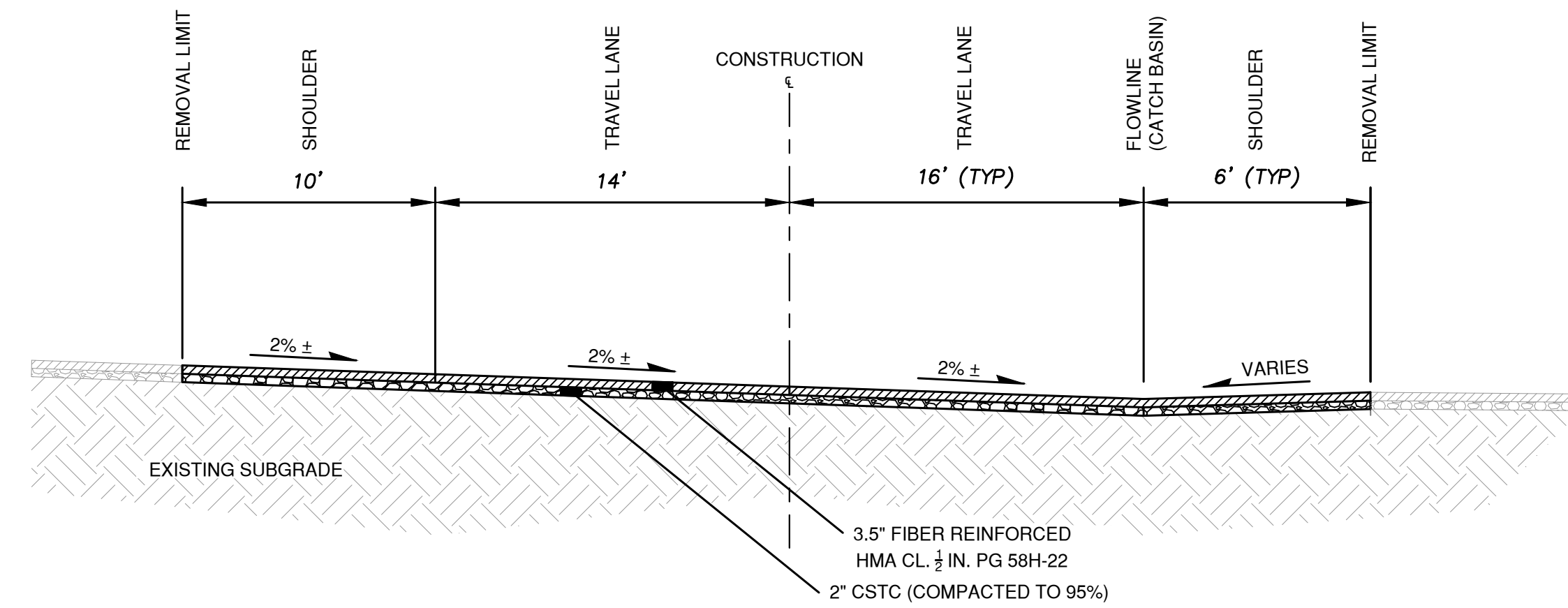

ROADWAY SECTION A (8TH AVE SE)
STA 1+50 TO STA 2+22
N.T.S.

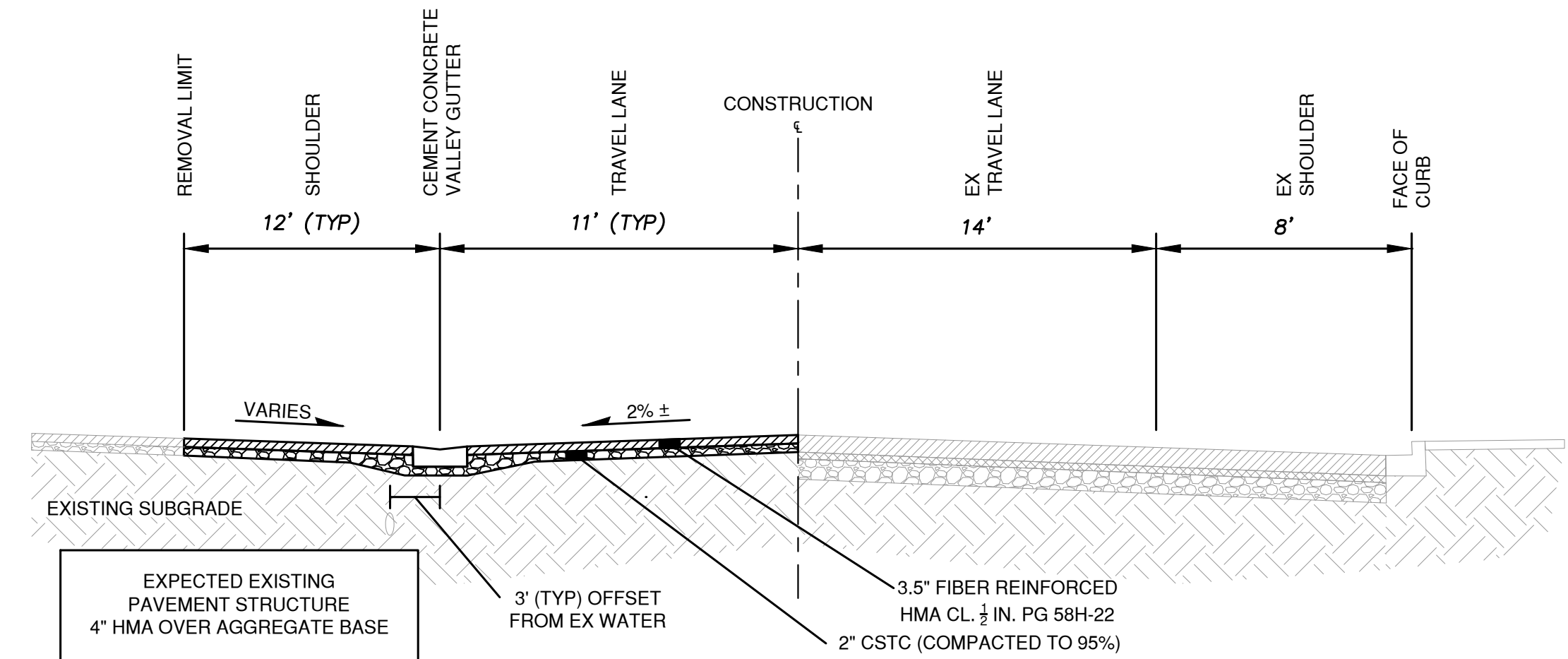

ROADWAY SECTION B (8TH AVE SE)
STA 2+22 TO STA 6+45
N.T.S.

TYPICAL CROSS SECTION NOTES

- EDGE CONDITIONS MAY VARY. CONDITION SHOWN IS TYPICAL FOR EACH SECTION.
- HMA INTERFACES WITH EXISTING HMA/CONCRETE SURFACES SHALL BE SEALED PER WSDOT STANDARD SPEC. SECTION 5-03

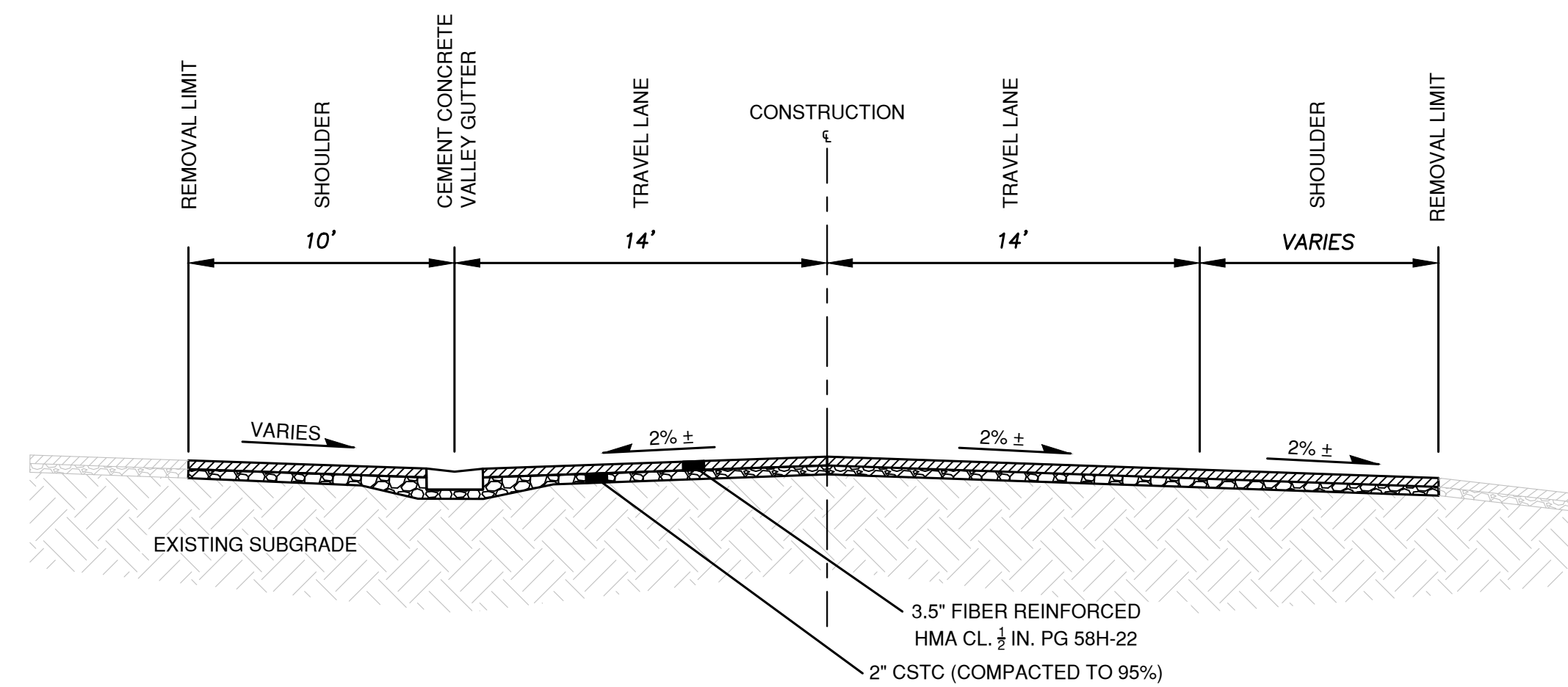

ROADWAY SECTION C (8TH AVE SE)
STA 6+45 TO STA 7+72
N.T.S.



REVISION BLOCK		
NO.	DATE	DESCRIPTION

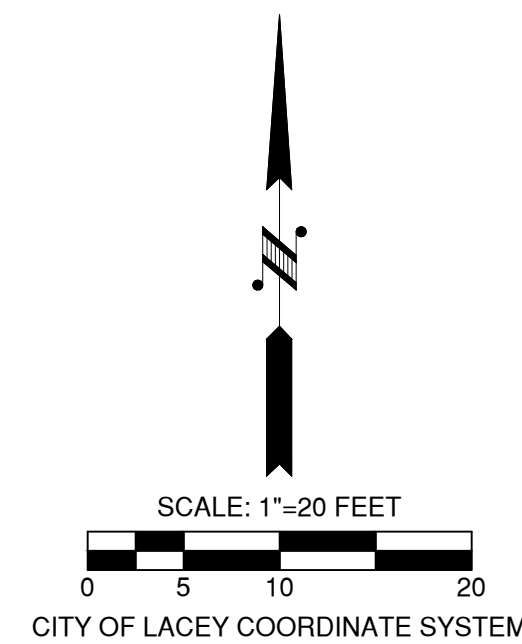

STORM NOTES

POTHOLE PROPOSED STRUCTURE LOCATIONS & CONNECTION POINTS TO IDENTIFY POTENTIAL UTILITY CONFLICTS AND VERIFY ULTIMATE PLACEMENT

STORM LEGEND

- TYPE 1 CATCH BASIN
- CONNECT TO EXISTING STORM STRUCTURE

LEGEND

- TRENCH RESTORATION
HMA FOR PAVEMENT REPAIR
CI. 1/2" PG 58H-22 HMA
- 6" DI STORM SEWER PIPE
- CEMENT CONCRETE
VALLEY GUTTER
SEE SHEET P1 FOR GRADES

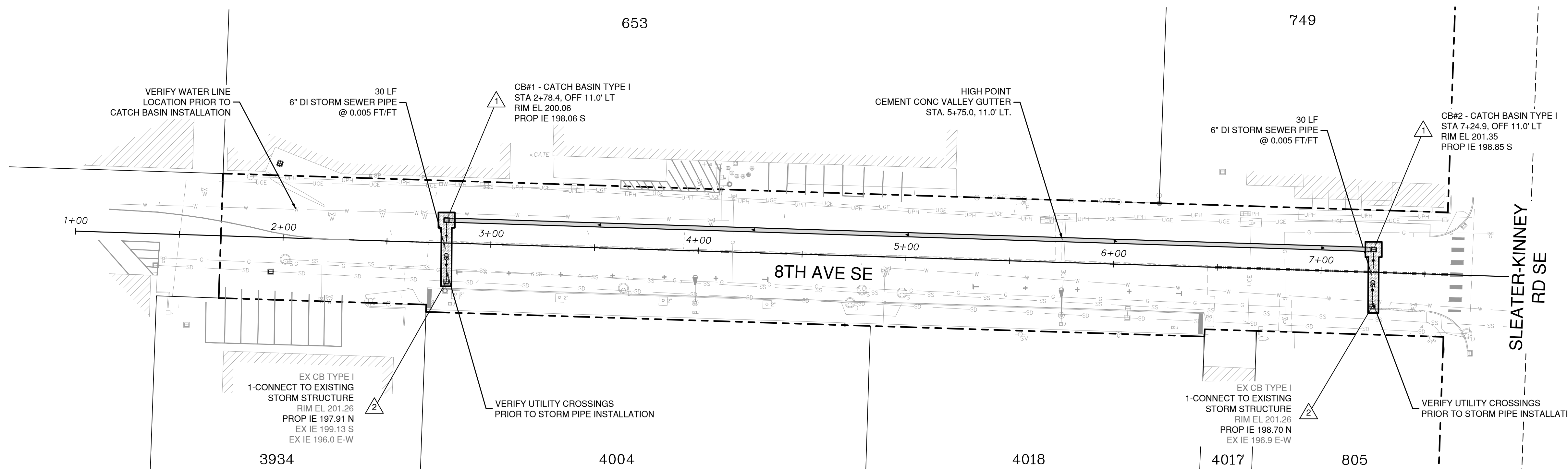

CITY OF LACEY, WASHINGTON
 DEPARTMENT OF PUBLIC WORKS
 420 COLLEGE STREET SE
 LACEY, WA 98503-1238 (360) 491-5600



DESIGNED: BP
 DRAFTED: BP
 CHECKED: MAH
 HORZ. SCALE: 1"=30'
 VERT. SCALE: N/A
 FILE: 8A-PBASE.DWG

**8TH AVE REHABILITATION
 STORM DRAINAGE PLAN**

REVISION BLOCK		
NO.	DATE	DESCRIPTION

SHEET NO.	PAGE NO.
SD1	4
DWG NO.	OF
D-25-01	9

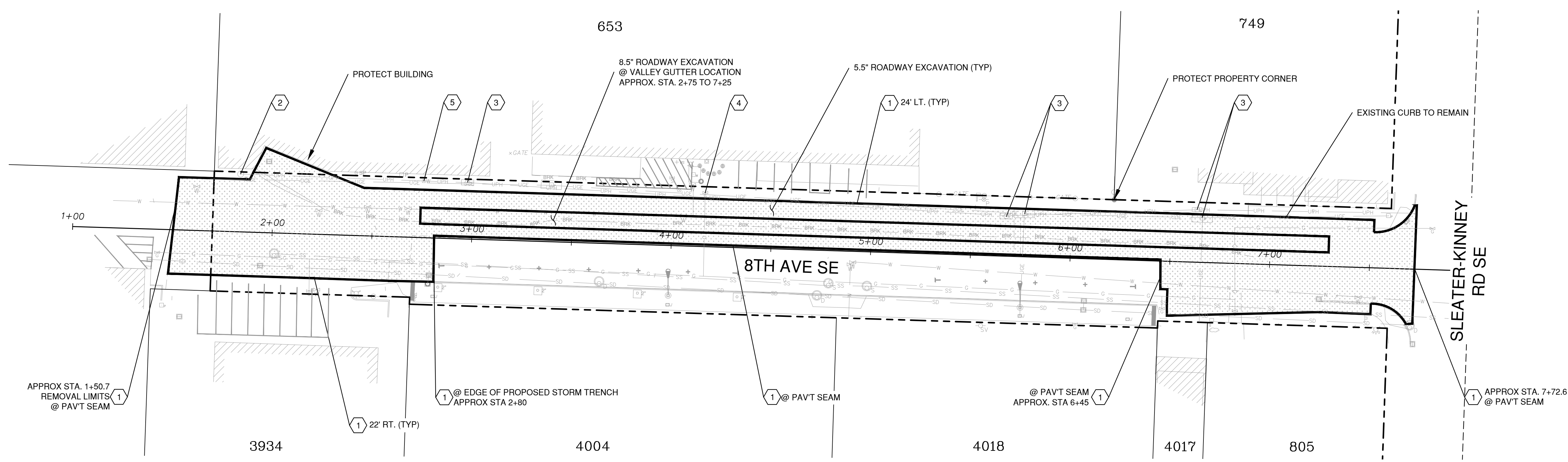
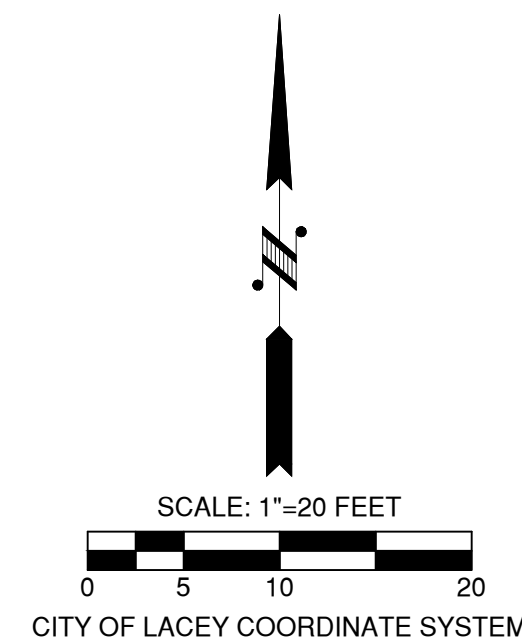

- SITE PREP LEGEND** #
- 1 ROADWAY EXCAVATION
 - 2 PROTECT MANHOLE
 - 3 PROTECT VAULT
 - 4 PROTECT GAS VALVE
 - 5 PROTECT WATER METER

- LEGEND**
- [Hatched Box] ROADWAY EXCAVATION
SEE PLANS FOR DEPTH

CITY OF LACEY, WASHINGTON
 DEPARTMENT OF PUBLIC WORKS
 420 COLLEGE STREET SE
 LACEY, WA 98503-1238 (360) 491-5600



DESIGNED: BP
 DRAFTED: BP
 CHECKED: MAH
 HORZ. SCALE: 1"=30'
 VERT. SCALE: N/A
 FILE: 8A-PBASE.DWG

**8TH AVE REHABILITATION
 SITE PREPARATION PLAN**

REVISION BLOCK		
NO.	DATE	DESCRIPTION

SHEET NO.	PAGE NO.
SP1	5
DWG NO.	OF
D-25-01	9

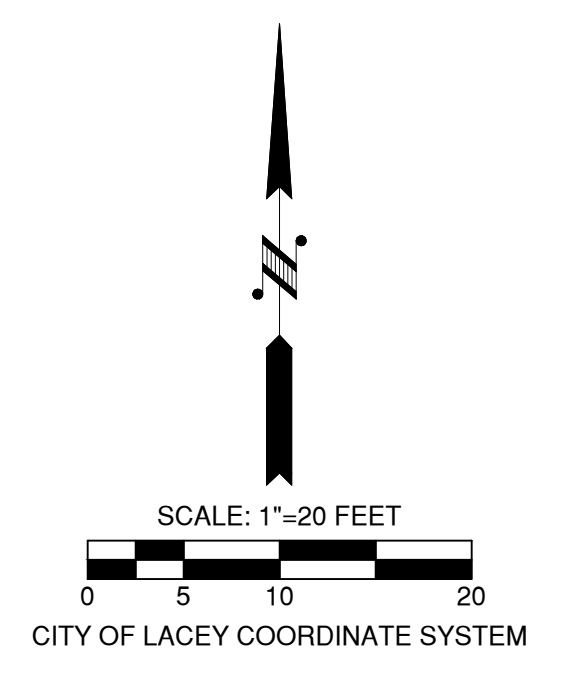
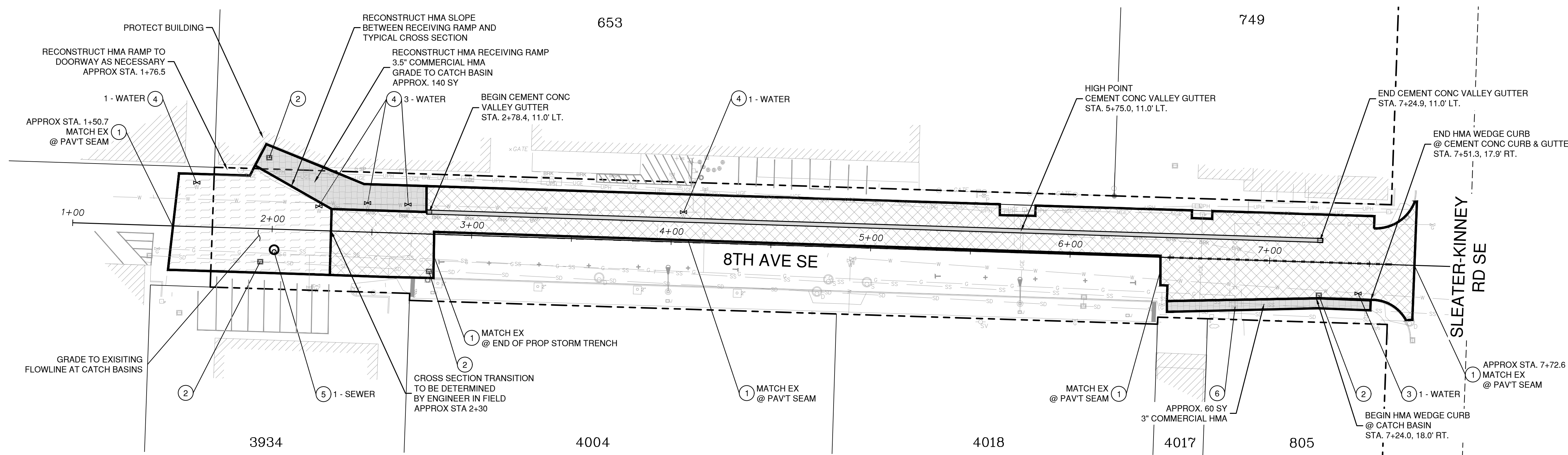

PAVING NOTES
 HMA USED FOR DRIVEWAY APPROACHES AND RECEIVING RAMP TO BE PAID AS COMMERCIAL HMA

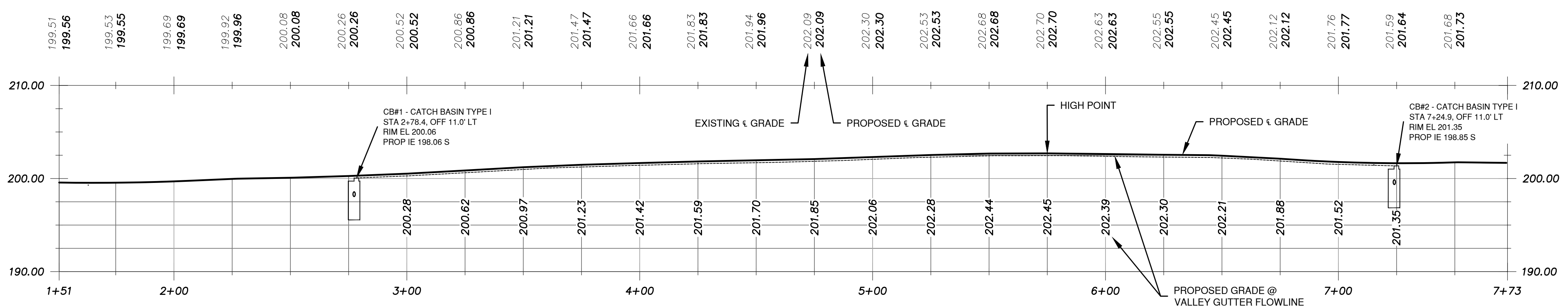

- PAVING LEGEND** (#)
- ① MATCH EXISTING PAVEMENT
 - ② ADJUST CATCH BASIN
 - ③ RAISE VALVE TO FINISH GRADE
 - ④ ADJUST VALVE TO FINISH GRADE
 - ⑤ RAISE MANHOLE TO FINISH GRADE
 - ⑥ RAISE GAS VALVE TO FINISH GRADE

- LEGEND**
- 3.5" FIBER REINFORCED CL. 3/4" PG 58H-22 HMA CROWNED SECTION B & C
 - 3.5" FIBER REINFORCED CL. 3/4" PG 58H-22 HMA NON-CROWNED SECTION A
 - CEMENT CONCRETE VALLEY GUTTER
 - COMMERCIAL HMA FOR APPROACHES

CITY OF LACEY, WASHINGTON
 DEPARTMENT OF PUBLIC WORKS
 420 COLLEGE STREET SE
 LACEY, WA 98503-1238 (360) 491-5600

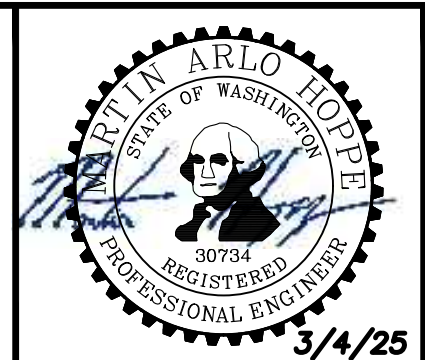

DESIGNED: BP
 DRAFTED: BP
 CHECKED: MAH
 HORZ. SCALE: 1"=30'
 VERT. SCALE: 1"=5'
 FILE: 8A-PBASE.DWG

**8TH AVE REHABILITATION
 PAVING PLAN**

REVISION BLOCK		
NO.	DATE	DESCRIPTION

SHEET NO.	P1	PAGE NO.	6
DWG NO.	D-25-01	OF	9

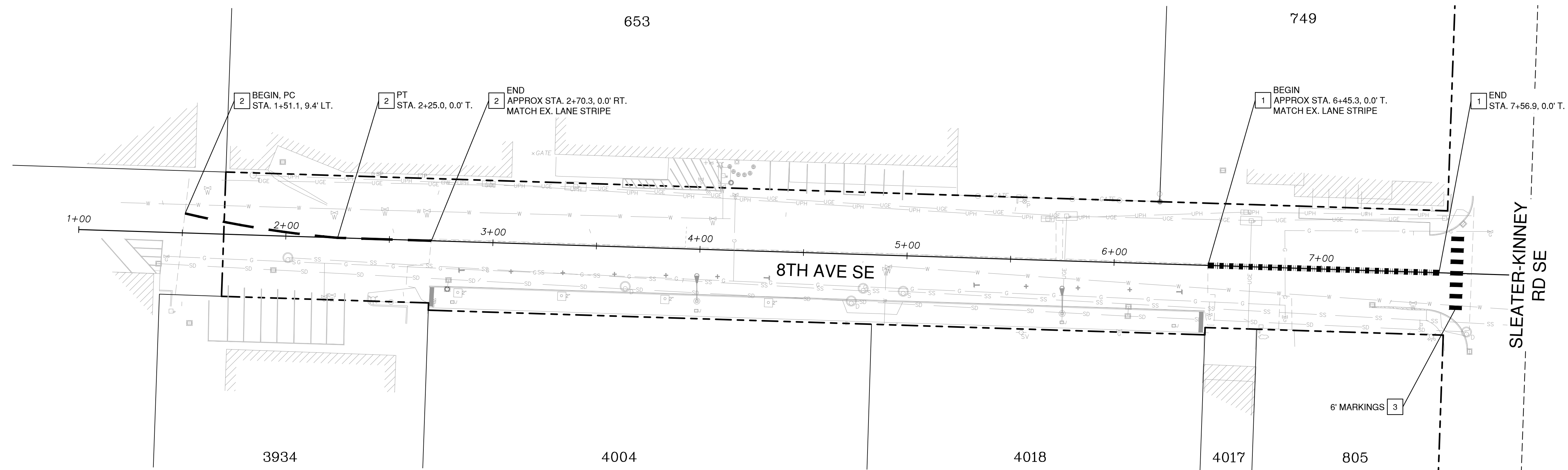
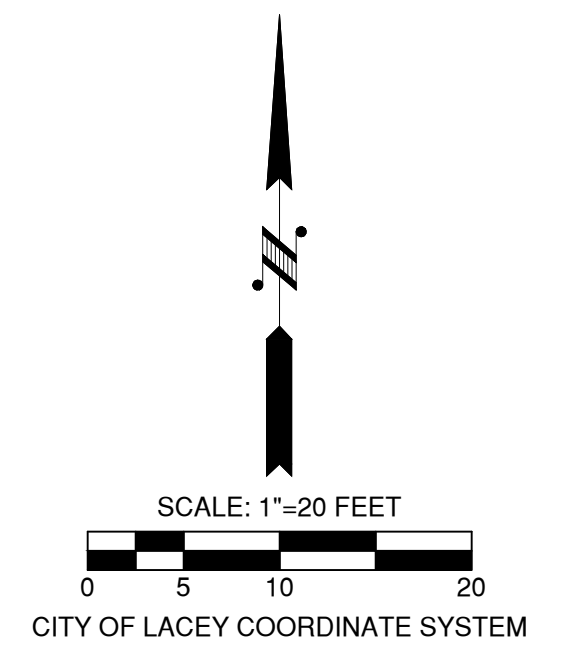

CHANNELIZATION LEGEND #

1	DOUBLE YELLOW CENTER STRIPE
2	YELLOW LANE STRIPE
3	PLASTIC CROSSWALK AS SHOWN

CITY OF LACEY, WASHINGTON
 DEPARTMENT OF PUBLIC WORKS
 420 COLLEGE STREET SE
 LACEY, WA 98503-1238 (360) 491-5600



DESIGNED: BP
 DRAFTED: BP
 CHECKED: MAH
 HORZ. SCALE: 1"=30'
 VERT. SCALE: N/A
 FILE: 8A-PBASE.DWG

**8TH AVE REHABILITATION
 CHANNELIZATION PLAN**

REVISION BLOCK		
NO.	DATE	DESCRIPTION

SHEET NO.	PAGE NO.
CH1	7
DWG NO.	OF
D-25-01	9

PIPE BEDDING SPECIFICATION

SIEVE SIZE	PERCENT PASSING
3/4" SQUARE	100
3/8" SQUARE	70-100
U.S. NO.4	55-100
U.S. NO. 10	35-95
U.S. NO. 20	20-80
U.S. NO. 40	10-55
U.S. NO. 100	0-10
U.S. NO. 200	0-03

- GENERAL NOTES:**
- ALL MATERIALS EXCEPT H.M.A. SHALL BE COMPACTED IN 6-INCH MAXIMUM LIFTS TO 95% DENSITY AS DETERMINED BY ASTM D1557.
 - ALL MATERIALS, WORKMANSHIP, AND INSTALLATION SHALL BE IN CONFORMANCE WITH THE WSDOT STANDARD SPECIFICATIONS FOR ROAD, BRIDGE AND MUNICIPAL CONSTRUCTION AS AMENDED BY CITY OF LACEY STANDARDS.
 - KEEP TRENCH BOTTOM COMPACTED WITH UNIFORM GRADE. NO TEMPORARY SUPPORTS, I.E. BLOCKS, WILL BE ALLOWED TO SUPPORT PIPE. TRENCH BOTTOM SHALL BE TO GRADE PRIOR TO PIPE INSTALLATION.
 - SAW CUT PAVEMENT TO MAX. TRENCH WIDTH. BACKFILL AND PAVE TO TOP OF EXISTING PAVEMENT FOR TRENCH WIDTH. ALLOW 24 HOURS MINIMUM FOR TRENCH PATCH TO CURE. GRIND AND PAVE FINAL PATCH AS SHOWN.
 - DEVIATION FROM COMPACTION STANDARDS MAY BE APPROVED BY THE DIRECTOR, OR DESIGNEE, WHERE RECOMMENDED BY THE LICENSED PROFESSIONAL ENGINEER FOR PLANNED OR EXISTING INFILTRATION FACILITIES.
 - EXISTING SURFACES PAVED WITH PERMEABLE MATERIALS SHALL BE REPLACED IN-KIND WHERE FEASIBLE IN CONFORMANCE WITH 4B.180 TRENCH BACKFILL AND RESTORATION.

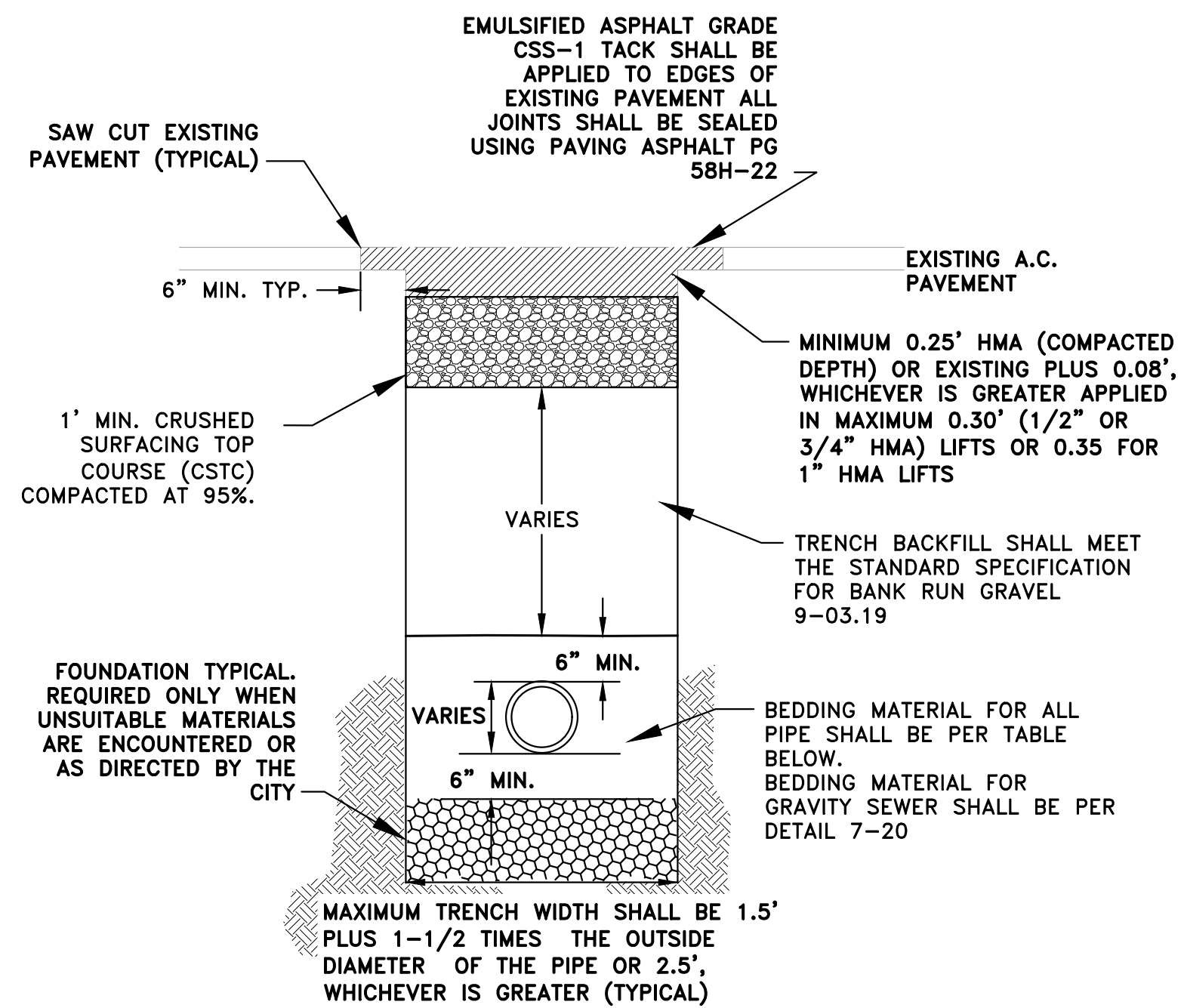

RESIDENTIAL TRENCH RESTORATION

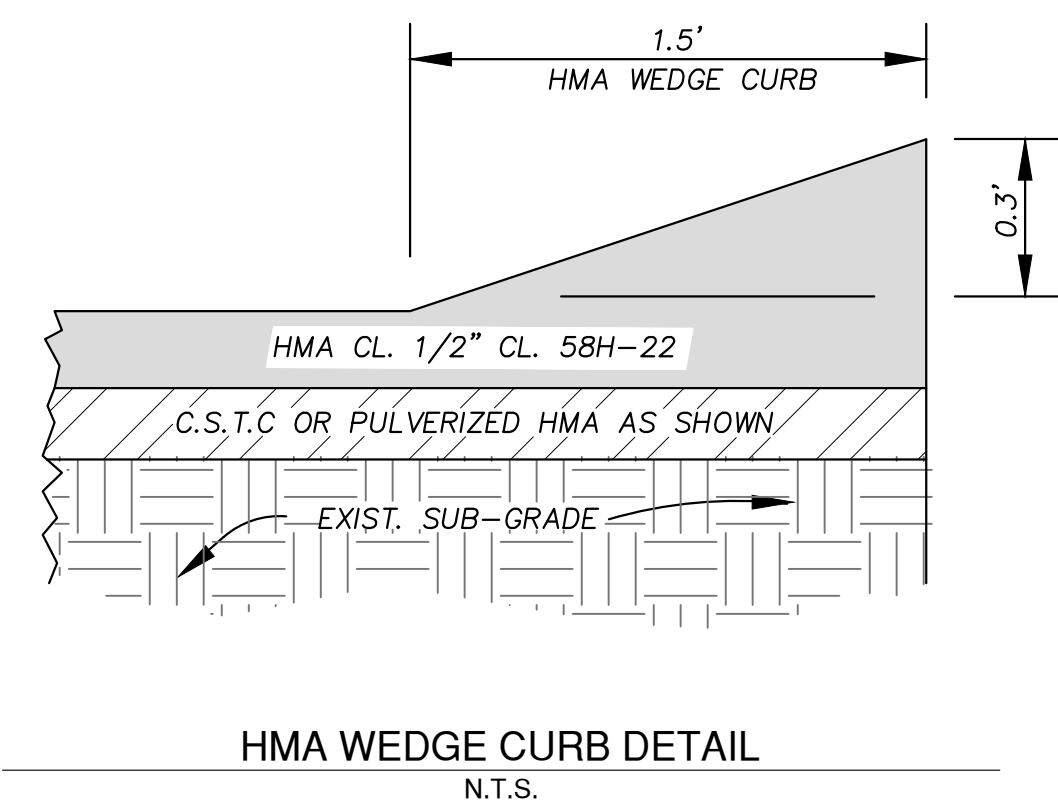

HMA WEDGE CURB DETAIL
N.T.S.

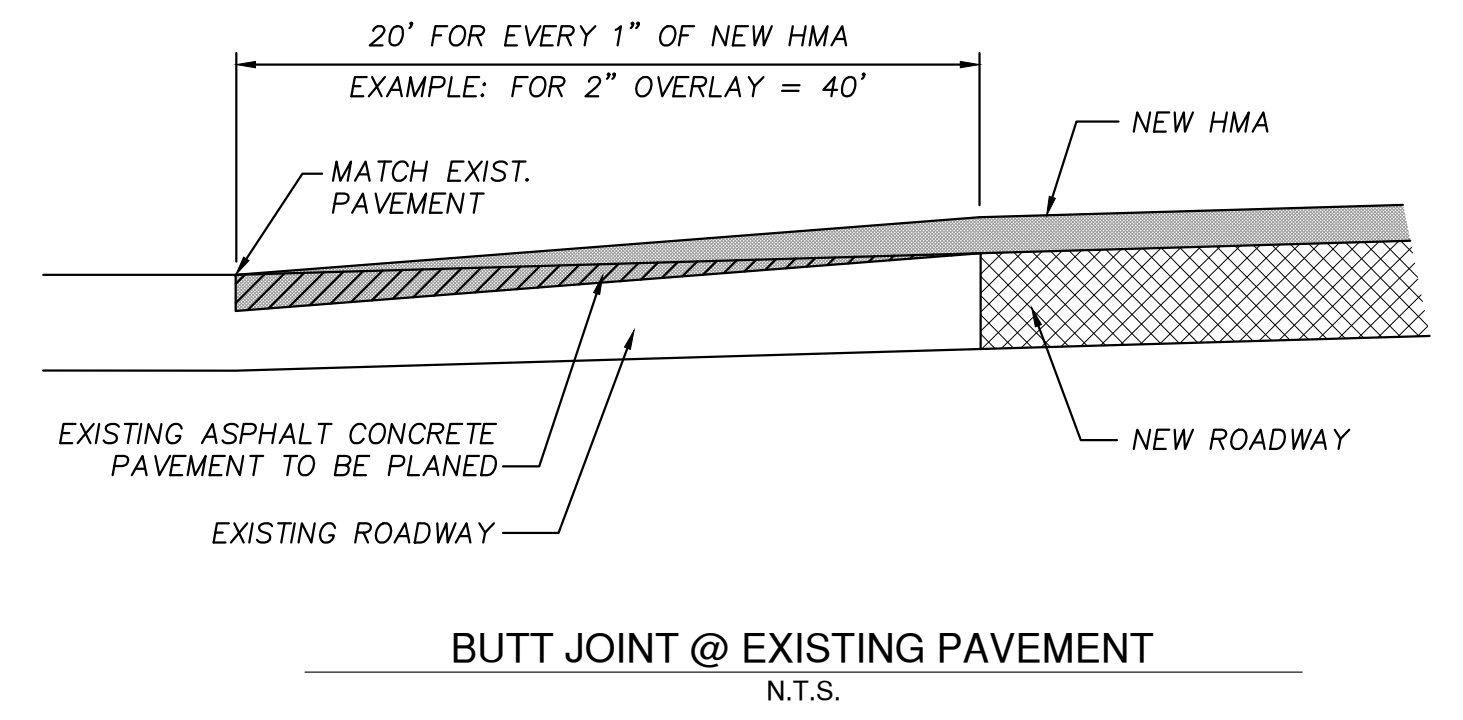

BUTT JOINT @ EXISTING PAVEMENT
N.T.S.

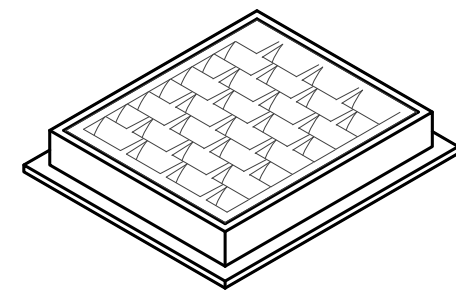

FRAME AND VANED GRATE

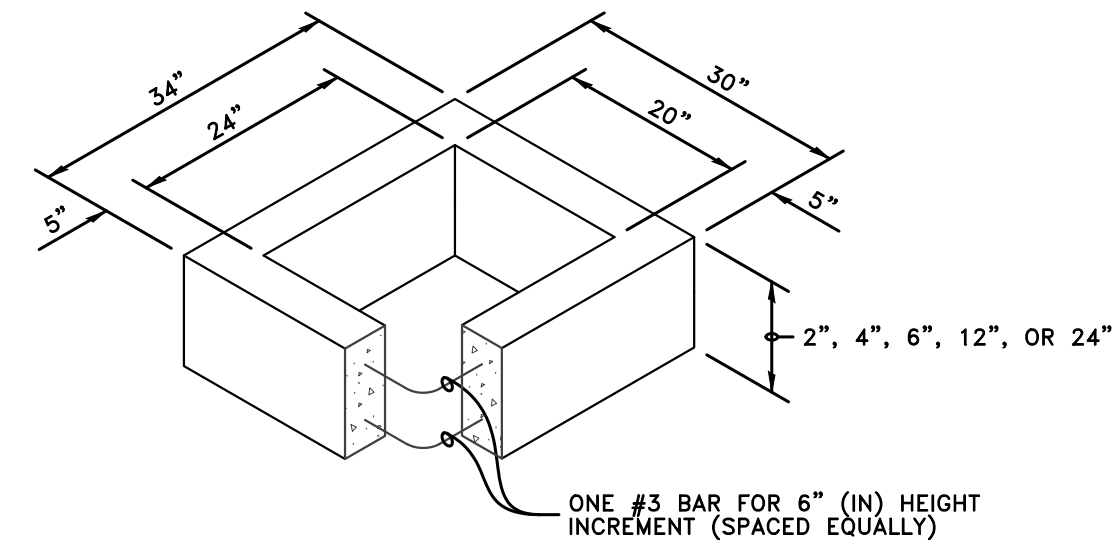

RECTANGULAR ADJUSTMENT SECTION

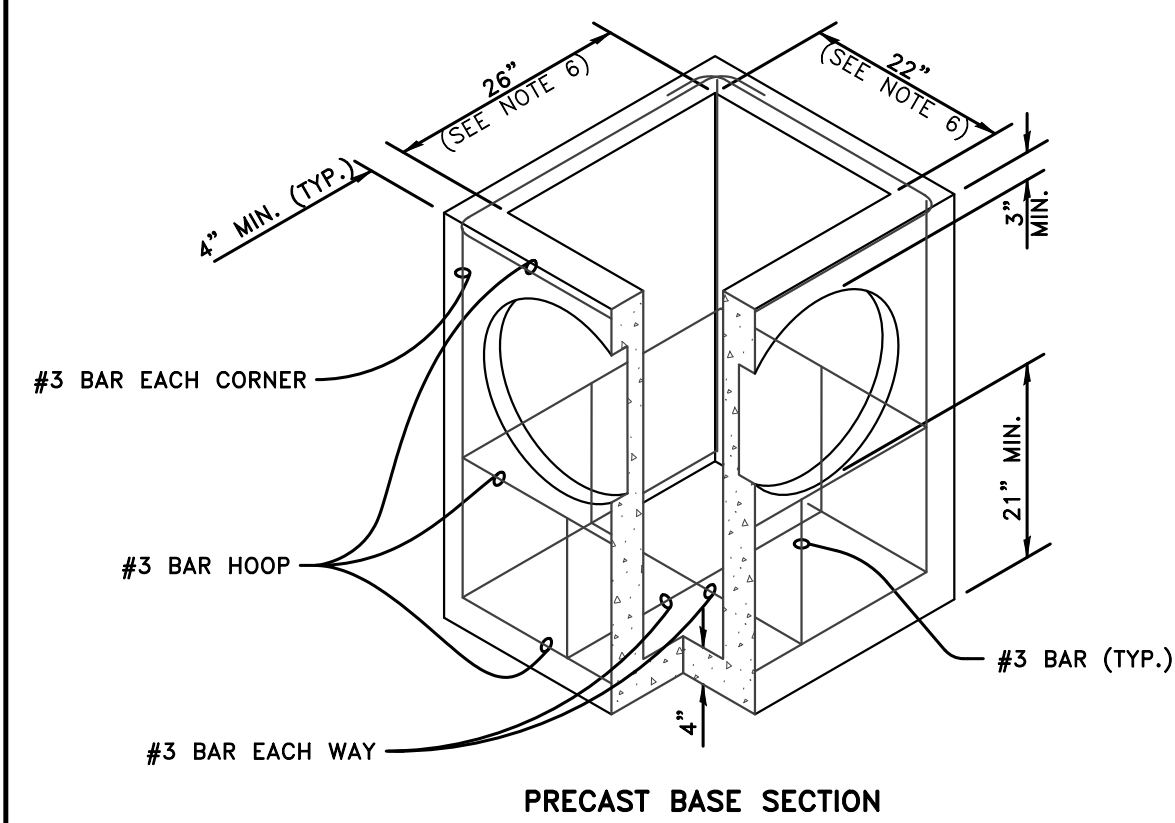

PRECAST BASE SECTION

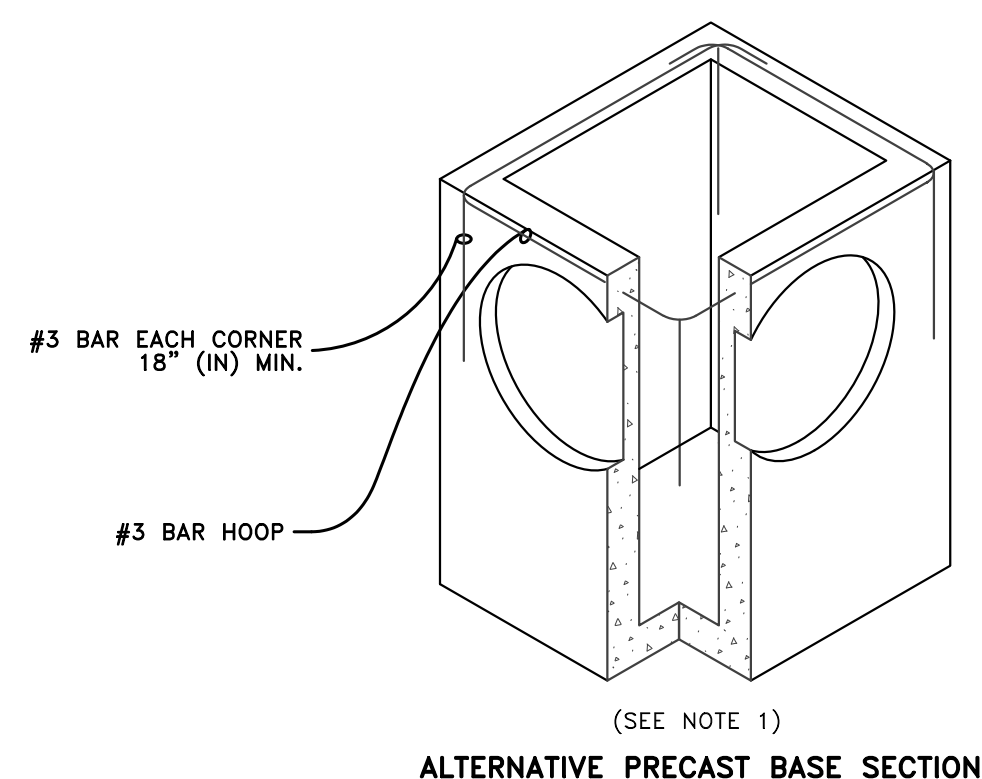

ALTERNATIVE PRECAST BASE SECTION

CATCH BASIN TYPE 1

- NOTES**
- As acceptable alternatives to the rebar shown in the PRECAST BASE SECTION, fibers (placed according to the Standard Specifications), or wire mesh having a minimum area of 0.12 square inches per foot shall be used with the minimum required rebar shown in the ALTERNATIVE PRECAST BASE SECTION. Wire mesh shall not be placed in the knockouts.
 - The knockout diameter shall not be greater than 20" (in). Knockouts shall have a wall thickness of 2" (in) minimum to 2.5" (in) maximum. Provide a 1.5" (in) minimum gap between the knockout wall and the outside of the pipe. After the pipe is installed, fill the gap with joint mortar in accordance with Standard Specification Section 9-04.3.
 - The maximum depth from the finished grade to the lowest pipe invert shall be 5' (ft).
 - The frame and grate may be installed with the flange down, or integrally cast into the adjustment section with flange up.
 - The Precast Base Section may have a rounded floor, and the walls may be sloped at a rate of 1 : 24 or steeper.
 - The opening shall be measured at the top of the Precast Base Section.
- All pickup holes shall be grouted full after the basin has been placed.

PIPE ALLOWANCES

PIPE MATERIAL	MAXIMUM INSIDE DIAMETER (INCHES)
REINFORCED OR PLAIN CONCRETE	12"
ALL METAL PIPE	15"
CPSSP* (STD. SPEC. SECT. 9-05.20)	12"
SOLID WALL PVC (STD. SPEC. SECT. 9-05.12(1))	15"
PROFILE WALL PVC (STD. SPEC. SECT. 9-05.12(2))	15"

* CORRUGATED POLYETHYLENE STORM SEWER PIPE

RAISE VALVE BOX TO GRADE

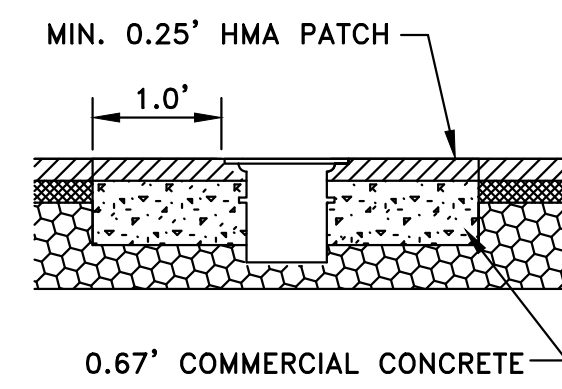

RAISE MANHOLE TO GRADE

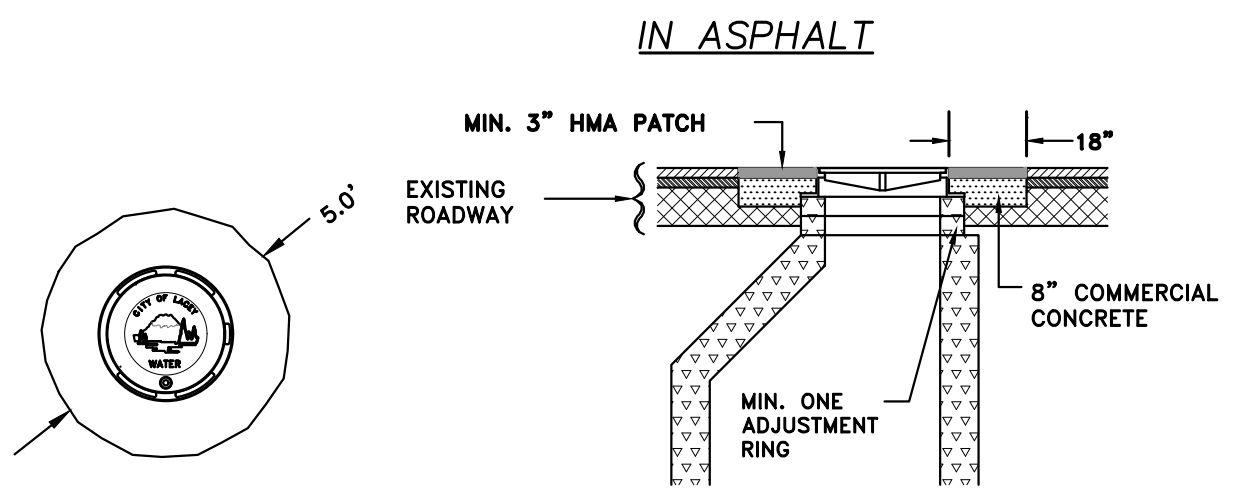

- GENERAL NOTES:**
- ON MANHOLES OUTSIDE OF THE ASPHALT ADD REINFORCING STEEL AS SHOWN ABOVE, DEFORMED BAR TO MEET ASTM A615 GRADE 60 Fy=60,000 P.S.I.
 - ALL WATER MANHOLE LIDS SHALL BE EAST JORDAN IRON WORKS OR OLYMPIC FOUNDRY WSDOT STYLE #MH-41 CITY OF LACEY LOGO LIDS.
 - ALL LIDS SHALL BE DUCTILE IRON AND MANUFACTURED IN THE USA.

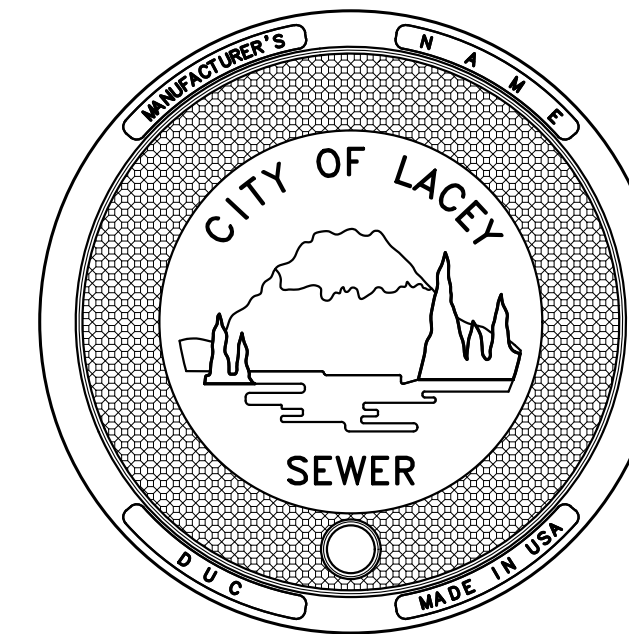
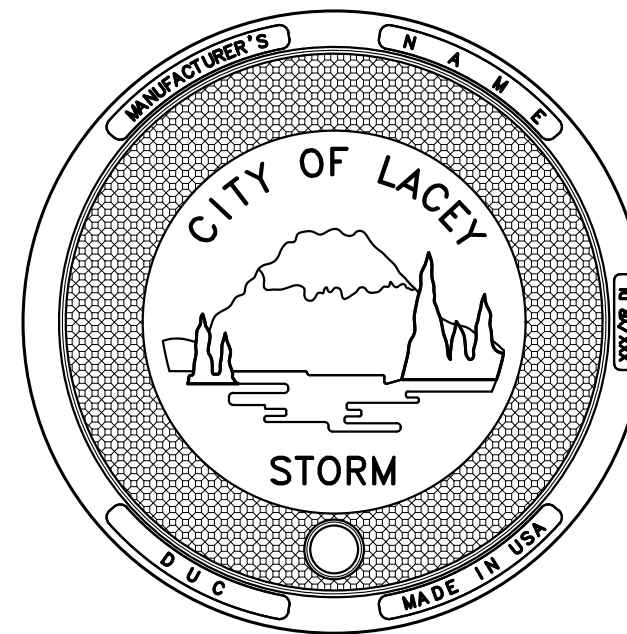
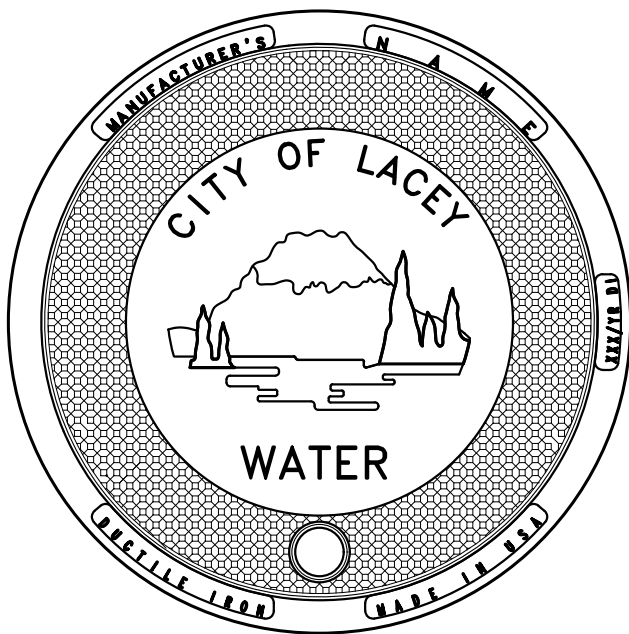

IRON ADJUSTMENTS AND MANHOLE LOGO LIDS
N.T.S.

CITY OF LACEY, WASHINGTON
DEPARTMENT OF PUBLIC WORKS
420 COLLEGE STREET SE
LACEY, WA 98503-1238 (360) 491-5600



DESIGNED: BP
DRAFTED: BP
CHECKED: MAH
HORZ. SCALE: N/A
VERT. SCALE: N/A
FILE: DTCON.DWG

**8TH AVE REHABILITATION
CONSTRUCTION DETAILS 1**

REVISION BLOCK			PAGE NO.	SHEET NO.
NO.	DATE	DESCRIPTION		
			DT1	8
			DWG NO.	OF
			D-25-01	9

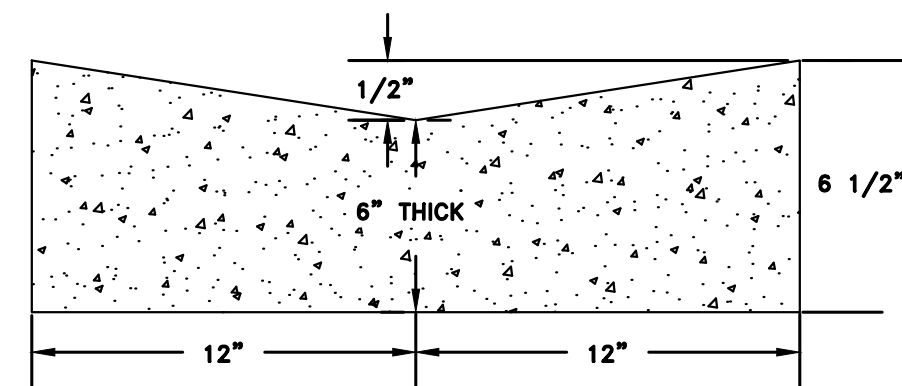

STANDARD VALLEY GUTTER

- GENERAL NOTES:
 1. COMMERCIAL CONCRETE.
 2. EXPANSION JOINT 3/8" THICK, FULL DEPTH, SPACED 15' AND SCORE EVERY 5'.

CEMENT CONCRETE VALLEY GUTTER

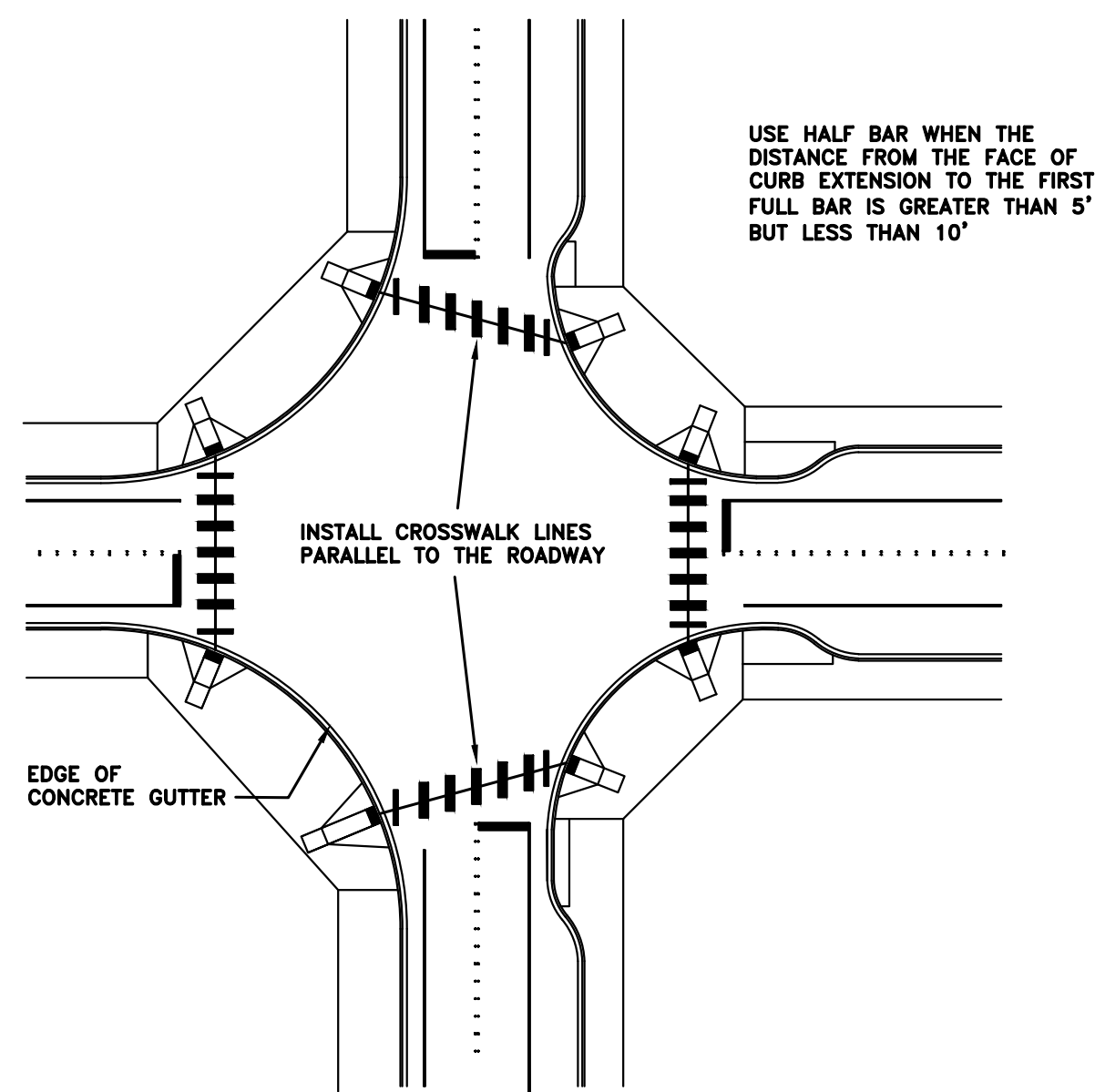
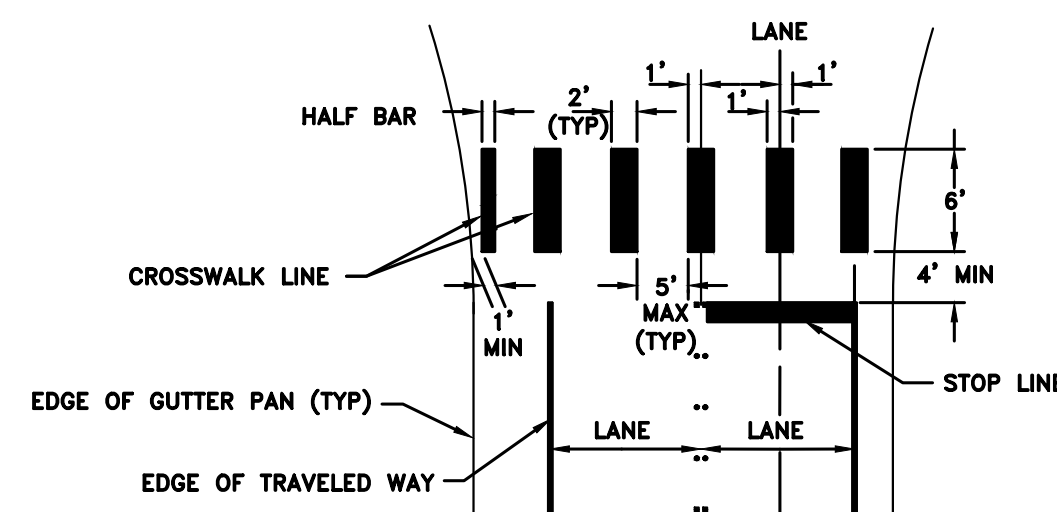

CROSSWALK DETAIL

PAVEMENT MARKING DETAILS

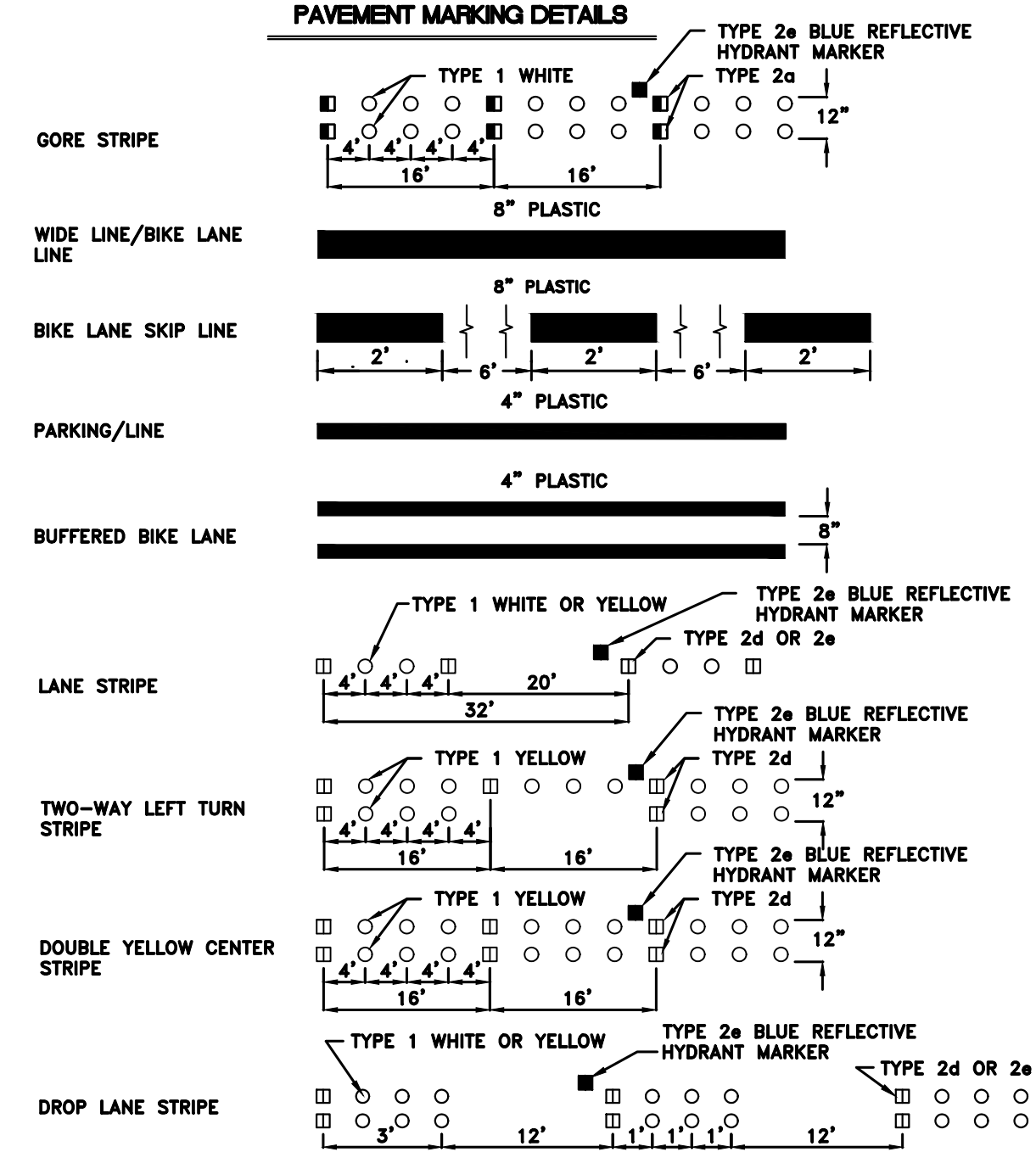

LANE MARKERS

- TYPE 1 LANE MARKERS, WHITE OR YELLOW
- TYPE 2a REFLECTIVE LANE MARKER, WHITE AND RED
- TYPE 2d REFLECTIVE LANE MARKER, YELLOW AND YELLOW
- TYPE 2a REFLECTIVE LANE MARKER, WHITE ONE SIDE ONLY
- TYPE 2a TWO WAY BLUE REFLECTIVE HYDRANT MARKER INSTALLED 8" ON CENTER FROM THE CENTER OF THE ROADWAY.

STRIPING DETAIL

REVISION BLOCK		
NO.	DATE	DESCRIPTION